

Plates, shed method
ACM (Aluminium Composite Material)

System ATS - 119.1

Product changes in the sense of a technical progress are reserved. All advice recommendation and information is given to the best of our knowledge but without any obligation on our part. 03/2010

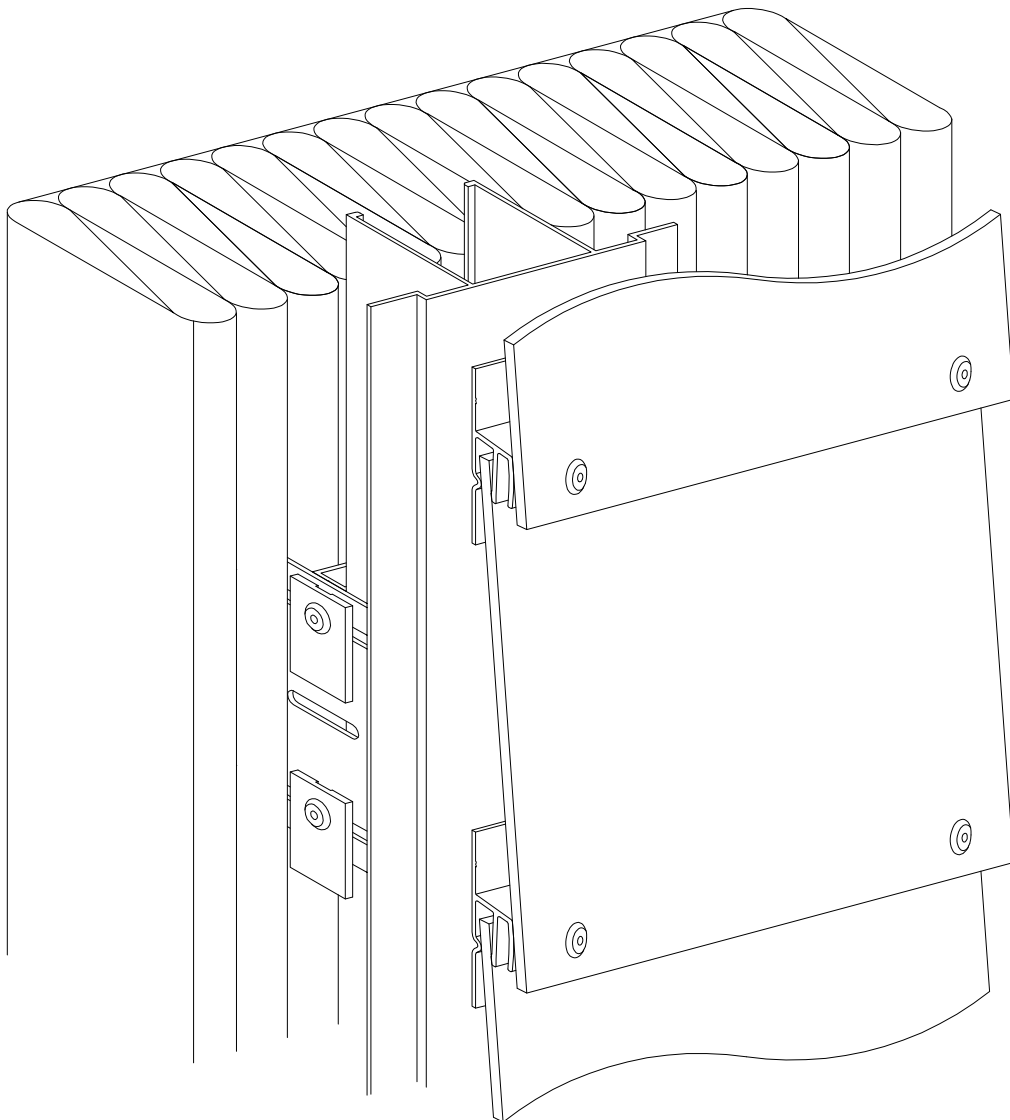

Plates, shed method
ACM (Aluminium Composite Material)

System ATS - 119.1
Installation Scheme

Product changes in the sense of a technical progress are reserved. All advice recommendation and information is given to the best of our knowledge but without any obligation on our part. 03/2010

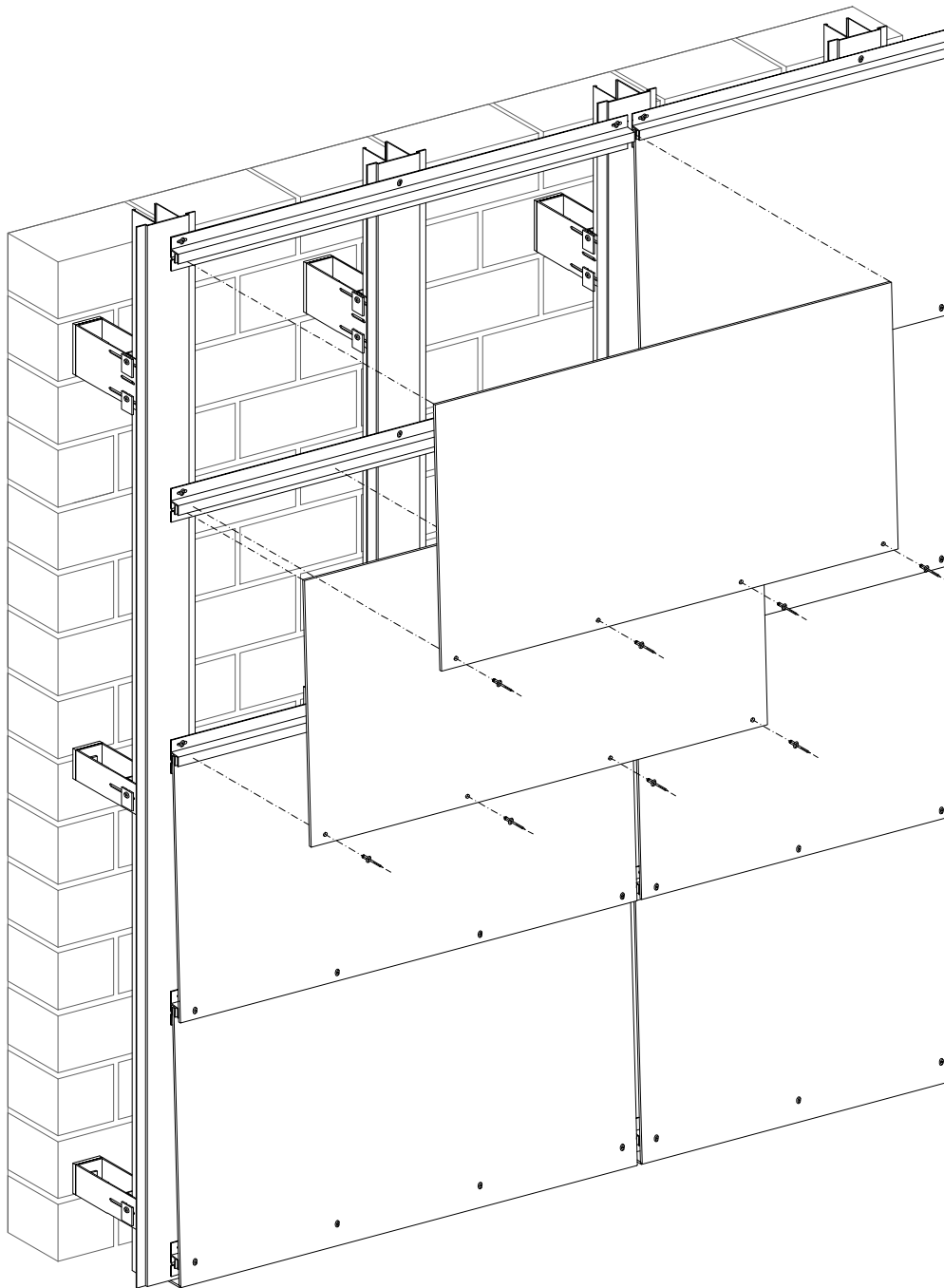

Plates, shed method
 ACM (Aluminium Composite Material)

System ATS - 119.1
 Assembly plan

Product changes in the sense of a technical progress are reserved. All advice recommendation and information is given to the best of our knowledge but without any obligation on our part. 03/2010

