



Safety Sign Checklist

Guidance Checklist

This checklist has been devised to help provide guidance and information relating to a safety sign audit of a building. From entrance to exit, we look at the key questions that should be asked and highlight critical health and safety signs that will aid compliance with the latest safety legislation.

The Health and Safety (Safety Signs and Signals) Regulations 1996 and ISO 7010 were developed to standardise safety signs throughout member states of the European Union and maximise familiarity with their meanings. Wherever appropriate, all our safety signs are manufactured in compliance with these regulations.

Employers have a duty to display safety signs if there is a significant risk that can't be avoided or controlled in any other way, such as through safe systems of work or engineering controls.

This applies to: all places / activities where people are employed and employers must, where necessary:

1. Use of road traffic signs in workplaces to regulate road traffic.
2. Maintain or replace the safety signs they provide.
3. Explain unfamiliar signs to employees and tell them what they need to do when they see safety signs.

Table of Contents

| | |
|-----------------------------------|----------|
| Introduction and Contents | 1 |
| External/Building Entrance | 2 |
| Assembly Points | 3 |
| Fire Doors | 3 |
| Smoking Restrictions | 3 |
| Roof Access | 4 |
| Security | 4 |
| Car Parks | 4 |
| Speed Restrictions | 4 |
| Reception Area | 5 |
| Company Info | 6 |
| Extinguisher ID | 6 |
| Toilet Signs | 7 |
| Fire Alarm | 7 |
| Access | 8 |
| Braille | 8 |
| Emergency Escape | 8 |

| | |
|-----------------------------------|-----------|
| Corridors & Stairwells | 9 |
| Fire Equipment | 10 |
| Fire Extinguisher IDs | 10 |
| Stairwell Signs | 10 |
| Emergency Escape | 11 |
| Fire Doors | 11 |
| Smoking Regulations | 11 |
| Offices | 12 |
| Prohibition Signs | 13 |
| Janitorial Signs | 13 |
| First Aid | 13 |
| Emergency Escape | 14 |
| Suspending Frames | 14 |
| Fire Alarm | 14 |
| General Information | 14 |
| Factories & Warehouses | 15 |
| Floor Marking | 16 |
| Labelling | 16 |
| Mirrors | 16 |
| Emergency Escape | 17 |
| Fire Equipment | 17 |
| Pipeline Identification | 17 |
| Impact Protection | 18 |
| Good to Go Safety | 18 |



Please do not hesitate to contact us if you have any questions.

Signs to Consider for External/Building Entrances

Assembly Points

Assembly point signs are essential for identifying areas of safety where persons should assemble in the event of an emergency. The general rule of thumb is it should be positioned a distance equal to twice the height of the building.

For more info P19 of the catalogue



Fire Exit Doors

Exit doors of a building present problems because this type of door requires a higher degree of security to prevent access from outside, while still having to be opened easily from within. It is important that this route is clear of any obstacles.

For more info P12 of the catalogue



Parking

For more info P106 of the catalogue



Security

If CCTV is in use, the operator must let people know they are using CCTV. Signs are the most usual way of doing this and must be clearly visible and readable, with details of the organisation operating the system provided.

For more info P68 of the catalogue



Speed Restrictions

Speed limits may be variable around your business. Indicate speed limits with Safety Signs and enforce the slowing of traffic with speed bumps. Perfect for use in car parks, private roads, sites and industrial estates.

For more info P107&112 of the catalogue



Non/Smoking Areas

For more info P28 of the catalogue



Roof Access

If fragile surfaces are present on a non-domestic building they must be identified. A 600x200mm sign can be seen from 25 metres away in good light, making it ideal for this type of application.

For more info P73 of the catalogue



Bespoke

The custom made sign services that we offer, allow you to create a wide variety of signs that will fit even the most creative needs. We have several processes which we use on a regular basis, dependent upon volume, graphical content or even just personal taste.

For more info P140 of the catalogue



External/Building Entrance

Signs are not just a concern for inside the building, alongside the obvious company name sign (contact us for custom solutions), there are several areas that should be addressed.





Assembly Points



1 2142 **H L**
2 2142 **H L**
6 2142 **H**



1 2143 **H L**
2 2143 **H L**
6 2143 **H**

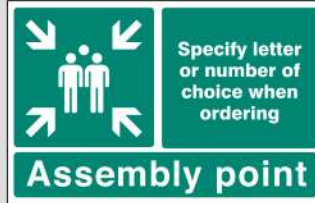

5 2111 600mm x 400mm Rigid PVC



1 2055 **H Q**
2 2055 **H Q**
6 2055 **H Q**



5 2158 150 x 50mm Rigid PVC
5 2159 450 150mm Rigid PVC

Fire Exit Doors



1 1605 **F N U**
2 1605 **F N U**



1 1606 **F N B**
2 1606 **F N B**
7 1606 **F**



1 1613 **F N**
2 1613 **F N**

Q Are external fire doors clearly marked and free from obstacles?



1 2061 **G L**
2 2061 **G L**



1 2062 **G L**
2 2062 **G L**



Q

1. Is the designated smoking area clearly defined?
2. Are people smoking outside of the entrance rather than the designated smoking area? Look for cigarette ends.

If the answer to any of these questions is NO, Please find the sign/s you require to the right.

Smoking Restrictions



1 3259 **G**
2 3259 **G**



1 3023 **G M**
2 3023 **G**



1 3002 **G M E K P**
2 3002 **G M E K**



5 3043 A5 Rigid



1 3247 **E K H**
2 3247 **E K H**



NOT WHAT YOU'RE LOOKING FOR? - CONTACT US!

Despite the thousands of standard safety sign messages available in our catalogue we appreciate that there will always be occasions when a customer needs something customised – whether it's adding a company logo, imagery or simply creating a unique 'one-off' sign.

Roof Access



1 4261 G M E K P
2 4261 G M E K P



1 6232 G P
2 6232 G



1 4299 G M
2 4299 G M



1 6214 G M P
2 6214 G M



1 6276 Q
2 6276 Q

Q

1. Can the roof and skylights hold the weight of an average human?

2. Are fragile roof signs clearly visible (check for fading in sunlight)

If the answer to any of these questions is NO, Please find the sign/s you require to the left.



Q

1. If CCTV is in use, are signs clearly visible and details of the operator displayed?

If the answer to any of these questions is NO, Please find the sign/s you require to the left.

Security



1 6433 Q



1 1739 H K
2 1739 H



1 1713 H K
2 1713 H



1 1731 H K



1 1719 H
2 1719 H



1 6215 G M P



1 1720 G M
2 1720 G
7 1720 G M

Car Parks & Speed Restrictions



1 7599 K Q



5 8528
600x450mm Sign



1 7521 Q
6 7521 Q



1 7501 N
6 7501 N



1 7502 N
6 7502 N



1 7568 K Q



1 7595 K

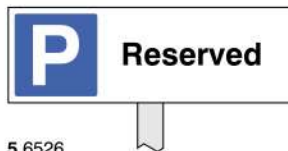

5 6526
450x150mm Sign
800mm pole



5 6529
450x150mm Sign
800mm pole

Q

1. Are parking bays clearly marked?
2. Is parking available near to the entrance for disabled visitors?
3. Are any speed restrictions within the grounds clearly marked?
4. Do visitors know how to get to the reception/goods in/car park etc?
5. Are there any areas outside the building that are strictly no parking?

NO? Please find the sign/s you require above.



Reception Areas

In most buildings the entrance will lead staff and visitors into the reception area. This provides an excellent opportunity to display key safety information for maximum awareness. As the 'introduction' to your company it is also an opportunity to use deluxe and/or customised signs to enhance a professional profile.

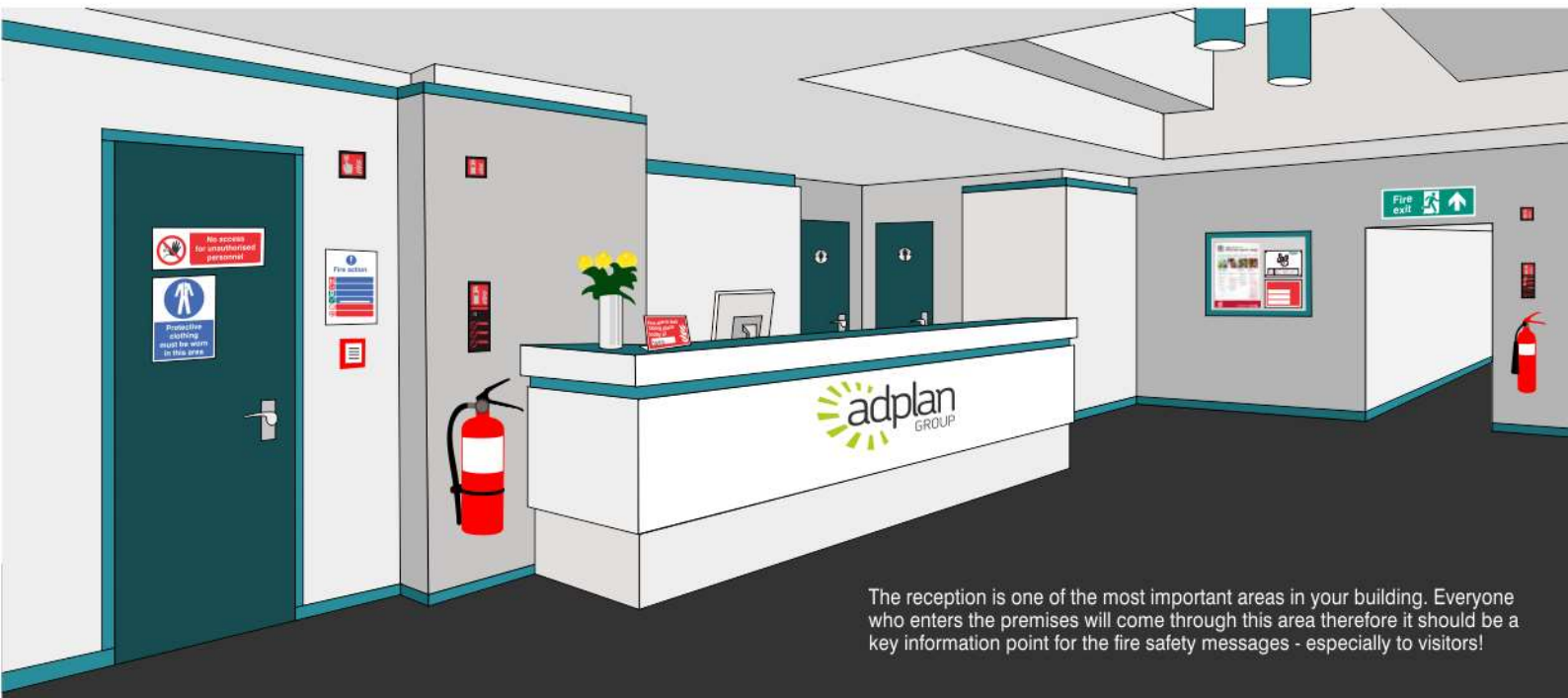

The reception is one of the most important areas in your building. Everyone who enters the premises will come through this area therefore it should be a key information point for the fire safety messages - especially to visitors!

Signs to Consider for Reception Areas

Company Info

The reception area can be a useful place to display key safety information as it is often the main entry point for staff and visitors, providing an excellent opportunity to advise of important safety messages.

For more info P93 of the catalogue



Toilet Signs

General information signs will help identify various facilities within a building and display important notices and requests to staff and visitors. Ensure toilets & restrooms are clearly marked and visible from all areas of the reception.

For more info P76 of the catalogue



Fire Alarm

The display of appropriate notices, in clear and precise format is recommended to support good fire safety management and formal training. Fire Action Notices provide important information to staff and visitors in the event of a fire.

For more info P6 of the catalogue



Extinguisher ID

Under the Regulatory Reform (Fire Safety) Order 2005, any non-automatic fire fighting equipment should be identified with an appropriate sign. Training and instruction on how to use equipment is also required under PUWER.

For more info P4 of the catalogue



Emergency Escape

It must not be assumed that everyone will know all safe routes through a building. Emergency escape signs are provided to guide people from wherever they are within a building to the place of ultimate safety (the assembly area).

For more info P14 of the catalogue



Access

There are many situations where you may need to use signs to prevent access - because a door is alarmed, of dangers beyond or to prevent the general public entering a private staff only area.

For more info P33 of the catalogue



Braille

Meet obligations under the DDA & Equality Act 2010 by providing braille & tactile signs in your building.

For more info P73 of the catalogue



Bespoke

The custom made sign services that we offer, allow you to create a wide variety of signs that will fit even the most creative needs. We have several processes which we use on a regular basis, dependent upon volume, graphical content or even just personal taste.

For more info P140 of the catalogue



Company Information

Reception

5 9061



5 6490



5 8112



5 6071 - Visitors Book



1 5461 2 5461

Q

1. As a visitor, is it clear that they have to sign in?
2. If the building is open to the public, is there a sign stating the company's policy on assisting the disabled?
3. Does the building display at least one updated Health & Safety Law Poster?

If the answer to any of these questions is NO, Please find the sign/s you require to the left.



Snap Frames P96

Extinguisher ID's

With only an estimated 2-4% of UK employees actually receiving hands-on fire extinguisher training, the need for fire ID signs next to extinguishers could be considered of critical importance. After all, if extinguishers aren't used correctly, they can become a hazard themselves. For example, untrained operators of a CO2 extinguisher can asphyxiate themselves in confined spaces. Equally using a water or foam extinguisher on an electrical based fire can lead to electrocution of the would-be fire fighter.

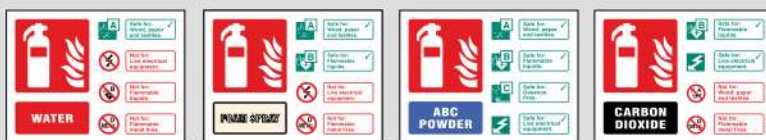

1 1237 1 1234 1 1233 1 1235
 2 1237 2 1234 2 1233 2 1235

Locating Fire Fighting Equipment

By fitting fire equipment signs at a height of 1.7 to 2 metres from the ground you significantly increase the opportunity for the equipment to be located - even when obscured by furnishings in the room.



5 8001 5 8002 5 8003 5 8004



1 1017 1 1018 5 9103 5 9105
 2 1017 2 1018



5 9186 5 9183



5 9184 5 9185



Q

1. Are fire extinguishers present in the reception area?
2. Do staff/visitors know how and on what type of fire they can be used?
3. Is fire equipment visible from distance and from all areas of the room?

If the answer to any of these questions is NO, Please find the sign/s you require to the left.



Signs For Reception Areas



Toilet Signs



1 7061 **G**
2 7061 **G**



5 9138 5 9139 5 9137
76mm Diameter Aluminium - Fixings included



1 5436 **K**



1 5408 **G M E**
2 5408 **G M**



1 4236 **A G**
2 4236 **A G K**



5 8516
300 x 575mm lightweight, double sided,
self-standing, foldable sign.



1 6622 **A**
2 6622 **A**



1 6620 **A**
2 6620 **A**

1. Can visitors easily locate toilets?
2. Are hot water tanks/taps clearly marked if they can reach a harmful temperature?
3. Do 'wash hands' signs currently appear in washrooms?
4. Are lights turned off automatically when someone leaves the washroom?
5. Are toilets inspected regularly and a cleaning program in place?

If the answer to any of these questions is NO, Please find the sign/s you require to the left.

Q

1. Do staff/visitors know whether the fire department is called manually or automatically upon detection of a fire?
2. Do staff/visitors know not to use a lift in the event of a fire?
3. Does every fire alarm call point have a fire action notice above it?
4. Does the company have a clear way of informing staff/visitors when a fire drill is due to take place?
5. Are fire marshals/wardens identified?

Fire Alarm

A key element of effective evacuation is the detection of a fire and manual activation of alarm call points. Legislation requires the duty holder to ensure building occupants can identify and locate this equipment. It is also a requirement that building occupants know the procedure to adopt in the event of an activation.



1 1428 **E H**
2 1428 **E H**



1 1427 **E H**
2 1427 **E H**



1 1439 **E H**
2 1439 **E H**



1 1037 **E**
2 1037 **E**



1 1213 **E H**
2 1213 **E H**



5 8062 - 300 x 210mm 1mm Rigid



5 6449

NOT WHAT YOU'RE LOOKING FOR? - CONTACT US!

Despite the thousands of standard safety sign messages available in our catalogue we appreciate that there will always be occasions when a customer needs something customised – whether it's adding a company logo, imagery or simply creating a unique 'one-off' sign.

Access & Security Signs



1 4209 **G M E K**
2 4209 **G M E K**



1 3205 **G M E K P**
2 3205 **G M E K**



1 4216 **G M E K**
2 4216 **G M E K**



1 3242 **G E K**
2 3242 **G E K**



1 5603 **E K**
2 5603 **E K**



1 5217 **E K**
2 5217 **E K**



1 3212 **E K**
2 3212 **E K**



1 1740 **H K**
2 1740 **H K**

- Q**
1. Are customers, visitors and staff aware of areas they are restricted from entering?
 2. Are there any unexpected trip hazards, changes in floor levels or overhead obstacles?
 3. Is PPE required before entering specific areas of the building?
 - 4.

If the answer to any of these questions is NO, Please find the sign/s you require to the left.



Braille & Tactile



5 6326



5 6490 225 x 150mm



5 6151 300 x 150mm



5 6149 300 x 150mm



5 6108 150 x 150mm



5 6109 150 x 150mm



5 6127 225 x 150mm



5 6176 300 x 150mm



5 6177 300 x 150mm

- Q**
1. Do people with a visual impairment visit your business?

If the answer to this questions is YES, Please find the sign/s you require to the left.

Emergency Escape



1 2007 **G L M**
2 2007 **G L M**
7 2007 **G L**



1 2008 **G L M**
2 2008 **G L M**
7 2008 **G L**



1 2004 **G L M**
2 2004 **G L M**
7 2004 **G L**



1 2052 **G L**
2 2052 **G L**



1 2051 **G L**
2 2051 **G L**



1 2003 **G L M**
2 2003 **G L M**
7 2003 **G L**

- Q**
1. Is there a fire exit sign with an arrow pointing upwards above each fire door? (Arrows should not point left or right if positioned above a door)
 2. With the exception of an office with one door out of it, can a fire exit sign be clearly seen from everywhere in the building?
 3. Do all fire exit signs show a running man and accompanying text?
 4. Have you replaced exit signs displaying the old EC Directive designs?
 5. Would fire exit signs be visible in the event of a power failure or through smoke?

NO? Please find the sign/s you require above.



Corridors & Stairwells

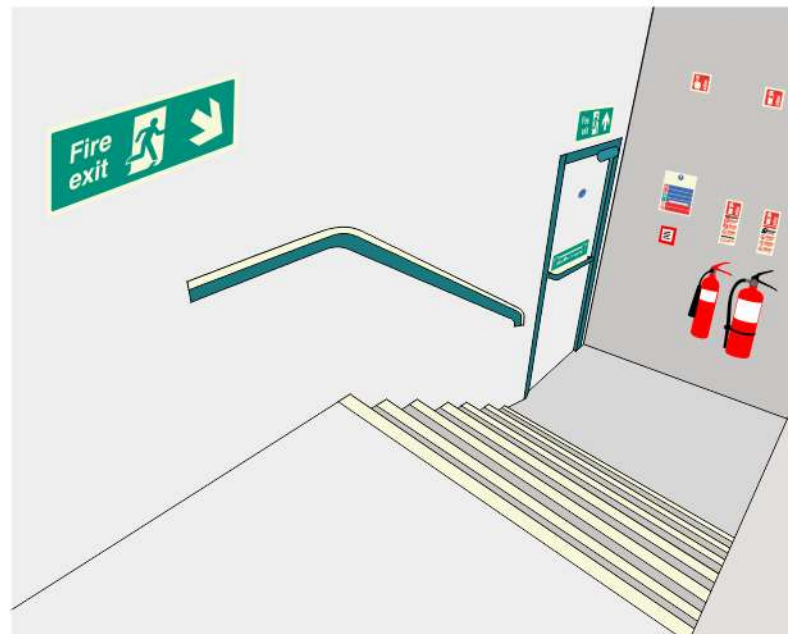

Corridors & Stairwells

Corridors and stairwells can prove a confusing labyrinth for visitors if rooms and emergency escape routes are not clearly signed. They are often used as the most direct passage for exiting a building in the event of an emergency and should be kept clear of obstacles (boxes, rubbish, furniture etc) at all times with fire doors clearly identified.

Signs to Consider for Corridors & Stairwells

Fire Equipment

By positioning an appropriate fire equipment sign at a height between 1.7 -2metres from the ground it helps to locate and identify essential fire equipment in the event of it being obscured by furnishings in the room.

For more info P5 of the catalogue



Emergency Escape

To assess your fire exit requirements you should start from the centre of the building, or point farthest from a fire exit and work towards the exit, noting changes in direction and levels. Fire exit signs should be placed at these points.

For more info P14 of the catalogue



Fire Doors

All fire exit doors should have a sign displayed to explain opening methods. Fire doors need to have a sign explaining that they must be kept shut. Fire escape doors must be kept clear of obstacles on both sides of the door.

For more info P12 of the catalogue



Stairwell Signs

Stairways may be the only way to exit a building in the event of a fire as lifts will usually be out of use. The risk of trips and falls under these conditions are increased and can present additional concerns for the visually or physically impaired.

For more info P59 of the catalogue



Extinguisher IDs

Under the Regulatory Reform (Fire Safety) Order 2005, any non-automatic fire fighting equipment should be identified with an appropriate sign. Training and instruction on how to use equipment is also required under PUWER.

For more info P4 of the catalogue



Non/Smoking Signs

Under BS EN ISO 7010 and BS 5499, as with First Aid signs and Fire Exits, signs relating to Designated Smoking Areas are deemed as Safe Condition signs. These signs should always use white text on a green background, alongside a tick or appropriate symbol.

For more info P28 of the catalogue



Bespoke

The custom made sign services that we offer, allow you to create a wide variety of signs that will fit even the most creative needs. We have several processes which we use on a regular basis, dependent upon volume, graphical content or even just personal taste. Despite the thousands of standard safety sign messages available in our catalogue we appreciate that there will always be occasions when a customer needs something customised - whether it's adding a company logo, imagery or simply creating a unique 'one-off' sign.

For more info P140 of the catalogue



Fire Equipment



1 1017 **B C U**
2 1017 **B C U**



1 1018 **C U**
2 1018 **C U**



1 1020 **C**



1 1021 **C**
2 1021 **C**



1 1025 **G L**



1 1023 **G L**
2 1023 **G L**

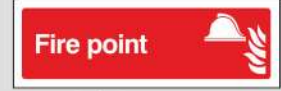

1 1026 **G L**
2 1026 **G L**



1 1024 **G**
2 1024 **G**



1 1013 **E K H**
2 1013 **E K H**



1 1007 **E K**
2 1007 **E**



1 1014 **E K H**
2 1014 **E K H**
7 1014 **E K**



1 1010 **E K**
2 1010 **E K**

Extinguisher IDs

if extinguishers aren't used correctly, they can become a hazard themselves. For example, untrained operators of a CO2 extinguisher can asphyxiate themselves in confined spaces. Equally using a water or foam extinguisher on an electrical based fire can lead to electrocution of the would-be fire fighter.



1 1237 **D E**
2 1237 **D E**



1 1234 **D E**
2 1234 **D E**



1 1214 **S**
2 1214 **S**



1 1215 **S**
2 1215 **S**



1 1216 **S**
2 1216 **S**



1 1217 **S**
2 1217 **S**



1 1233 **D E**
2 1233 **D E**



1 1235 **D E**
2 1235 **D E**

Stairwell Signs



3 2147 **L**



5 6187 450 x 150mm



3 2091 **G L**



3 2095 **E H**
4 2095 **E**



5 9853
Photoluminescent
1000 x 30 x 70mm (WxHxD)



- Q**
1. Is the direction of the fire escape route clearly indicated (up or down the stairs)?
 2. Do the stair treads and hand rails have contrasting colours to highlight edges to the visually impaired? Would this contrast be visible in the event of a power failure?
 3. Do you have measures in place for the safe evacuation of wheelchair users and/or visually impaired people in the event of an emergency?

If the answer to any of these questions is NO, Please find the sign/s you require to the right.

Emergency Escape



1 2007 **G L M**
2 2007 **G L M**
7 2007 **G L**



1 2008 **G L M**
2 2008 **G L M**
7 2008 **G L**



1 2004 **G L M**
2 2004 **G L M**
7 2004 **G L**



1 2003 **G L M**
2 2003 **G L M**
7 2003 **G L**



1 2052 **G L**
2 2052 **G L**

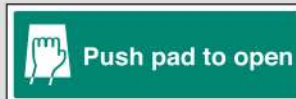

1 2051 **G L**
2 2051 **G L**



Fire Exit Doors



1 1605 **F N U**
2 1605 **F N U**



1 1606 **F N B**
2 1606 **F N B**
7 1606 **F**



1 1613 **F N**
2 1613 **F N**

Are internal fire doors clearly marked and free from obstacles?



1 2061 **G L**
2 2061 **G L**



1 2062 **G L**
2 2062 **G L**



1. Is the route to the designated smoking area clearly defined?

2. Are there areas within the building where Electronic Cigarettes are allowed?

If the answer to any of these questions is NO, Please find the sign/s you require to the right.

Smoking Restrictions



1 3086 **G**
2 3086 **G**



1 3257 **G**
2 3257 **G**



1 3256 **G**
2 3256 **G**



1 3080 **E**
2 3080 **E**



1 3003 **G M E K P**
2 3003 **G M E K P**
7 3003 **G M**



NOT WHAT YOU'RE LOOKING FOR? - CONTACT US!

Despite the thousands of standard safety sign messages available in our catalogue we appreciate that there will always be occasions when a customer needs something customised - whether it's adding a company logo, imagery or simply creating a unique 'one-off' sign. 01622 962302 or email hello@adplancreative.com

Signs to Consider for Offices

Prohibition Signs

Prohibition signs indicate an action or behaviour that must not be committed. Within the office environment these should be highly visible to insure employees and visitors do not forget the action they should not commit.

For more info P31 of the catalogue



Janitorial Signs

We can provide an extensive range of janitorial & WRAP compliant recycling signs ensure your office area is kept tidy, waste is recycled and spillages disposed of appropriately.

For more info P52 of the catalogue



First Aid Signs

Under the Health and Safety (First Aid) Regulations 1982 (as amended 1997) employers have a legal obligation to assess and introduce first aid provisions. Any such provisions should be easy to locate.

For more info P88 of the catalogue



Emergency Escape

It must not be assumed that everyone will know all safe routes through a building. Emergency escape signs are provided to guide people from wherever they are within a building to the place of ultimate safety (the assembly area).

For more info P14 of the catalogue



Fire Alarm Signs

The display of appropriate notices, in clear and precise format is recommended to support good fire safety management and formal training. Fire Action Notices provide important information to staff and visitors in the event of a fire.

For more info P10 of the catalogue



General Information

General information signs will help identify various facilities within a building and display important notices and requests to staff and visitors. Ensure toilets & restrooms are clearly marked and visible from all areas of the office.

For more info P76 of the catalogue



Bespoke

The custom made sign services that we offer, allow you to create a wide variety of signs that will fit even the most creative needs. We have several processes which we use on a regular basis, dependent upon volume, graphical content or even just personal taste. Despite the thousands of standard safety sign messages available in our catalogue we appreciate that there will always be occasions when a customer needs something customised - whether it's adding a company logo, imagery or simply creating a unique 'one-off' sign.

For more info P140 of the catalogue



Offices

With nearly one in three employees working in an office in the UK, the need to highlight potential hazards and fire risks is ever increasing. Check out our range of safety signs ideal for the office environment.

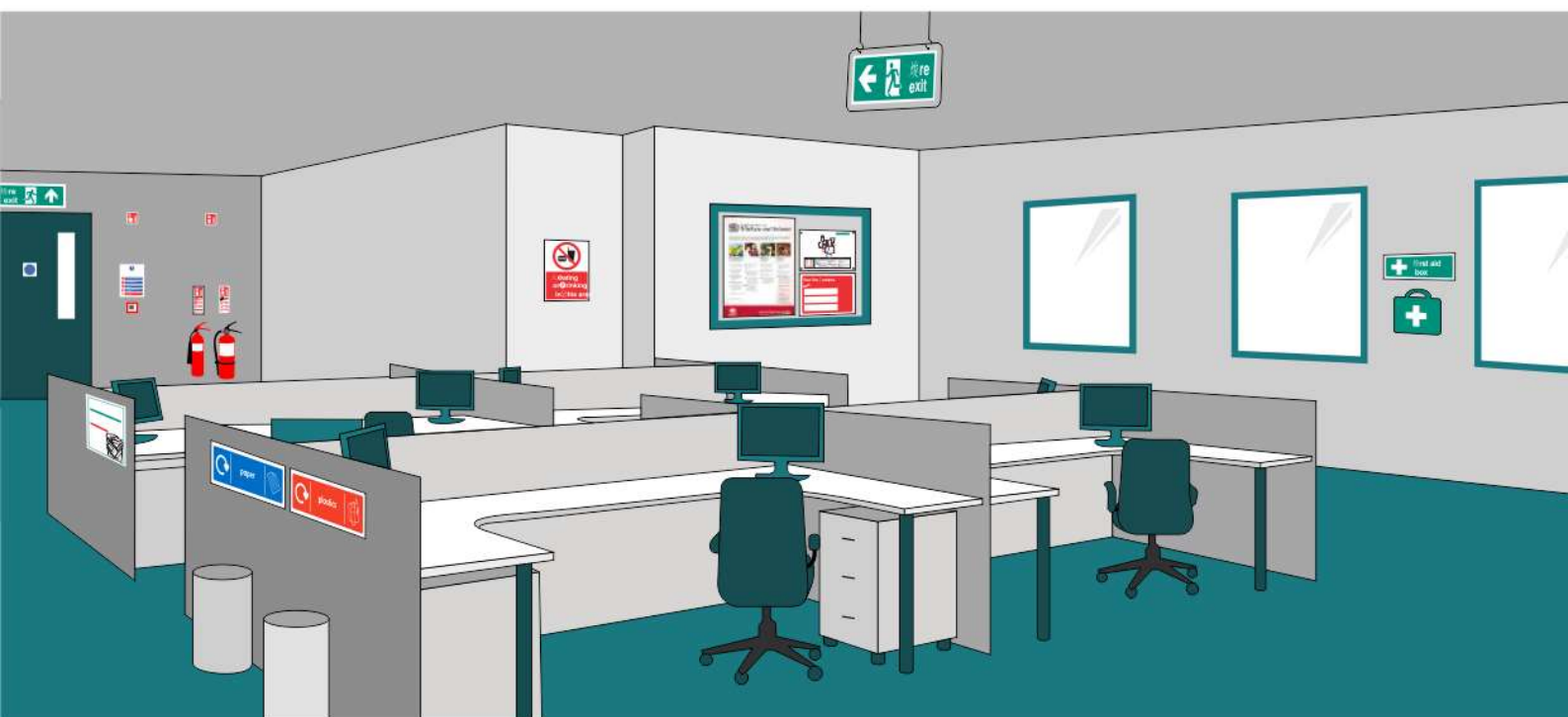



Prohibition Signs



1 3631 G M
2 3631 G M



No eating or drinking in this area

1 3232 E K
2 3232 E K



Cameras and camera phones prohibited

1 3643 E K
2 3643 E



1 3237 G M



1 3607 G M E K
2 3607 G M E K



1 3653 G
2 3653 G



5 3436

Q

1. Are mobile phones or cameras allowed in the office area?

2. Are there any plugs or devices which should not be switched off?

3. Do employees/visitors know not to use the lift in the event of a fire?

4. Is food or drink permitted in the office area?

If the answer to any of these questions is NO, Please find the sign/s you require to the left.



Janitorial Signs



1 6634 M
2 6634 G



1 6636 M
2 6636 G



1 6631 M
2 6631 G



1 6664 M
2 6664 G



1 6617 H
2 6617 H A



1 6618 H
2 6618 H A



1 6611 M

i

Under the Health and Safety (First Aid) Regulations 1981 (as amended 1997) employers have a legal obligation to assess and introduce first aid provisions.

Any such provision should be easy to locate in the event of an emergency.

First Aid & Safe Conditions



1 6002 H
2 6002 H



1 6003 H
2 6003 H

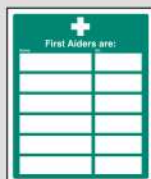

1 6022 H
2 6022 H



1 6024 U F
2 6024 U F



1 6026 U F
2 6026 U F



1 6016 F
2 6016 F



1 6004 H
2 6004 H



1 6053 H
2 6053 H



1 6007 A E H
2 6007 A E H



NOT WHAT YOU'RE LOOKING FOR? - CONTACT US!

Despite the thousands of standard safety sign messages available in our catalogue we appreciate that there will always be occasions when a customer needs something customised – whether it's adding a company logo, imagery or simply creating a unique 'one-off' sign. hello@adplancreative.com

Emergency Escape



1 2007 **G L M**
2 2007 **G L M**
7 2007 **G L**



1 2008 **G L M**
2 2008 **G L M**
7 2008 **G L**



1 2004 **G L M**
2 2004 **G L M**
7 2004 **G L**



1 2003 **G L M**
2 2003 **G L M**
7 2003 **G L**

Suspended Frames

| | | |
|-------|-----------|--------|
| Grey | 300x100mm | 5 8681 |
| Grey | 450x150mm | 5 8680 |
| Grey | 600x200mm | 5 8674 |
| White | 300x100mm | 5 8700 |
| White | 450x150mm | 5 8701 |
| White | 600x200mm | 5 8702 |
| Green | 300x100mm | 5 8703 |
| Green | 450x150mm | 5 8704 |
| Green | 600x200mm | 5 8705 |



Fire Alarm Signs



1 1439 **E H**
2 1439 **E H**



1 1428 **E H**
2 1428 **E H**



1 1427 **E H**
2 1427 **E H**



1 1419 **E H**
2 1419 **E H**



1 1213 **E H**
2 1213 **E H**

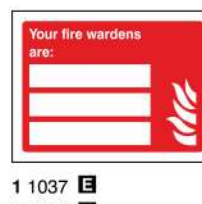

1 1037 **E**
2 1037 **E**

General Information



1 7081 **G**
2 7081 **G**



1 7024 **D F**
2 7024 **D F**



1 7025 **D F**
2 7025 **D F**



5 8062 - 300 x 210mm 1mm Rigid

i General information signs will help identify various facilities within a building and display important notices and requests to staff and visitors. Ensure toilets & restrooms are clearly marked and visible from all areas of the office.



1 5461 **E K**
2 5461 **E K**

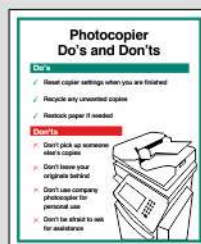

1 5629 **H**
2 5629 **H**



1 5630 **H**
2 5630 **H**



1 7028 **A**
2 7028 **A E**



1 7029 **A**
2 7029 **A E**



1 7020 **G**
2 7020 **G**

- Q**
- Do staff/visitors know whether the fire department is called manually or automatically upon detection of a fire?
 - Do staff/visitors know not to use a lift in the event of a fire?
 - Does every fire alarm call point have a fire action notice above it?
 - Does the company have a clear way of informing staff/visitors when a fire drill is due to take place?
 - Are fire marshals/wardens identified?

If the answer to any of these questions is NO, Please find the sign/s you require to the left.



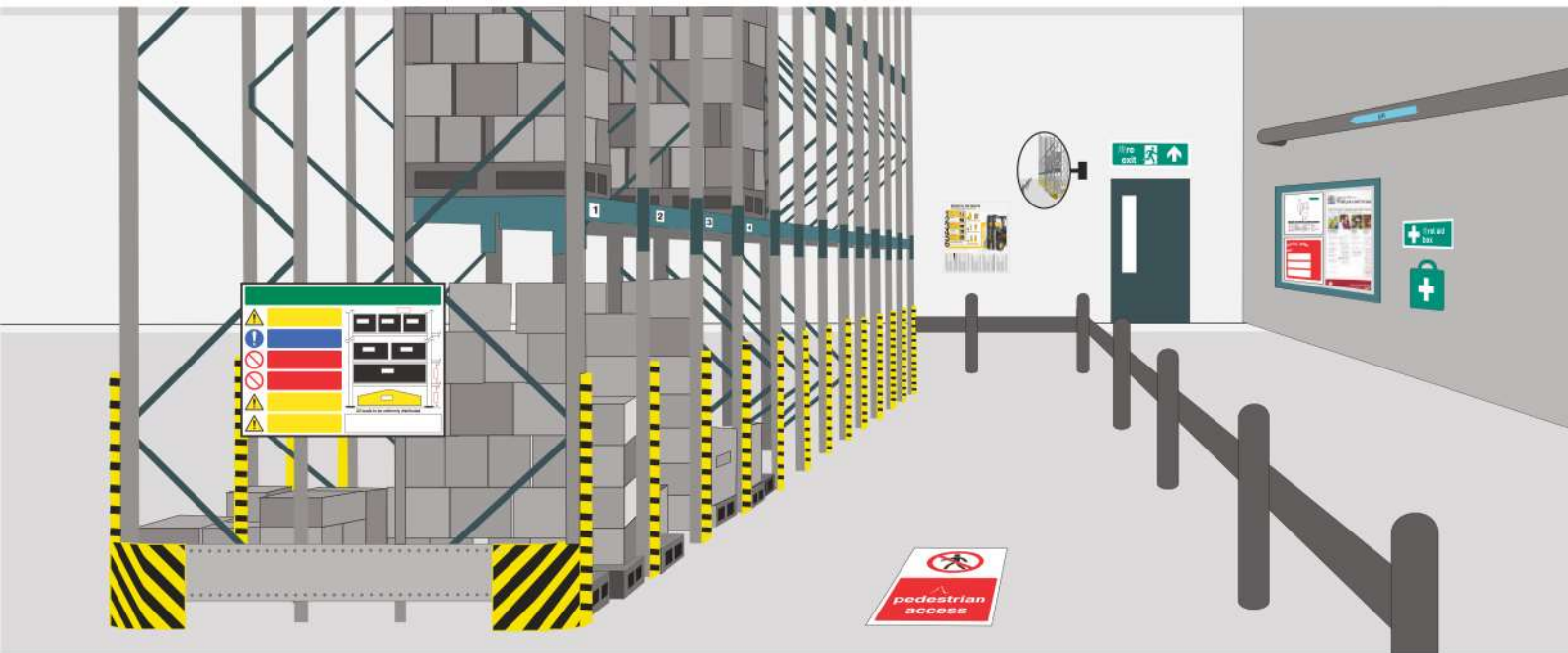

Factories & Warehouses

Warehouse signs ensure the safety of workers and products in a often noisy and busy environment. Most warehouse workers operate heavy machinery and encounter risks on a daily basis, therefore it is imperative that they are aware of proper procedures and potential hazards. The wall space in your warehouse is an obvious place to hang signage, but look beyond it if you want them to be noticed. Safety reminders can be placed next to equipment, on pallet racking or on the ground, making them incredibly difficult to ignore.

Signs to Consider for Corridors & Stairwells

Floor Marking

Highlight pallet positions, walkways and traffic flow with our range of tough PVC floor markers. Capable of withstanding every day traffic in a fully operational warehouse due to the aggressive adhesive backing.

For more info 63 of the catalogue



Labelling

A range of self adhesive letters and numbers for the identification of storage locations, bin numbers, aisles numbers, plant and equipment and many other applications.

For more info 62 of the catalogue



Emergency Escape

It must not be assumed that everyone will know all safe routes through a building. Emergency escape signs are provided to guide people from wherever they are within a building to the place of ultimate safety (the assembly area).

For more info 18 of the catalogue



Inspection Systems

Encourage safety checks on warehouse equipment with Good to Go Safety. Providing a means for assessing equipment and in doing so highlighting any defects and ultimately providing a safer workplace.

For more info 134 of the catalogue



Fire Equipment

By positioning an appropriate fire equipment sign at a height between 1.7 -2metres from the ground helps to locate and identify essential fire equipment in the event of it being obscured.

For more info 4 of the catalogue



Pipeline Identification

Health and Safety Regulations 1996 require employers to mark visible pipes in the workplace which contain or transport dangerous substances, including conduits for electrical services and ventilation ducting.

For more info 66 of the catalogue



Mirrors

Our range of overhead surveillance mirrors and 2-way safety mirrors are ideal for warehouses and industrial premises. All mirrors are supplied with wall fixings.

For more info 65 of the catalogue



Impact Protection

Impact protection systems cushion and warn of protruding corners, edges, vulnerable pipes and protect many other areas such as walls, kerbs and machinery. They are ideal for racking and shelving - protecting staff from injury and property from damage.

For more info 62 of the catalogue





Floor Marking



Hand held applicator 5 9604

Specially designed for comfortable hand use. Ideal for use with stencil sets. Makes marking steps or obstructions etc easy.



| Code | Description | Size | Qty |
|----------|-----------------------|-------------|-----|
| + 5 9505 | Centre Pallet Locator | 300 x 300mm | 10 |
| └ 5 9524 | Edge Pallet Locator | 300 x 200mm | 10 |
| └ 5 9508 | Corner Pallet Locator | 200 x 200mm | 10 |
| • 5 9509 | Walkway Locator | 90mm Dia | 100 |
| ↑ 5 9506 | Traffic Flow Marker | 90 x 90mm | 100 |
| • 5 9507 | Walkway Footprints | 300 x 100mm | 10 |



5 8663
95mm diameter



5 8664
125mm diameter



5 8734



5 8822



5 8819

Labelling



| Letter Size | A to Z (26 pack) | * Individual Letter (10 pack) | Number Size | 0 to 9 (10 pack) | * Individual Number (10 pack) |
|-------------|---------------------|----------------------------------|----------------|---------------------|----------------------------------|
| 45 x 130mm | 5 9840 | 5 9670 | 45 x 130mm | 5 9846 | 5 9676 |
| 38 x 90mm | 5 9841 | 5 9671 | 38 x 90mm | 5 9847 | 5 9677 |
| 21 x 56mm | 5 9842 | 5 9672 | 21 x 56mm | 5 9848 | 5 9678 |
| 14 x 19mm | 5 9843 | 5 9673 | 14 x 19mm | 5 9849 | 5 9679 |

To order, state the individual letter or number you require and your choice of colour (black on white or black on yellow)



1: Are pedestrian only walkways highlighted?

2: Are pedestrians warned of forklifts and other heavy equipment?

3. Are all bins / pallet racking / equipment easily identified from one another?

4. Are there two way mirrors at blind corners?

If the answer to any of these questions is NO, Please find the sign/s you require to the right.

Mirrors

For use in warehouses, factories, high-risk collision situations and direct observation of hidden parts of machinery.

| Size | Viewing Distance | Code |
|-------------|------------------|--------|
| 300 x 300mm | 3m | 5 9201 |
| 400 x 400mm | 5m | 5 9202 |
| 500 x 500mm | 7m | 5 9203 |
| 600 x 600mm | 11m | 5 9204 |
| 700 x 700mm | 15m | 5 9205 |
| 800 x 800mm | 20m | 5 9206 |

These mirrors assist can help eliminate blind spots at corners, concealed entrances / exits, car parks and junctions.

| Mirror Size | Frame Size | Viewing Distance | Code |
|--------------|--------------|------------------|--------|
| 600 x 400mm | 680 x 500mm | 9m | 5 9213 |
| 800 x 600mm | 950 x 750mm | 20m | 5 9214 |
| 1000 x 800mm | 1150 x 950mm | 30m | 5 9215 |





5. Are the emergency escape routes clearly seen from all areas of the warehouse?

6. Should a fire break out, are the fire alarm call points and fire fighting equipment easily found and understood?

7. Are any pipes exposed without identification?

If the answer to any of these questions is NO, Please find the sign/s you require to the right.

Emergency Escape

Large format signs manufactured from 5mm foam PVC for use in large open plan areas.



5 2106 800 x 400mm



5 2105 800 x 400mm



5 2138 1200 x 400mm



5 2129 1200 x 400mm



5 2128 1200 x 400mm



5 2139 1200 x 400mm



Fire Equipment



5 8002



5 8003



5 8004



5 8040



1 1018 C U
2 1018 C U



1 1017 B C U
2 1017 B C U

| Types of Modern Fire Extinguishers | | | | | |
|---|---|---|---|--|---|
| WATER | FOAM SPRAY | ABC POWDER | CARBON DIOXIDE | WET CHEMICAL | HYDRO SPRAY |
| <ul style="list-style-type: none"> ✓ SAFE FOR: Wood, paper and textiles ✗ NOT FOR: Flammable liquid fires ✗ NOT FOR: Live electrical equipment ✗ NOT FOR: Flammable METAL fires | <ul style="list-style-type: none"> ✓ SAFE FOR: Wood, paper and textiles ✓ SAFE FOR: Flammable liquids ✗ NOT FOR: Live electrical equipment ✗ NOT FOR: Flammable METAL fires | <ul style="list-style-type: none"> ✓ SAFE FOR: Wood, paper and textiles ✓ SAFE FOR: Flammable liquids ✓ SAFE FOR: Gaseous fires ✓ SAFE FOR: Live electrical equipment | <ul style="list-style-type: none"> ✓ SAFE FOR: Flammable gases ✓ SAFE FOR: Live electrical equipment ✗ NOT FOR: Flammable liquid fires ✗ NOT FOR: Flammable METAL fires | <ul style="list-style-type: none"> ✓ SAFE FOR: Cooking oils and animal fats ✓ SAFE FOR: Flammable liquids ✓ SAFE FOR: Flammable gases ✓ SAFE FOR: Live electrical equipment ✗ NOT FOR: Flammable liquid fires ✗ NOT FOR: Flammable METAL fires | <ul style="list-style-type: none"> ✓ SAFE FOR: Wood, paper and textiles ✓ SAFE FOR: Flammable liquid fires ✓ SAFE FOR: Live electrical equipment ✗ NOT FOR: Flammable METAL fires |

1 1226 L
2 1226 L



1 1010 E (K)
2 1010 E (K)



1 1004 E
2 1004 E



NOT WHAT YOU'RE LOOKING FOR?

Despite the thousands of standard safety sign messages available in our catalogue we appreciate that there will always be occasions when a customer needs something customised – whether it's adding a company logo, imagery or simply creating a unique 'one-off' sign.

01622 962302

hello@adplancreative.com

Pipeline Identification

Tape with directional arrows indicating direction of flow in a pipe.

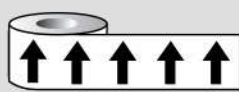

5 9876



5 9877

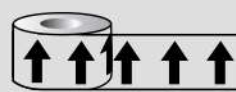

5 9878 (CLEAR)



5 9879



5 9888



5 9889



| Colour Band | Pipe Contents | BS4800 | Code |
|--------------|-------------------------------------|---------|--------|
| Green | Water | 12 D 45 | 5 9989 |
| Silver -Grey | Steam | 10 A 03 | 5 9990 |
| Brown | Oils | 06 C 39 | 5 9991 |
| Yellow Ochre | Gases | 08 C 35 | 5 9992 |
| Violet | Acids & Alkalis | 22 C 37 | 5 9993 |
| Light Blue | Air | 20 E 51 | 5 9994 |
| Black | Other Liquids | 00 E 53 | 5 9995 |
| Orange | Electrical & Ventilation | 06 E 51 | 5 9996 |
| Red | Fire Fighting | 04 E 53 | 5 9997 |
| Yellow | Warning | 08 E 51 | 5 9998 |
| Dark Blue | Fresh Water -potable or non potable | 18 E 53 | 5 9999 |

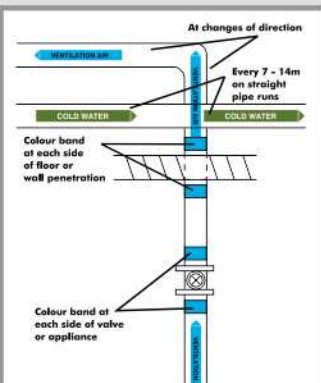

Impact Protection

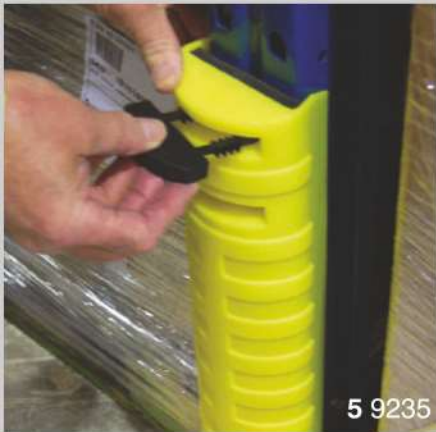

The impact protection system cushions and warns of protruding corners, edges, vulnerable pipes and protects many other areas such as walls, kerbs, trolley parks, vehicles, plant and machinery and is ideal for racking and shelving.

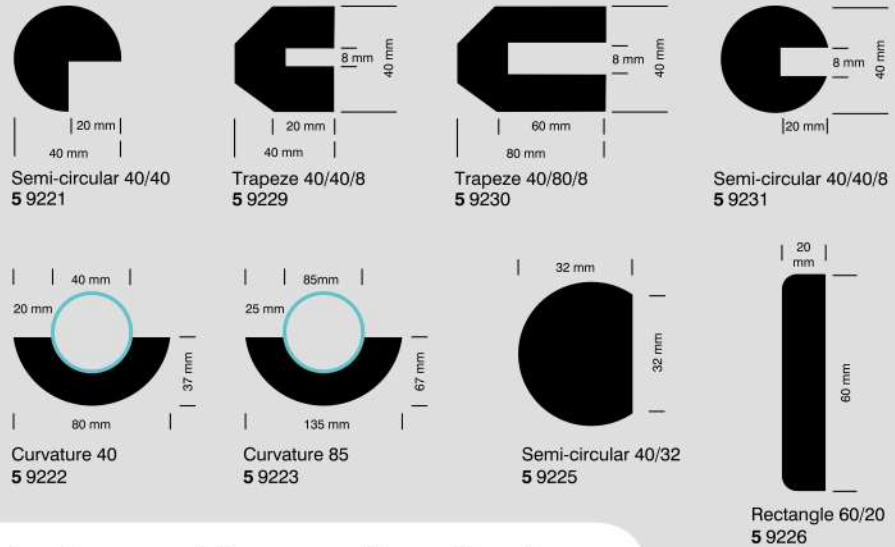

8. Are exposed areas of pallet racking protected with impact protection?

9. Is your workplace equipment (such as forklifts, pallet trucks, ladders, podium steps) checked before use?

10. Has pallet racking been inspected for damage?

If the answer to any of these questions is NO, Please find the sign/s you require to the right.

Equipment Inspection System



Equipment tagging and inspection system designed to improve workplace safety. Perfect for ensuring warehouse equipment is always 'Good to Go'. Simply attach tag to equipment and use the corresponding check book to carry out an inspection, inserting the completed checklist inside the tag.

Components

Status Tag **5 1301** Wallet & Pen **5 1308** Tamper Evident Seal **5 1307**

Check Book (25 Checks)

Forklift **5 1302**
 Ladder **5 1304**
 Podiums **5 1330**
 Pallet Trucks **5 1336**
 Racking **5 1305**
 Fleet Vehicles **5 1306**
 Trailers **5 1339**
 Bespoke **5 1317**

Weekly Kit

Forklift **5 1309**
 Ladder **5 1311**
 Podiums **5 1331**
 Pallet Trucks **5 1337**
 Racking **5 1312**
 Fleet Vehicles **5 1328**
 Trailers **5 1340**
 Bespoke **5 1333**

Daily Kit

Forklift **5 1313**
 Ladder **5 1315**
 Podiums **5 1332**
 Pallet Trucks **5 1338**
 Racking **5 1316**
 Fleet Vehicles **5 1329**
 Trailers **5 1341**
 Bespoke **5 1334**





01622 962302

www.adplancreative.com

Henley House, 1 Henley Fields, Weaving, Maidstone, Kent, ME14 5UY

hello@adplancreative.com