



Under the thorough supervision of our in-house Site Team, EAST SUNRISE currently have 4 of these vessels under construction.

MAIN FEATURES

- Multipurpose Offshore Supply Vessel, designed for the general offshore field supply duties for a safe and economic worldwide service.

- The Vessel have Diesel Electric Frequency Controlled propulsion system.

- 46 bed accommodation in existing configuration

- FIFI I

- DP II

- Clean Class

- Comfort Class

- Full underdeck PSV capacities, including Methanol tanks.

- > 870 m² free cargo deck area

- Optional Oilrec Class

Description

General description

Name	TBN
Type	Multipurpose Offshore Support Vessel
Class	ABS CLASS Notation ✕A1, Offshore Support Vessel, Circle E, ✕AMS, ✕ACCU, ✕DPS-2, ENVIRO, HAB(WB), UWILD, Fire Fighting Vessel Class 1
Other Compliances:	IMO Resolution MSC.236(82) Transport Limited Amounts of Hazardous and Noxious Liquids on Offshore Support Vessels IMO resolution MSC.235(82) Guidelines for the Design and Construction of Offshore Supply Vessels
Design:	Rolls Royce Marine AS, Norway, UT 771 CDL
Flag	Built according to Hong Kong flag

Main Details

Main Particulars

Length overall:	83,75 m
Length between p.p:	76,35 m
Breath moulded:	18,00 m
Depth main deck:	7,00 m
Design draught mid-ship:	5,80 m

Cargo Deck

Deck length:	58 m
Deck breath:	15 m
Free cargo deck area:	870 m ²
Deck load (c.o.g. 1m above deck):	2100 t (approx.)
Deck strength	5 tonne per m ²

Performance

Trial speed	approx. 14.5 kn
Economic speeds	approx. 10 – 12 kn

Capacities

Deadweight (T = 5.8 m)	approx. 3800 tonne
Gross tonnage	approx. 3190 tonne

Tanks

Ballast/Drilling water (incl. combination tanks)	approx. 1750 m ³
Fuel Oil (dedicated tanks)	approx. 440 m ³
Fuel Oil (incl. combination tanks)	approx. 1100 m ³
Fresh Water (dedicated tanks)	approx. 380 m ³
Fresh Water (incl. combination tanks)	approx. 800 m ³
Liquid Mud (10 combination tanks)	approx. 1010 m ³
Brine (10 combination tanks)	approx. 1010 m ³
Base Oil (2 combination tanks)	approx. 210 m ³
Dry Bulk (6 tanks)	approx. 315 m ³
Methanol & other LFL * products (2 x stainless tanks)	approx. 150 m ³

Cargo Systems & Deck Machinery

Cargo Discharge Systems:

Fresh Water : Allweiler	1 x 0 - 200m ³ /h – 9 bar,
Ballast/ Drill water : Allweiler	1 x 0 - 200m ³ /h – 9 bar,
Fuel Oil : Allweiler	1 x 0 – 200 m ³ /h - 9 bar,
Mud Pumps*: Allweiler	2 x 0 – 75 m ³ /h – 18 bar,
Brine Pump *: Allweiler	2 x 0 – 75 m ³ /h – 18 bar,
Base Oil:	
Mud & Brine pumps are eccentric screw pump. el. driven, freq. contr.	

Mud Agitator System

Allweiler Mud agitators installed in all Mud tanks

Tank washingsystem

Alfa Laval tank washing system installed for all Mud tanks

Dry bulk system

One off Rolls-Royce bulk handling system consisting of dry bulk tanks, compressors etc.. The system is capable of discharging two types of cargo simultaneously.

Deck Machinery

Comb. windlass / Mooring winch:	1 x SWL 15 T, Rolls Royce
Capstans:	2 x SWL 10 T, Rolls Royce
Tugger Winch :	2 x SWL 10 T pull, Rolls Royce
Deck Crane:	1 x 3 T – 1,8 m - 16 m

Deck Fastening

Steel eye plates on deck & Cargo rails:	40 nos. 10t SWL
Guide rollers:	14 nos, total in cargo rails
D Rings:	10 nos. 11t SWL

FiFi I Systems

The vessel is equipped with FiFi I equipment and will carry the ABS notation Fire Fighting Vessel Class 1. The FiFi system consists of: 2 off remote controlled monitors installed on platform on top of the wheelhouse.

Throw length :	120 m
Throw height (from sea level) :	50 m
Capacity each :	1200 m ³ /h

Machinery & Propulsion

Power Plant

4 x MTU 12V4000M23S
4 x 1310 ekW @ 1800 rpm
Total 5240 ekW

MTU engines are IMO Tier II compliant

Harbour/Emergencygenerator

1 x Caterpillar C18
1 x 400 ekW

Propulsion

Main Azimuth Thrusters:

2 x RRM AZP 85 FP azimuth thrusters
2 x 1600 kW

Electric Motor:

2 x RRM supplied electric motors
2 x 1600 kW @ 1800 rpm

Forward Azimuth Thruster:

1 x Rolls Royce Marine UL 911 FP
725 kW

Bow Thruster:

1 x Rolls Royce Marine TT 2000 DPN FP
790 kW

All Above motors are frequency controlled by Rolls-Royce AFE's.

Electro/ Automation systems

Electrical Systems

690 V AC / 60 Hz
440 V AC / 60 Hz
230 V AC / 60 Hz
24 V DC

Common Control Platform

Rolls-Royce's Common Control Platform (CCP) technology uses standard hardware and software modules that are common across all control products developed by Rolls-Royce giving a seamless integration of all different Rolls-Royce systems.

On board of the UT 771 CDL the following systems are based on CCP:

- Helicon X3 for propeller and thruster control
- PosCon joystick
- Icon DP

Automationsystems

Rolls-Royce ACON automation system including consoles and the following functions

- o Alarm and monitoring
- o Power Management
- o Pump and valve control
- o Tank sounding
- o Loading and stability
- o Roll reduction tank

Rolls-Royce Poscon joystick system

Rolls-Royce Icon DP2 system

DP System

Dynamic Positioning System according to ABS class DPS-2,
(Compliant with IMO DP II Class)

Equipment System & Configuration:

DP System:

- 1 x RRM PosCon Joystick system
- 1 x RRM Icon DP2 DP system with:
 - Enhanced safety and reliability (triple redundant solution)
 - Eco positioning modes

Reference Systems

- 1 x GNSS receiver type Kongsberg DPS 232 (DGPS)
- 1 x GNSS receiver type Kongsberg DPS 132 (DGPS)
- 1 x Laser based reference system (CyScan)
- 1 x Radar based reference system (RADIUS 1000 D, with 700 series transponder)
- 3 x Wind sensor
- 2 x Motion Reference Sensors

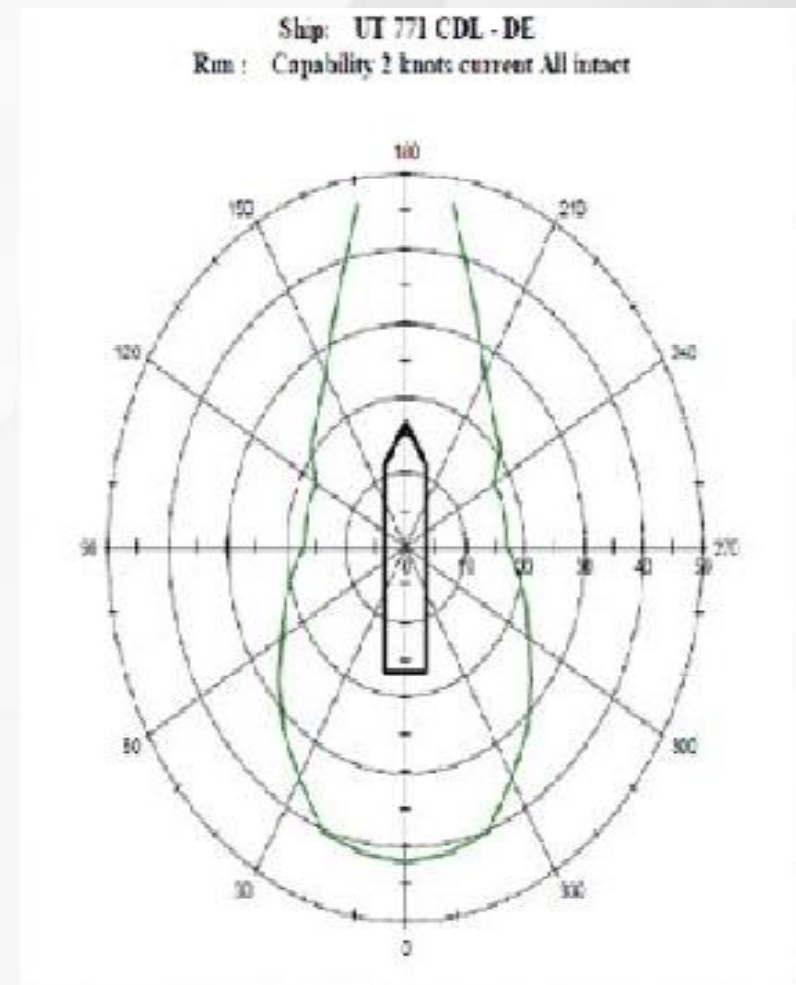

Accommodation, Lifesaving & other

Accommodation

The vessel to have accommodation and equipment for 46 persons (34 crew and 12 passengers).

Crew	34 persons
Passengers	12 persons

Total	46 persons

Cabins:

- 3 x 1-person cabins with separate sleeping cabin
- 7 x 1-person cabins
- 14 x2-person cabins (2 of which for passengers)
- 2 x 4-person (passenger) cabins

Additional Work Rooms : Workshop, Gymnasium

Freezer & Refrigerator: Suitable for crew compliment

Lifesaving Appliances

The vessel to have safety equipment according to SOLAS for 46 persons.

HAB (WB)

The vessel will be classed according to ABS HAB requirements (Habitability on Work Boats), with special attention to:

- Vibration requirements
- Noise requirements
- Requirements for indoor climate
- Accommodation area criteria (partly related to MLC 2006)

Power & Speed curves

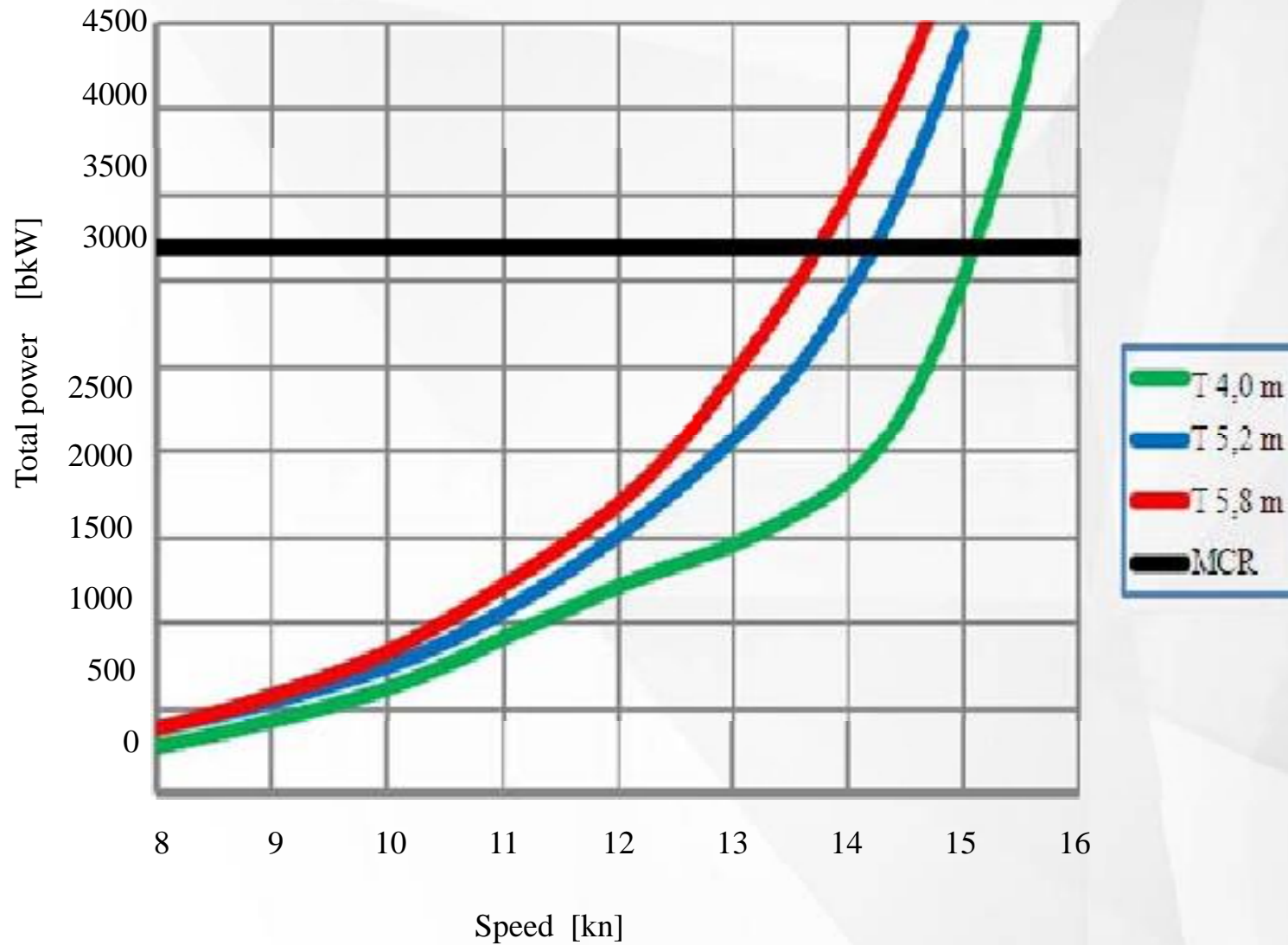

Deck Layout

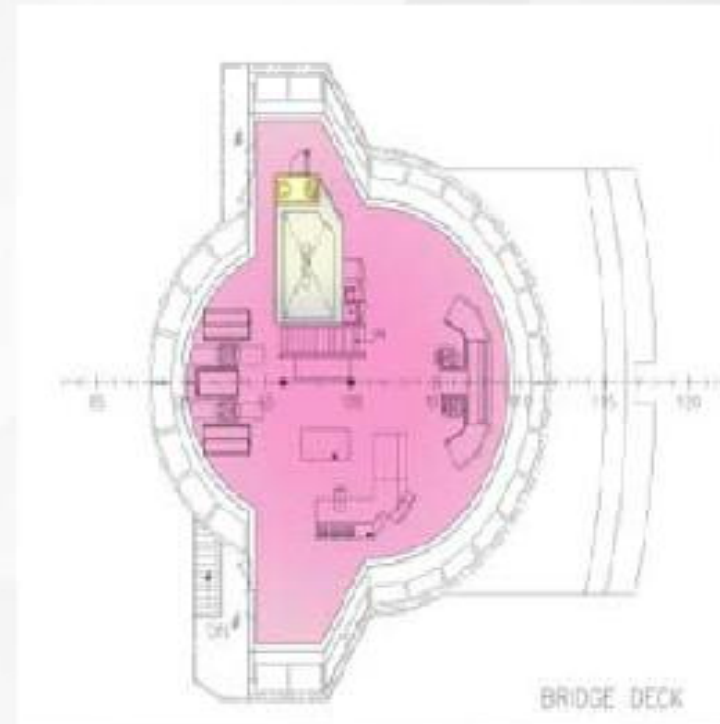
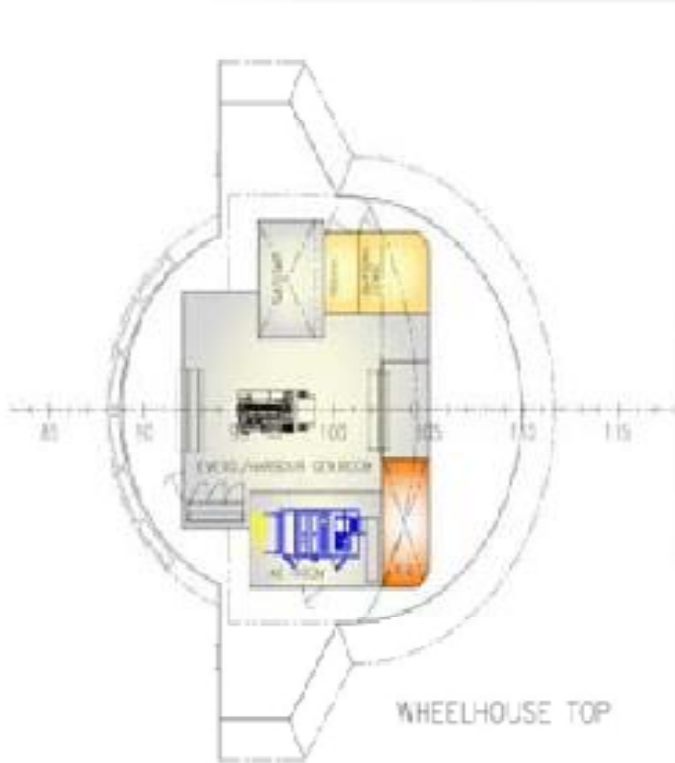

ITEM NO.	DESCRIPTION	COLOR
1	EVERY/PASSAGE DECK ROOM	Yellow
2	BRIDGE DECK	Pink
3	WHEELHOUSE TOP	Blue
4	WHEELHOUSE DECK	Green
5	WHEELHOUSE DECK	Orange
6	WHEELHOUSE DECK	Red
7	WHEELHOUSE DECK	Purple
8	WHEELHOUSE DECK	Light Blue
9	WHEELHOUSE DECK	Light Green
10	WHEELHOUSE DECK	Light Orange
11	WHEELHOUSE DECK	Light Purple
12	WHEELHOUSE DECK	Light Blue
13	WHEELHOUSE DECK	Light Green
14	WHEELHOUSE DECK	Light Orange
15	WHEELHOUSE DECK	Light Purple
16	WHEELHOUSE DECK	Light Blue
17	WHEELHOUSE DECK	Light Green
18	WHEELHOUSE DECK	Light Orange
19	WHEELHOUSE DECK	Light Purple
20	WHEELHOUSE DECK	Light Blue
21	WHEELHOUSE DECK	Light Green
22	WHEELHOUSE DECK	Light Orange
23	WHEELHOUSE DECK	Light Purple
24	WHEELHOUSE DECK	Light Blue
25	WHEELHOUSE DECK	Light Green
26	WHEELHOUSE DECK	Light Orange
27	WHEELHOUSE DECK	Light Purple
28	WHEELHOUSE DECK	Light Blue
29	WHEELHOUSE DECK	Light Green
30	WHEELHOUSE DECK	Light Orange
31	WHEELHOUSE DECK	Light Purple
32	WHEELHOUSE DECK	Light Blue
33	WHEELHOUSE DECK	Light Green
34	WHEELHOUSE DECK	Light Orange
35	WHEELHOUSE DECK	Light Purple
36	WHEELHOUSE DECK	Light Blue
37	WHEELHOUSE DECK	Light Green
38	WHEELHOUSE DECK	Light Orange
39	WHEELHOUSE DECK	Light Purple
40	WHEELHOUSE DECK	Light Blue
41	WHEELHOUSE DECK	Light Green
42	WHEELHOUSE DECK	Light Orange
43	WHEELHOUSE DECK	Light Purple
44	WHEELHOUSE DECK	Light Blue
45	WHEELHOUSE DECK	Light Green
46	WHEELHOUSE DECK	Light Orange
47	WHEELHOUSE DECK	Light Purple
48	WHEELHOUSE DECK	Light Blue
49	WHEELHOUSE DECK	Light Green
50	WHEELHOUSE DECK	Light Orange
51	WHEELHOUSE DECK	Light Purple
52	WHEELHOUSE DECK	Light Blue
53	WHEELHOUSE DECK	Light Green
54	WHEELHOUSE DECK	Light Orange
55	WHEELHOUSE DECK	Light Purple
56	WHEELHOUSE DECK	Light Blue
57	WHEELHOUSE DECK	Light Green
58	WHEELHOUSE DECK	Light Orange
59	WHEELHOUSE DECK	Light Purple
60	WHEELHOUSE DECK	Light Blue
61	WHEELHOUSE DECK	Light Green
62	WHEELHOUSE DECK	Light Orange
63	WHEELHOUSE DECK	Light Purple
64	WHEELHOUSE DECK	Light Blue
65	WHEELHOUSE DECK	Light Green
66	WHEELHOUSE DECK	Light Orange
67	WHEELHOUSE DECK	Light Purple
68	WHEELHOUSE DECK	Light Blue
69	WHEELHOUSE DECK	Light Green
70	WHEELHOUSE DECK	Light Orange
71	WHEELHOUSE DECK	Light Purple
72	WHEELHOUSE DECK	Light Blue
73	WHEELHOUSE DECK	Light Green
74	WHEELHOUSE DECK	Light Orange
75	WHEELHOUSE DECK	Light Purple
76	WHEELHOUSE DECK	Light Blue
77	WHEELHOUSE DECK	Light Green
78	WHEELHOUSE DECK	Light Orange
79	WHEELHOUSE DECK	Light Purple
80	WHEELHOUSE DECK	Light Blue
81	WHEELHOUSE DECK	Light Green
82	WHEELHOUSE DECK	Light Orange
83	WHEELHOUSE DECK	Light Purple
84	WHEELHOUSE DECK	Light Blue
85	WHEELHOUSE DECK	Light Green
86	WHEELHOUSE DECK	Light Orange
87	WHEELHOUSE DECK	Light Purple
88	WHEELHOUSE DECK	Light Blue
89	WHEELHOUSE DECK	Light Green
90	WHEELHOUSE DECK	Light Orange
91	WHEELHOUSE DECK	Light Purple
92	WHEELHOUSE DECK	Light Blue
93	WHEELHOUSE DECK	Light Green
94	WHEELHOUSE DECK	Light Orange
95	WHEELHOUSE DECK	Light Purple
96	WHEELHOUSE DECK	Light Blue
97	WHEELHOUSE DECK	Light Green
98	WHEELHOUSE DECK	Light Orange
99	WHEELHOUSE DECK	Light Purple
100	WHEELHOUSE DECK	Light Blue

Deck Layout

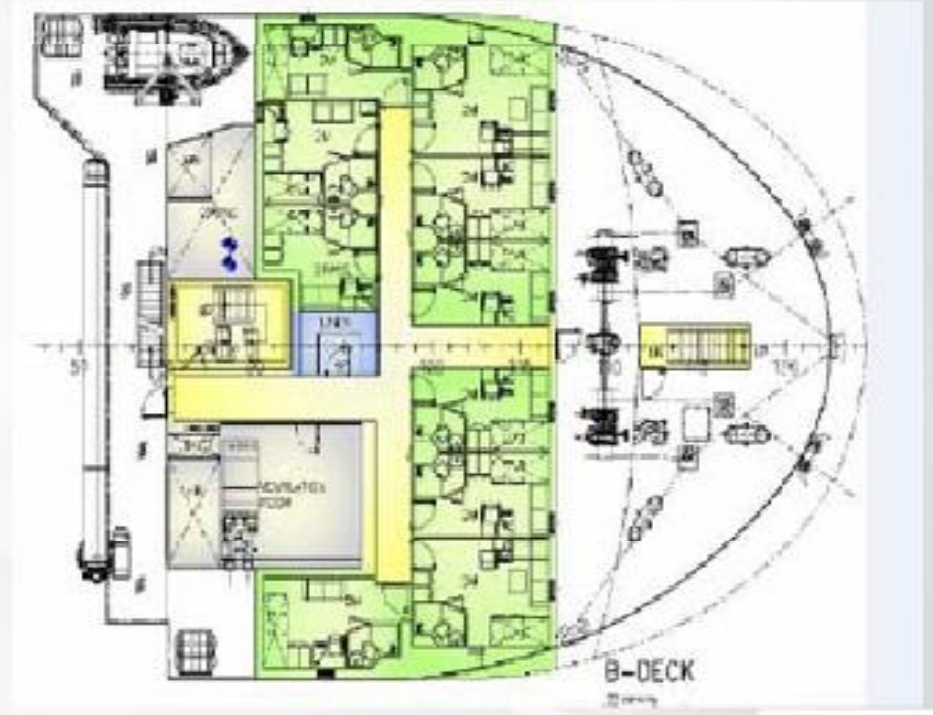
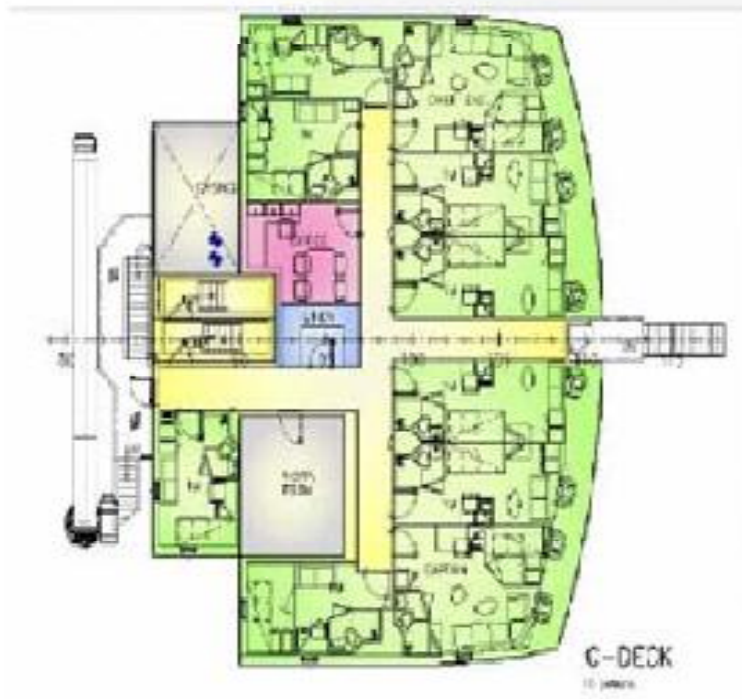

OFFICE AREA	Blue
LABORATORY	Yellow
WORK AREA	Green
STORAGE	Grey
RESTROOM	Pink
MECHANICAL ROOM	Orange
STAIRWAY	Light Green

Details believed to be correct, but not guaranteed

Deck Layout

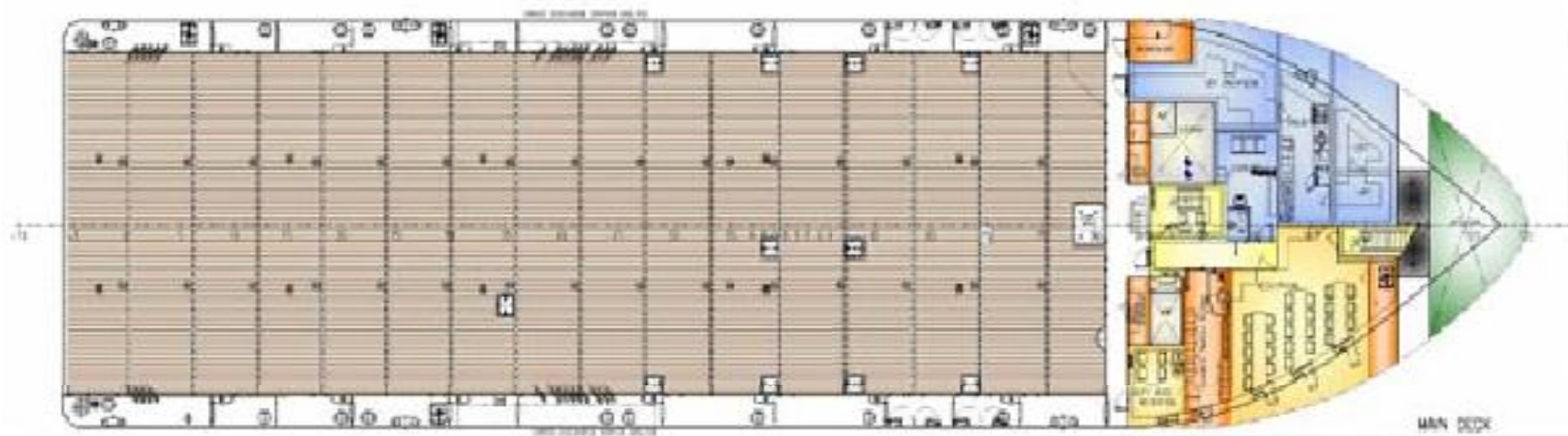
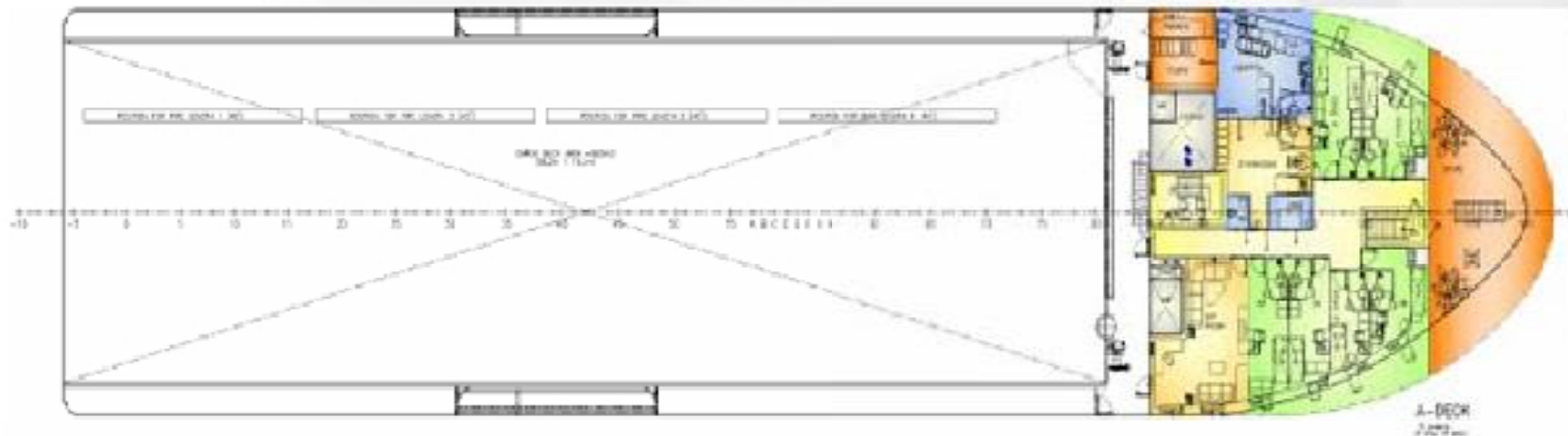

TYPE OF AREA	CODE
OFFICE AREA	01
OFFICE	02
OFFICE (COMMON)	03
OFFICE	04
OFFICE (COMMON)	05
OFFICE (COMMON)	06
OFFICE (COMMON)	07
OFFICE (COMMON)	08
OFFICE (COMMON)	09
OFFICE (COMMON)	10

Details believed to be correct, but not guaranteed

Deck Layout

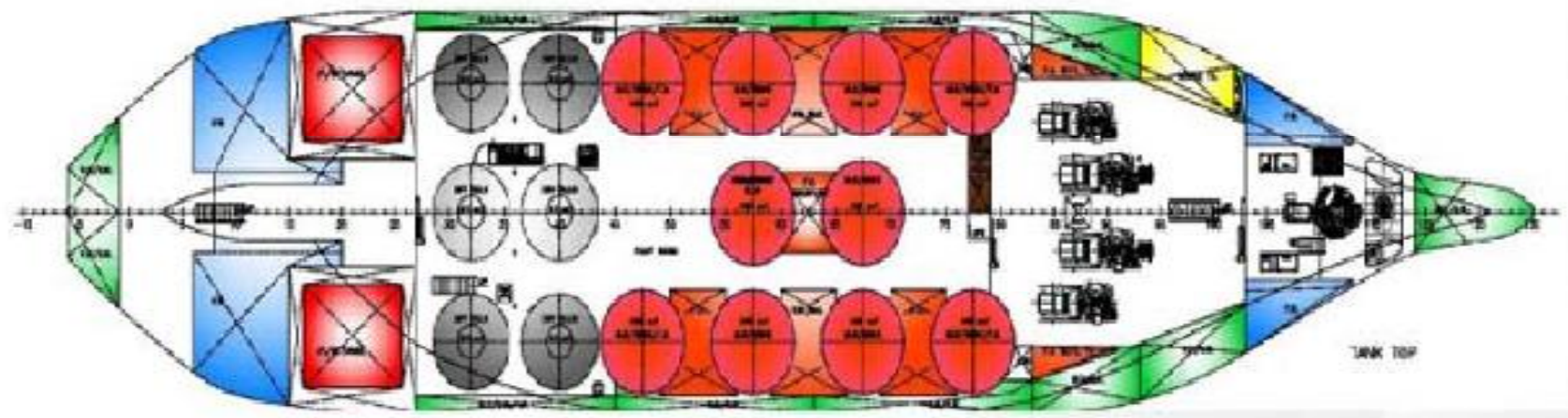
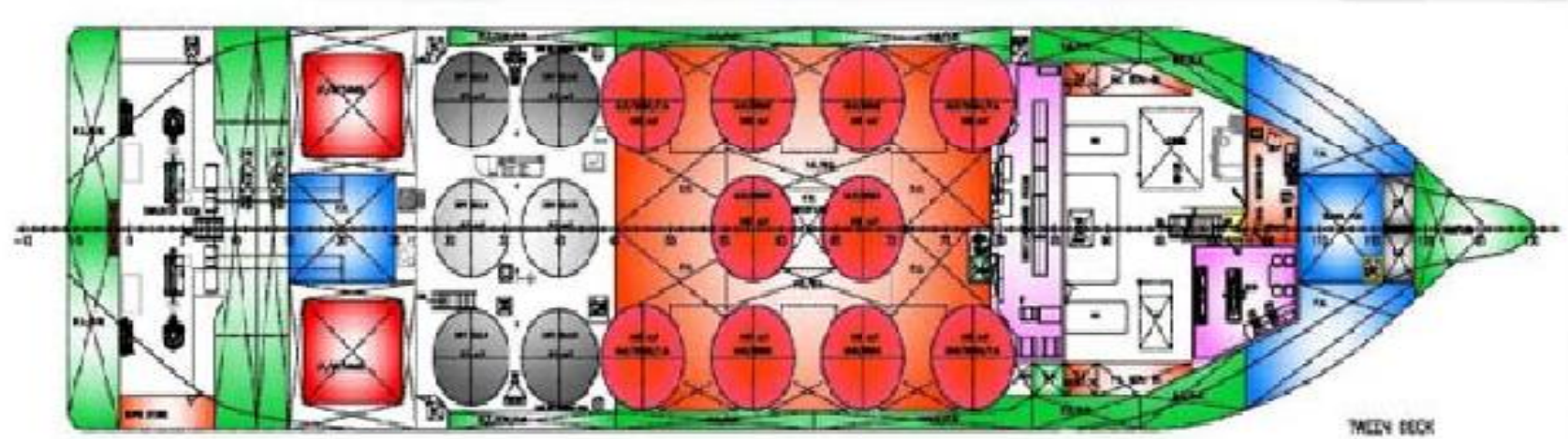

ITEM NO.	DESCRIPTION	COLOUR
1	WATER TANK	Grey
2	METHANOL TANK	Red
3	WATER TANK	Blue
4	WATER TANK	Blue
5	WATER TANK	Blue
6	WATER TANK	Blue
7	WATER TANK	Blue
8	WATER TANK	Blue
9	WATER TANK	Blue
10	WATER TANK	Blue
11	WATER TANK	Blue
12	WATER TANK	Blue
13	WATER TANK	Blue
14	WATER TANK	Blue
15	WATER TANK	Blue
16	WATER TANK	Blue
17	WATER TANK	Blue
18	WATER TANK	Blue
19	WATER TANK	Blue
20	WATER TANK	Blue
21	WATER TANK	Blue
22	WATER TANK	Blue
23	WATER TANK	Blue
24	WATER TANK	Blue
25	WATER TANK	Blue
26	WATER TANK	Blue
27	WATER TANK	Blue
28	WATER TANK	Blue
29	WATER TANK	Blue
30	WATER TANK	Blue
31	WATER TANK	Blue
32	WATER TANK	Blue
33	WATER TANK	Blue
34	WATER TANK	Blue
35	WATER TANK	Blue
36	WATER TANK	Blue
37	WATER TANK	Blue
38	WATER TANK	Blue
39	WATER TANK	Blue
40	WATER TANK	Blue
41	WATER TANK	Blue
42	WATER TANK	Blue
43	WATER TANK	Blue
44	WATER TANK	Blue
45	WATER TANK	Blue
46	WATER TANK	Blue
47	WATER TANK	Blue
48	WATER TANK	Blue
49	WATER TANK	Blue
50	WATER TANK	Blue
51	WATER TANK	Blue
52	WATER TANK	Blue
53	WATER TANK	Blue
54	WATER TANK	Blue
55	WATER TANK	Blue
56	WATER TANK	Blue
57	WATER TANK	Blue
58	WATER TANK	Blue
59	WATER TANK	Blue
60	WATER TANK	Blue
61	WATER TANK	Blue
62	WATER TANK	Blue
63	WATER TANK	Blue
64	WATER TANK	Blue
65	WATER TANK	Blue
66	WATER TANK	Blue
67	WATER TANK	Blue
68	WATER TANK	Blue
69	WATER TANK	Blue
70	WATER TANK	Blue
71	WATER TANK	Blue
72	WATER TANK	Blue
73	WATER TANK	Blue
74	WATER TANK	Blue
75	WATER TANK	Blue
76	WATER TANK	Blue
77	WATER TANK	Blue
78	WATER TANK	Blue
79	WATER TANK	Blue
80	WATER TANK	Blue
81	WATER TANK	Blue
82	WATER TANK	Blue
83	WATER TANK	Blue
84	WATER TANK	Blue
85	WATER TANK	Blue
86	WATER TANK	Blue
87	WATER TANK	Blue
88	WATER TANK	Blue
89	WATER TANK	Blue
90	WATER TANK	Blue
91	WATER TANK	Blue
92	WATER TANK	Blue
93	WATER TANK	Blue
94	WATER TANK	Blue
95	WATER TANK	Blue
96	WATER TANK	Blue
97	WATER TANK	Blue
98	WATER TANK	Blue
99	WATER TANK	Blue
100	WATER TANK	Blue

Details believed to be correct, but not guaranteed