

V. Operation

- If you use multiple channel transmitter, choose the channel first. (If use single channel transmitter, no need choose the channel).
- Motor running time 5 minutes. UP/DOWN switch delay time is 500ms.

Program status



Program

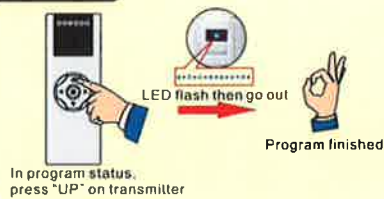

Delete one code on receiver



Change direction

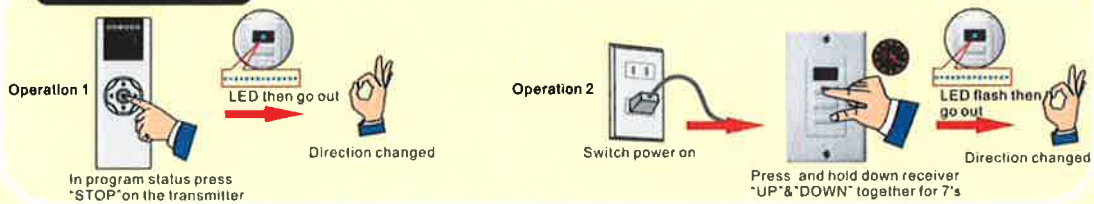

Delete all codes on receiver

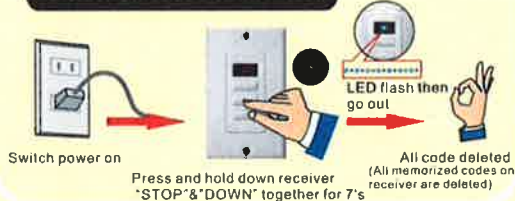

Switch "continuous run mode" to "dot move mode"



Dot move mode

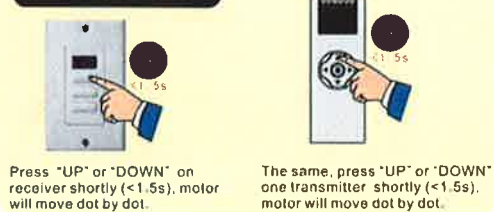

Switch "dot move mode" to "continuous run mode"

