

BASE

AISI 304 stainless steel.

VIBRATION-DAMPING BODY

Silicone rubber (MVQ) RAL 7040 grey colour, in compliance with FDA (U.S. Food and Drug Administration), giving the possibility to use in the food and medical industry.

- Hardness 55 Shore A ±5.
- High resistance to ageing.
- Resistance to high temperatures (up to 200°C) and low temperatures (-50°C).

STANDARD EXECUTIONS

- **DVF.6-SST:** AISI 304 stainless steel threaded stud.
- **DVF.7-SST:** AISI 304 stainless steel boss, threaded blind hole.

FEATURES AND APPLICATIONS

DVF.6 and DVF.7 vibration-damping elements have been designed to damp vibrations, shocks and noises produced by moving bodies or non-balanced vibrating masses of equipment and machines.

DVF.6 and DVF.7 elements are generally used as a bumper or as a limit stop for the absorption of vibrations, and for preventing:

- malfunctioning and reduction of the machine lifespan and/or of the adjacent ones;
- noise and thus also damage to health.

See Technical data and guidelines for the choice.

SPECIAL EXECUTIONS ON REQUEST

Silicone rubber (MVQ) in compliance with FDA, hardness 40, 70 Shore A ±5.



DVF.6-SST

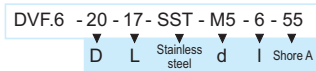
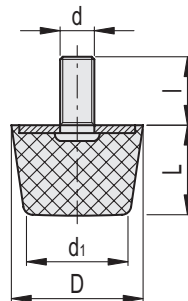

DVF.6-SST

Code	Description	D	L	d	d1	l	Max load [N]	Max. deflection [mm]	Stiffness [N/mm]	⚖️
432801	DVF.6-20-17-SST-M5-6-55	20	17	M5	10	6	197	4.25	46	14
432802	DVF.6-20-17-SST-M5-10-55	20	17	M5	10	10	197	4.25	46	15
432803	DVF.6-20-17-SST-M5-20-55	20	17	M5	10	20	197	4.25	46	17
432811	DVF.6-20-17-SST-M6-12-55	20	17	M6	10	12	197	4.25	46	16
432812	DVF.6-20-17-SST-M6-18-55	20	17	M6	10	18	197	4.25	46	17
432813	DVF.6-20-17-SST-M6-25-55	20	17	M6	10	25	197	4.25	46	19
432821	DVF.6-25-17-SST-M6-8-55	25	17	M6	19	8	580	4.25	137	18
432822	DVF.6-25-17-SST-M6-12-55	25	17	M6	19	12	580	4.25	137	19
432823	DVF.6-25-17-SST-M6-18-55	25	17	M6	19	18	580	4.25	137	20
432824	DVF.6-25-17-SST-M6-25-55	25	17	M6	19	25	580	4.25	137	21





INOX STAINLESS STEEL

DVF.6-SST

Code	Description	D	L	d	d1	l	Max load [N]	Max. deflection [mm]	Stiffness [N/mm]	⚖️
432831	DVF.6-32-22-SST-M8-10-55	32	22	M8	24	10	751	5.5	137	30
432832	DVF.6-32-22-SST-M8-16-55	32	22	M8	24	16	751	5.5	137	32
432833	DVF.6-32-22-SST-M8-23-55	32	22	M8	24	23	751	5.5	137	35
432834	DVF.6-32-22-SST-M8-30-55	32	22	M8	24	30	751	5.5	137	37
432841	DVF.6-38-35-SST-M8-10-55	38	35	M8	30	10	1311	8.75	150	70
432842	DVF.6-38-35-SST-M8-16-55	38	35	M8	30	16	1311	8.75	150	74
432843	DVF.6-38-35-SST-M8-30-55	38	35	M8	30	30	1311	8.75	150	79
432851	DVF.6-38-35-SST-M10-12-55	38	35	M10	30	12	1311	8.75	150	75
432852	DVF.6-38-35-SST-M10-20-55	38	35	M10	30	20	1311	8.75	150	79
432853	DVF.6-38-35-SST-M10-28-55	38	35	M10	30	28	1311	8.75	150	82
432854	DVF.6-38-35-SST-M10-40-55	38	35	M10	30	40	1311	8.75	150	86
432861	DVF.6-43-50-SST-M10-12-55	43	50	M10	30	12	1318	12.5	105	98
432862	DVF.6-43-50-SST-M10-20-55	43	50	M10	30	20	1318	12.5	105	101
432863	DVF.6-43-50-SST-M10-28-55	43	50	M10	30	28	1318	12.5	105	105
432864	DVF.6-43-50-SST-M10-40-55	43	50	M10	30	40	1318	12.5	105	110
432871	DVF.6-50-20-SST-M10-12-55	50	20	M10	40	12	2890	5	578	72
432872	DVF.6-50-20-SST-M10-20-55	50	20	M10	40	20	2890	5	578	75
432873	DVF.6-50-20-SST-M10-28-55	50	20	M10	40	28	2890	5	578	78
432874	DVF.6-50-20-SST-M10-40-55	50	20	M10	40	40	2890	5	578	82
432881	DVF.6-60-40-SST-M10-12-55	60	40	M10	40	12	2830	10	283	295
432882	DVF.6-60-40-SST-M10-20-55	60	40	M10	40	20	2830	10	283	301
432883	DVF.6-60-40-SST-M10-28-55	60	40	M10	40	28	2830	10	283	308
432884	DVF.6-60-40-SST-M10-40-55	60	40	M10	40	40	2830	10	283	316

DVF.7-SST

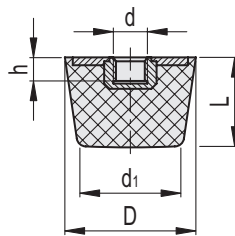

DVF.7 -20 - 17 - SST - M5 - 55
 D L Stainless steel d Shore A

INOX STAINLESS STEEL

DVF.7-SST

Code	Description	D	L	d	d1	h	Max load [N]	Max. deflection [mm]	Stiffness [N/mm]	⚖️
432901	DVF.7-20-17-SST-M5-55	20	17	M5	10	5	211	4.25	50	16
432902	DVF.7-20-17-SST-M6-55	20	17	M6	10	6	211	4.25	50	14
432906	DVF.7-25-17-SST-M6-55	25	17	M6	10	6	605	4.25	142	15
432911	DVF.7-32-22-SST-M8-55	32	22	M8	24	8	778	5.5	142	18
432916	DVF.7-38-35-SST-M8-55	38	35	M8	30	8	1455	8.75	166	74
432917	DVF.7-38-35-SST-M10-55	38	35	M10	30	10	1455	8.75	166	70
432921	DVF.7-43-50-SST-M10-55	43	50	M10	30	10	1420	12.5	114	98
432931	DVF.7-50-20-SST-M10-55	50	20	M10	40	10	3010	5	602	75
432941	DVF.7-60-40-SST-M10-55	60	40	M10	40	10	2990	10	299	125

Machine elements