



THE VERANDA RETAIL FOR LEASE

1862 Highway 324
Dacula, GA 30019

CONTACT:
Daren Wayne
770-540-7962
daren@wayne-trading.com

ABOUT THE PROPERTY

- Unique Class A Retail Development in thriving North Gwinnett County
- Great Tenant Mix
- Excellent Demographics and High Traffic Counts

LOCATION INFORMATION

- Located near the intersection of Gravel Springs Road (SR 324) and Braselton Highway (Hwy 124) in northern Gwinnett County



Radial Property Group, LLC

Office: 770-967-4625

www.RPG-CRE.com

1862 Highway 324
Dacula, GA 30019



AVAILABLE SPACES

- Suites 104 - 105 2,676 SF
- Suite 109 1,148 SF
- Suite 119 4,307 SF
(divisible)

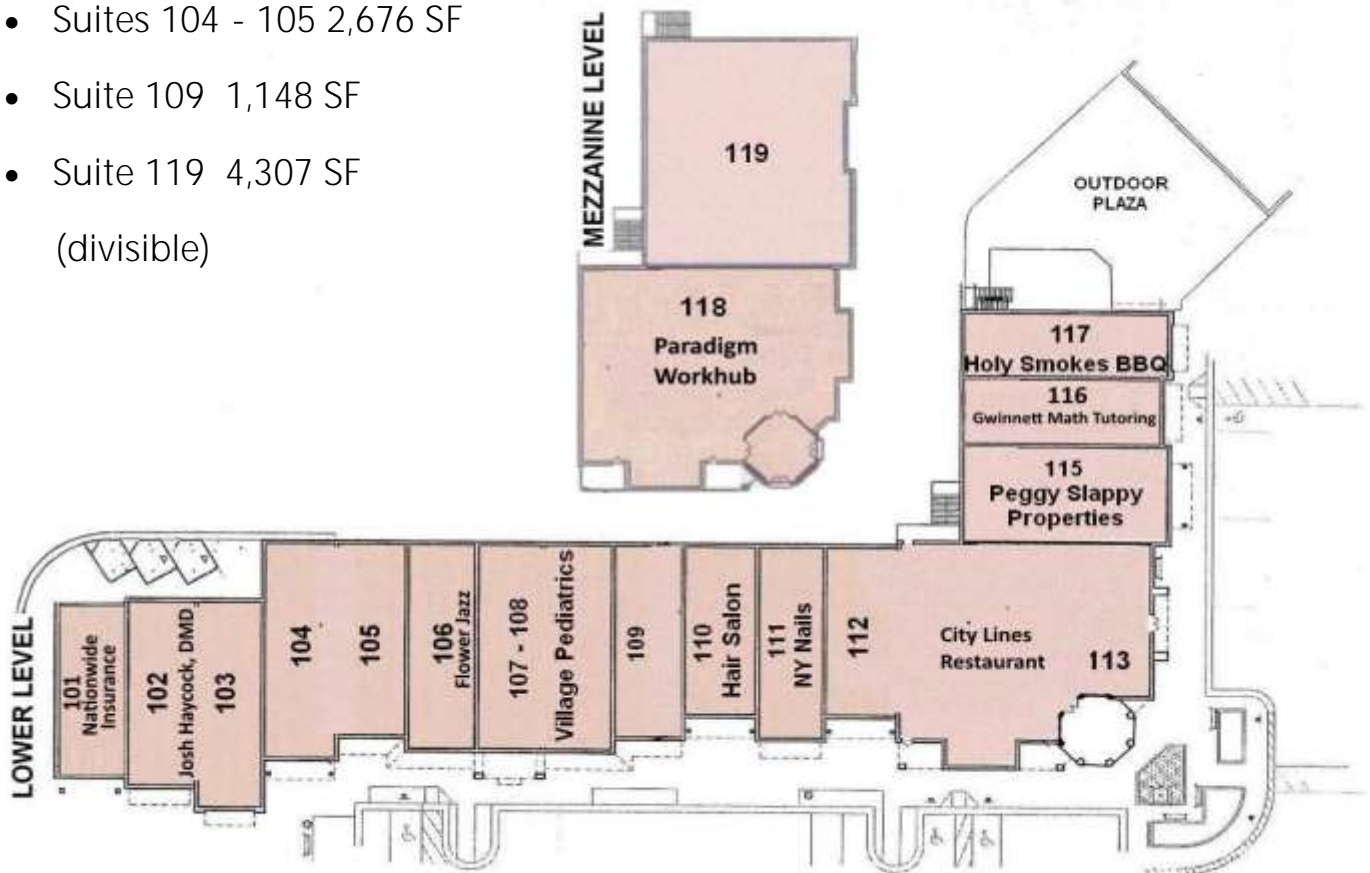

Radial Property Group, LLC

Office: 770-967-4625

www.RPG-CRE.com