

--- USER MANUAL

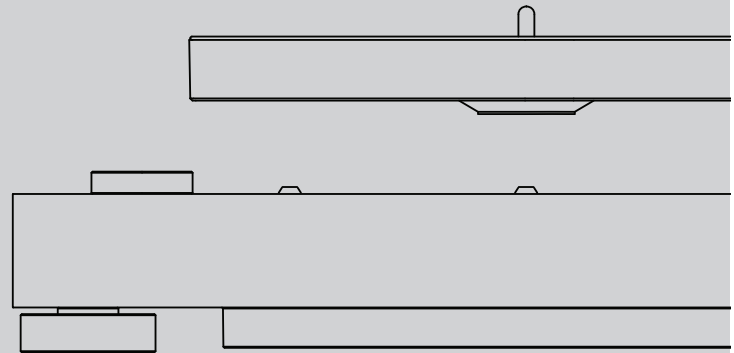

IMPORTANT:

Read the entire user manual before proceeding to unpack.

For assistance, contact our Customer Service Department at **0038641771907** or at **customersupport@maglevaudio.com**.

Index

1. INTRODUCTION	03	16. SPECIFICATIONS	41
2. SAFETY PRECAUTIONS	03	16.1. Dimensions	
3. NOTES ON USE	06	16.2. Turntable specifications	
3.1. Turntable body		16.3. Tonearm specifications	
3.2. Cartridge		16.4. Cartridge specifications	
3.3. Platter		17. TROUBLESHOOTING	42
3.4. Counterweight			
3.5. Tonearm			
4. PACKAGE CONTENTS	07		
5. PART NAMES AND FUNCTIONS	08		
5.1. Overall diagram			
5.2. Tonearm			
6. PREPARING THE SURFACE / SPACE	10		
7. UNPACKING	13		
8. SETTING UP THE TURNTABLE	17		
9. SETTING UP THE TONEARM	20		
9.1. Setting up the vertical tracking angle			
9.2. Setting up the anti-skating weight			
10. PLAYING A RECORD	26		
10.1. Playing a record			
10.2. Semi - Automatic stopping of playing a record			
10.3. Manual stopping of playing a record			
10.4. Turning, changing or removing the vinyl record			
10.5. Levitation Mode / Levitating the levitating platter			
10.6. Dust cover *			
10.7. UPS (Uninterruptible Power Supply)			
11. CARE	33		
11.1. Turntable body			
11.2. Platter			
11.3. Stylus tip			
11.4. Placemat			
12. REPLACING A CARTRIDGE	34		
13. RESET	36		
14. HARD RESET	38		
15. TRANSPORTING AND SHIPPING THE TURNTABLE	39		

1. INTRODUCTION

Thank you for purchasing this MAG-LEV Audio product.

Read through this user manual before unpacking, setting up and using this product to ensure its correct use. Also, keep this manual, along with the warranty, for future reference.

Make sure that the operating voltage of the product is correct for the country you live in.

2. SAFETY PRECAUTIONS

WARNING: to prevent fire or shock hazard, do not expose this apparatus to rain or moisture.

Caution:
Do not expose this apparatus to drips or splashes.
To avoid electric shock, do not open the cabinet.
Refer servicing to qualified personnel only.
Do not expose this apparatus to excessive heat such as sunshine, fire or the like.
Do not subject this apparatus to strong impact.
For PLUGGABLE EQUIPMENT, the socket-outlet shall be installed near the equipment and shall be easily accessible.
In case of emergency, disconnect the power cord plug of this apparatus quickly.
Do not place any objects filled with liquids, such as vases, on this apparatus.
To prevent fire, do not place any naked flame sources (such as lighted candles) on this apparatus.
Do not install this apparatus in a confined space such as a bookcase or similar unit.
Install this apparatus only in the place where ventilation is good.
Do not plug the apparatus in damaged outlets.
Do not expose any parts of this apparatus to any magnets.

For customers in the USA/Canada

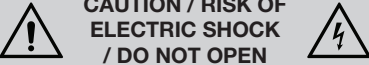

Caution: To prevent electric shock, do not remove the cover. There are no user-serviceable parts inside. Internal adjustments are for qualified professionals only. Refer all servicing to qualified service personnel.

 The lightning flash with arrowhead symbol, within an equilateral triangle, is intended to alert the user to presence of uninsulated “dangerous voltage” within the product’s enclosure that may be of sufficient magnitude to constitute a risk of shock to persons.

 The exclamation point symbol within an equilateral triangle is intended to alert the user to the presence of important operating and maintenance (servicing) instructions in the literature accompanying the product.

2.1. Important Safety Instructions

1. Read these instructions.
2. Keep these instructions.
3. Heed all warnings.
4. Follow all instructions.
5. Do not use this apparatus near water.
6. Clean only with a dry cloth.
7. Do not block any of the ventilation openings. Install in accordance with the manufacturer's instructions.
8. Do not install near any heat sources such as radiators, heat registers, stoves, or other apparatus (including amplifiers) that produce heat.
9. Do not defeat the safety purpose of the polarized or grounding plug. A polarized plug has two blades with one wider than the other. A grounding plug has two blades and a third grounding prong. The wide blade or the third prong is provided for your safety. If the provided plug does not fit into your outlet, consult an electrician for replacement of the obsolete outlet.
10. Protect the power cord from being walked on or pinched particularly at plugs, convenience receptacles, and the point where they exit from the apparatus.
11. Only use attachments/accessories specified by the manufacturer.
12. Use only with a cart, stand, tripod, bracket or table specified by the manufacturer, or sold with the apparatus. When a cart is used, use caution when moving the



cart/apparatus combination to avoid injury from tip-over.

13. Unplug this apparatus during lightning storms or when unused for long periods of time, or when not in use.
14. Refer all servicing to qualified service personnel. Servicing is required when the apparatus has been damaged in any way, such as power-supply cord or plug is damaged, liquid has been spilled or objects have fallen into the apparatus, the apparatus has been exposed to rain or moisture, does not operate normally, or has been dropped.
15. Children are not allowed to handle the apparatus unattended.
16. Children are not allowed to use the apparatus, to avoid risk of damage to hands, fingers and other body parts due to strong magnets in the product.
17. Do not insert any parts of the body between the turntable body and the levitating platter when the apparatus is turned on.
18. People with heart pacemakers are not allowed to handle the apparatus or operate the platter. They should also keep a distance of at least 1m or 3.3 feet from the apparatus or the platter, to avoid magnets in the apparatus and platter from interfering with the heart pacemaker.
19. When handling the platter, do not place it near or on any metal parts in the vicinity, to avoid the magnets sticking to any metal parts. This could result in damage to yourself, magnets or the platter.

20. When handling the platter do not come closer than 4 cm to the body of the turntable or the height of the platter feet. If coming closer than the previous mentioned distance the force of magnets becomes too strong to handle.

WARNING:



The risk of physical injury when handling the product, due to strong force of magnets

IMPACTS AND HITS

Large magnets have a strong attractive force. Improper handling can damage your fingers or skin that gets caught between the magnets and metals. This can lead to damage of body parts and other monetary damage. Large magnets can cause body part breakage.



Heart pacemakers

Magnets can influence the heart pacemaker and heart defibrillator:

- heart pacemaker can switch to a test mode, which causes improper functioning
- heart defibrillator can stop working
- do not come closer than 1m (3 feet) to the apparatus
- warn others, who are wearing such devices, not to come closer than 1m (3 feet) to the apparatus



Metal parts

Neodim magnets are fragile. When crashing among each other, magnets can break and get damaged. Sharp debris can fly a few meters away and can harm the eyes if in contact. Avoid magnets crashing together make sure to take necessary precautions when handling magnets under dangerous circumstances.



Magnetic field

Magnets create a long-distance, strong magnetic field. Such field can harm TVs, laptops, hard drives, bank cards, storage units, mechanical watches, hearing aids and speakers. Make sure to keep magnets away from devices and objects, which can be affected with a strong magnetic field.



Influence on people

Based on current knowledge, magnetic fields from permanent magnets do not have a measurable positive or negative effect on people. It is not likely that permanent magnets present a health risk. However it is not possible to be completely sure.

- for your safety, avoid constant contact with the magnets
- make sure to keep strong magnets at least 1m (3 feet) away from your body

CAUTION:



Risk of body injuries

When connecting this product to a public commuted telephone network, use only the telecommunication cable (RJ-11) 26 AWG or larger to reduce the risk of fire. For Australian users, the cable must be approved by the Australian Communications and Media Authority.

If the levitating platter falls down from platter feet or from a levitating position onto a turntable body, it sticks to the surface, due to strong magnets. When removing the platter after it has fallen, be sure to be in a stable position and carefully pull it away from the turntable body, strongly gripping the platter.



Risk of overturning

In the event of an impact of the platter with a table or a direct impact to a floating platter, the platter can fall from the platter feet or from a levitating position onto the cover of the turntable, which can damage the feet, or the surface of the cover or the platter itself may be damaged. There is also risk of damage to body parts.

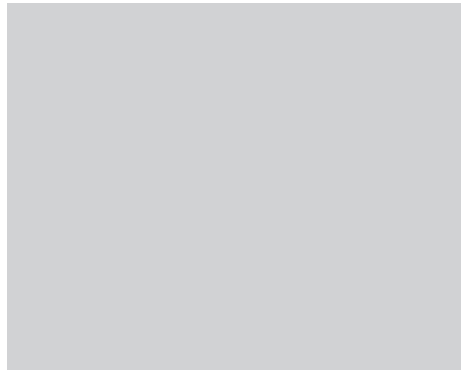

3. NOTES ON USE

3.1. Turntable body (page 08)

Do not set and use the product in locations that are considerably hot or humid, dirty, or subject to extreme vibrations.
The product should be positioned on a flat, level surface.

3.2. Cartridge (page 09)

Attach the provided protector to the cartridge when the product is not in use.
Do not touch the stylus of the cartridge with

your finger.
Do not allow the stylus to bump against the platter, mat, or edge of the record.
Always adjust the cartridge while platter is resting on raised platter feet, with the apparatus in off mode.

3.3. Platter (page 08)

When taking out or handling the platter, grip the platter with both hands and always keep it away from any metal or magnetic objects, cell phones, tvs or any other electronic equipment.

Do not place it anywhere on the turntable, but on platter feet in raised state.
Do not touch the platter when in use.
Do not scratch the reflecting mirrors on the bottom of the platter.
Do not place any other objects on the platter besides the vinyl records and place mats.

3.4. Counterweight (page 09)

When packing the apparatus into the box, always remove the tonearm weight by unscrewing it.

3.5. Tonearm (page 09)

When packing the apparatus into the box, always secure the tonearm with the provided attachment to stabilize it during transport.
Always adjust the tonearm with great care and

follow the instructions for adjusting the tonearm.
Always use the tools provided for tonearm adjustments.

A note about recycling



This product's packaging materials are recyclable and can be reused.
Please dispose of any materials in accordance with the local recycling regulations.

When discarding the unit, comply with local rules or regulations.
Magnets should never be thrown away or incinerated but disposed of in accordance with the local regulations concerning magnets disposal.

4. PACKAGE CONTENTS

Make sure that you have all the included items listed below before using this product. Do so after you have unpacked the product following the instructions on page 11.

If some items are missing or damaged, contact our Customer Service Department at **0038641771907** or **customersupport@maglevaudio.com**. If you have purchased the product

from a local distributor or dealer, please contact them to resolve any issues.

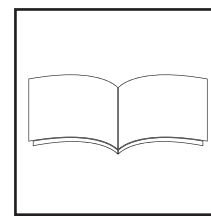

User manual

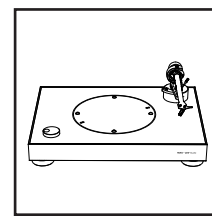

Turntable body

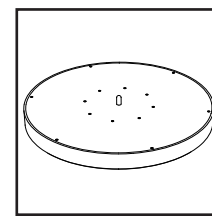

Platter

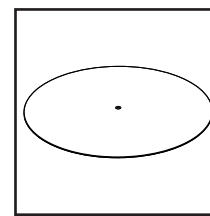

Platter mat

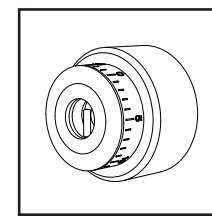

Counterweight

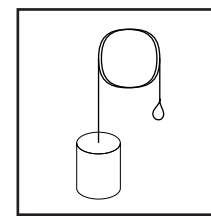

Anti-skating weight

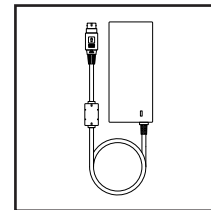

Power adapter

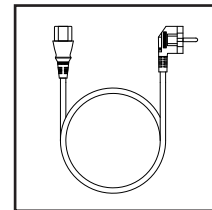

Power cord

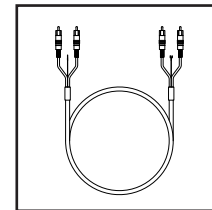

RCA Audio cable

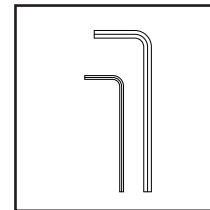

Inbus key 2x

5. PART NAMES AND FUNCTIONS

5.1. Overall diagram

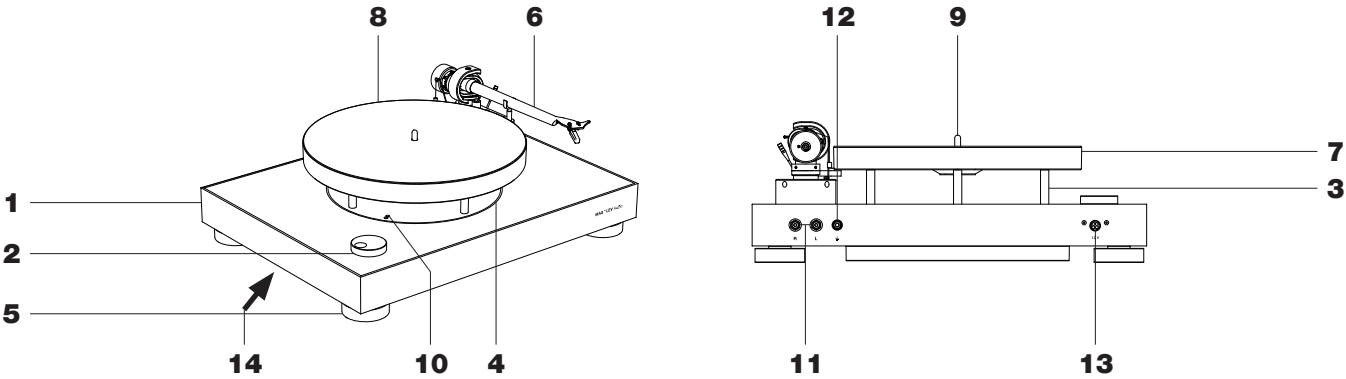

- | | | |
|--|---|---|
| 1 Turntable body
Aluminum frame, plastic housing | 7 Levitating platter
9a Bottom channel for platter feet
9b Reflective mirrors in the channel | 13 DC inlet
Insert a power cable here |
| 2 Control Button
OFF/33.3 RPM/45 RPM/Levitation | 8 Platter mat | 14 Reset button
Under the turntable (page 38) |
| 3 Platter feet | 9 Spindle | |
| 4 LED light ring | 10 Sensors
Reading the speed of rotation | |
| 5 Turntable feet | 11 Analog RCA outlet | |
| 6 Tonearm
For details, refer to "Tonearm" on page 09 | 12 Grounding connector | |

5.2. Tonearm

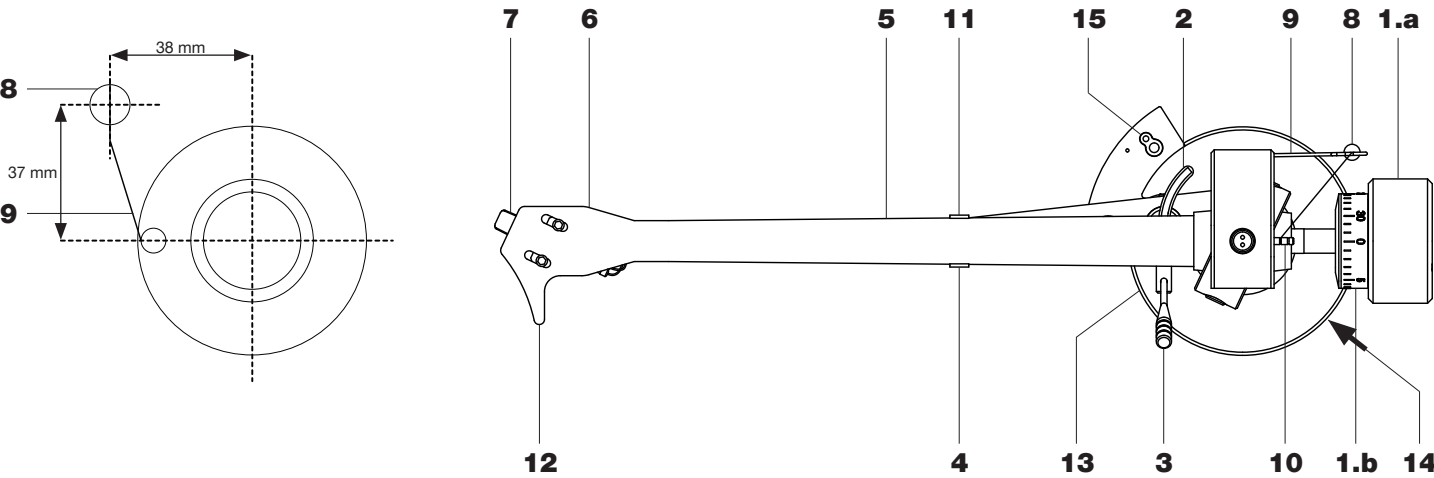

- | | | |
|---|---|--|
| 1.a Counterweight
Balances the tonearm and adjusts to provide the proper tracking force | 4 Tonearm rest | 9 Anti-skating weight support hoop |
| 1.b Downforce scale
Adjusts the downforce of the tonearm | 5 Tonearm tube | 10 Anti-skating weight adjustment scale |
| 2 Tonearm lift
Moves the tonearm vertically to and from the face of the record | 6 Headshell | 11 Removable transport lock |
| 3 Tonearm lift lever / cueing lever
Operates the tonearm lift | 7 Cartridge | 12 Finger lift |
| | 8 Anti-skating weight with wire
While the record is playing, a force acts on the stylus tip to pull it inward. This force can be counteracted by setting the same values for anti-skate and the tracking force. | 13 Tonearm base |
| | | 14 Tonearm base adjustment screw |
| | | 15 Tonearm lift sensors |

6. PREPARING THE SURFACE / SPACE

**MAKE SURE TO USE
THE CORRECT
TOOLS TO
MAKE SURE THE
SURFACE IS LEVEL.**

1. Make sure you set up the surface you wish to put the apparatus on is level and make sure the surface is flat.
2. The product should always be placed on a surface with enough area to fit the product feet fully on the surface.
3. Make sure the table, cabinet or surface has no metal parts that interact with magnets. Be certain to check on, next to and under the surface to make sure there are no metal parts in the vicinity that would cause interference with the turntable. (we suggest wooden surfaces)
4. Any metal or magnetic parts should be at least 50cm or 20" away from the turntable.

5. Make sure the speakers, preamps, amplifiers and other electronic equipment is positioned at least 50cm or 20" away from the turntable.
6. To avoid effects of vibrations and acoustic pressure, do not mount the product next to such items as speakers.
7. The product may pick up radio static if placed next to a radio. Therefore, try to keep the product away from radios.
8. If the product is near equipment (cell phone, etc.) that emits strong radio waves, noise may occur.

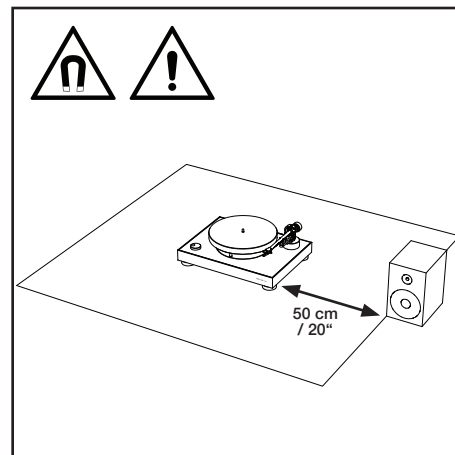

7. UNPACKING

Read the entire user manual before unpacking the apparatus.

Always follow instructions when unpacking the apparatus.

Make sure you set up the surface you wish to put the apparatus on in a level position and make sure the surface is flat before unpacking.

The product should always be placed on a surface with enough area to fit the product feet fully on the surface. Optimum recommendation (width x depth): 480 mm x 450 mm / 19" x 17,7".

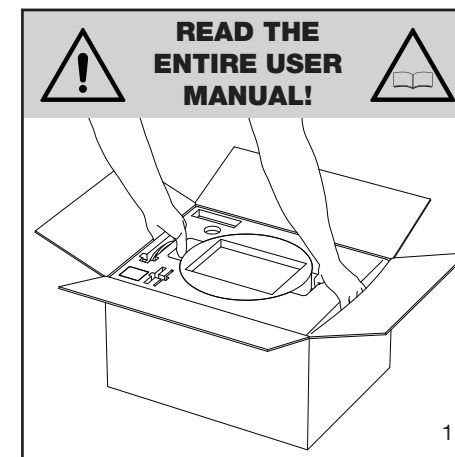

Remove the top half of the Styrofoam box. Grip on the sides with both hands and lift vertically out of the cardboard box. Place it on a solid and flat surface.

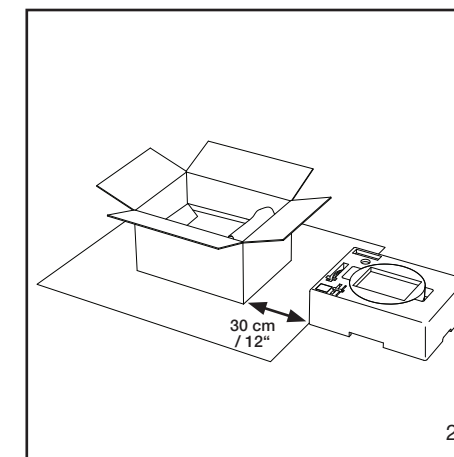

Place it at least 30 cm from the package.

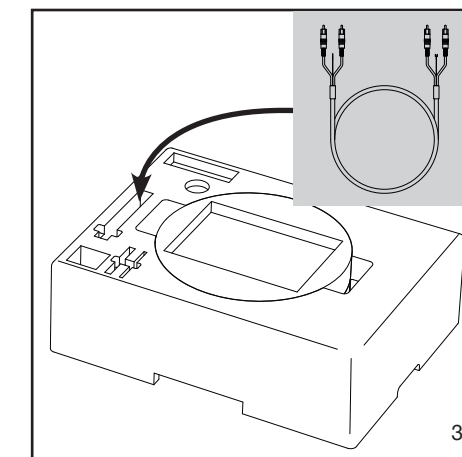

Take out the RCA cables and remove the ties.

REMOVE THE PROTECTIVE
FOAM SHEET/BAG.

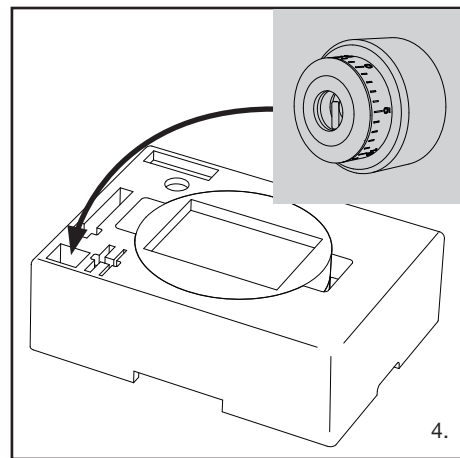

Take out the box with the tonearm weight.

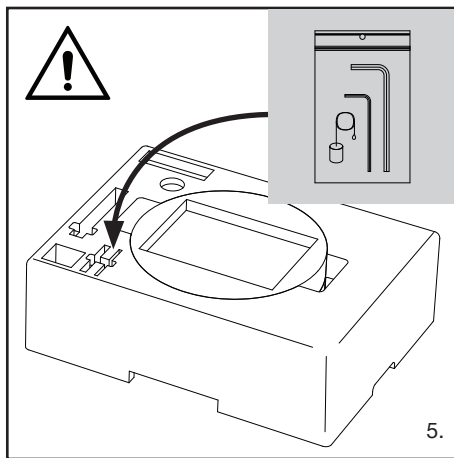

Take out the small bag with tools and anti-skating weight.

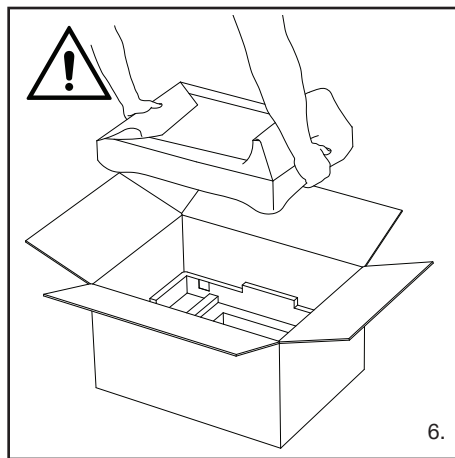

Take out the body of the turntable with both hands and place it at least 30cm (1 foot) away from the platter (top part of the Styrofoam box).

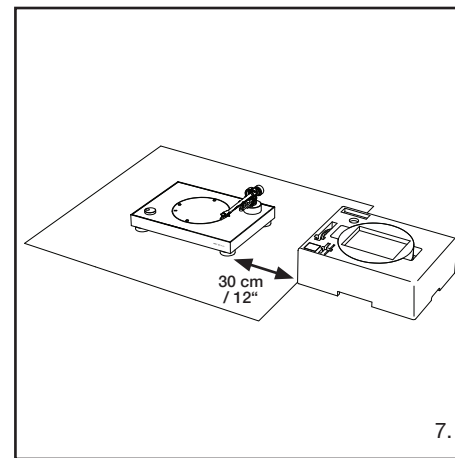

Place it at least 30 cm from the package.

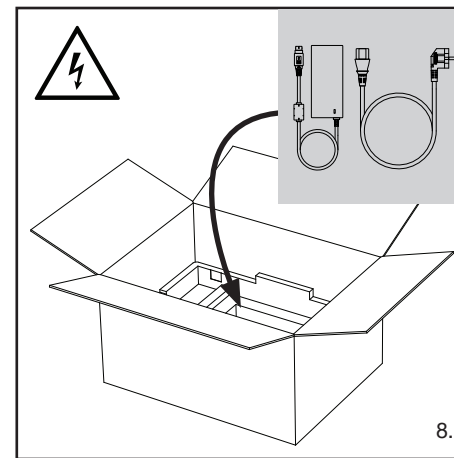

Take out the box in the middle with the power adapter inside. (brown box)

Take out the power cord.

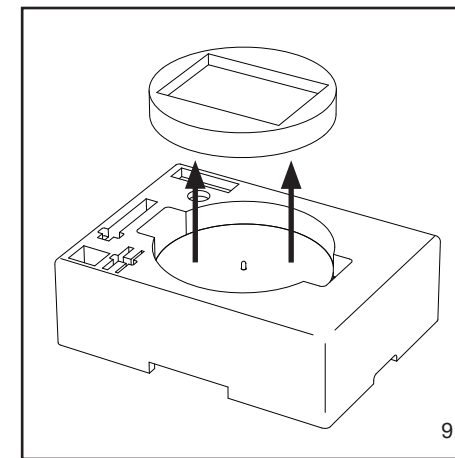

Remove the circular Styrofoam part from the middle.

MAKE SURE IT IS
THE RIGHT POWER
CORD FOR YOUR
COUNTRY!

REMOVE THE PROTECTIVE
FOAM SHEET/BAG.



WARNING



LEAVE THE PLATTER INSIDE THE TOP PART OF THE STYROFOAM BOX, UNTIL YOU HAVE SET UP THE TURNTABLE AND YOU ONLY HAVE LEFT TO PLACE THE PLATTER ON THE TURNTABLE FEET (PAGE 18).

10.

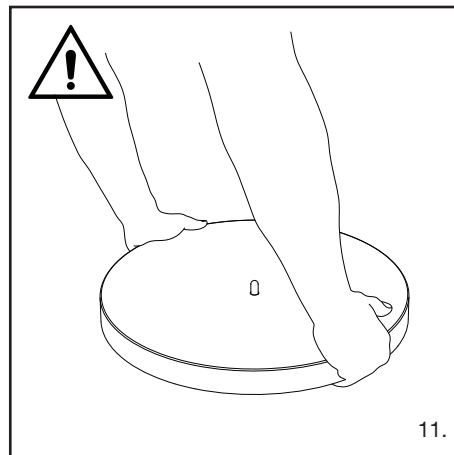

11.

When taking out or handling the platter, grip with both hands and always keep it away from any metal or magnetic object, cellphones, tvs or any other electronic equipment. (minimum 50cm or 20" distance)



WARNING



BEFORE SETTING UP THE PLATTER ON RAISED PLATTER FEET READ PAGE 18.

After purchase, we suggest that you save all packaging materials for possible future storage, moving, or shipping. Warranty and returns are valid if sent back in the original packaging and packed properly. Follow the instructions in case of repacking (page 39).

12.



THIS PRODUCT REQUIRES SOME ASSEMBLY BEFORE USING IT FOR THE FIRST TIME. DO NOT CONNECT THE POWER CABLE UNTIL ASSEMBLY IS COMPLETE.

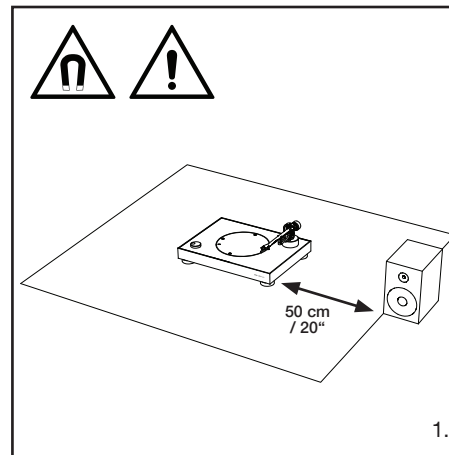

1.

Place the turntable body (2) on the pre-prepared surface.



MAKE SURE THE OUTLET YOU WISH TO PLUG THE APPARATUS IN, IS IN GOOD CONDITION.



Before connecting the power adapter, make sure the power adapter is suitable for the voltage in your country.

Plug in the power cord directly to the outlet.

Do not use extensions or dividers.

2.

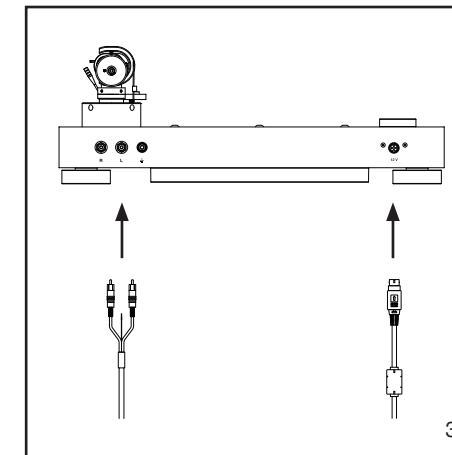

3.

Follow the instructions on the next page to connect the turntable properly.

Schematic visualisation on page 16.



IT IS EXTREMELY IMPORTANT TO FOLLOW THE STEPS ON HOW TO CONNECT THE TURNTABLE. IF THE STEPS ARE NOT FOLLOWED, IT CAN CAUSE DAMAGE TO THE TURNTABLE.

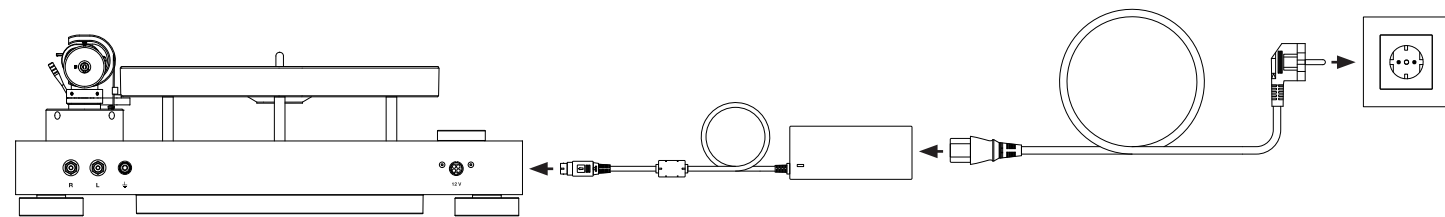

1. step

Plug the power cable into the DC inlet.

2. step

Connect the power adapter and power cord.

3. step

Plug the power plug into the outlet.

Power adapter with power cord
AC input: AC100-240 V / 50-60 Hz / 2.0 A
DC output: 12V / 0.5 A

Operating temperature at normal playing condition (room temp. 25°C) is approximately 35°C.

BE SURE TO LEAVE THE APPARATUS PLUGGED IN FOR A MINIMUM OF 60 MINUTES BEFORE FIRST USE, FOR THE APPARATUS TO WORK AS INTENDED.

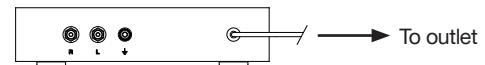

Connectable equipment
(Amplifier, etc.)

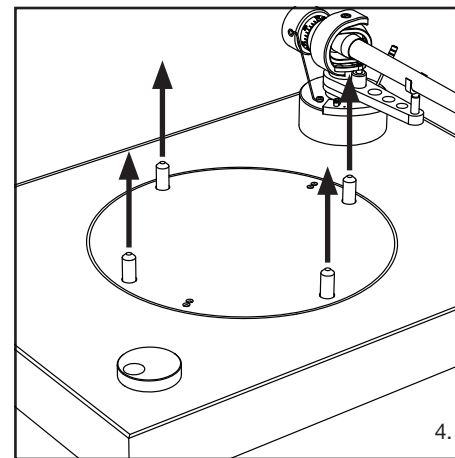

When the turntable is plugged into the electric power grid for the first time, the platter feet will rise out of the turntable body into set up position.

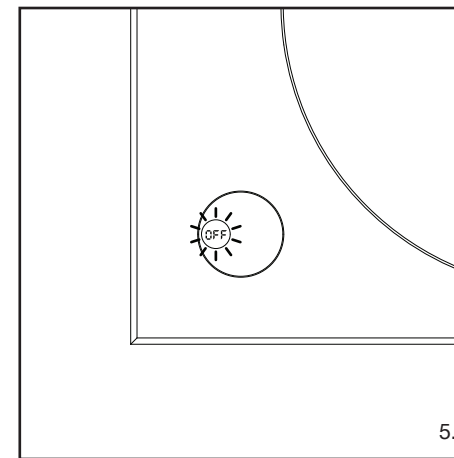

When the light in the control button stops blinking, the turntable body set up is finished.

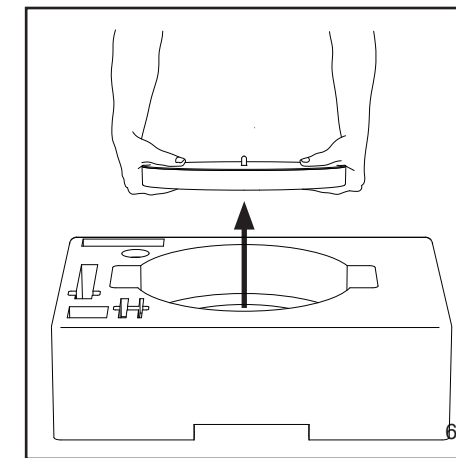

Lift the levitating platter vertically out of the upper half of the Styrofoam box.

REMOVE THE CIRCULAR STYROFOAM PART FROM THE UPPER HALF OF THE STYROFOAM BOX.

REMOVE THE PLASTIC BAG FROM THE LEVITATING PLATTER.



WARNING

HAVE A STRONG GRIP ON THE PLATTER, DUE TO THE STRONG FORCE AND PULL OF THE MAGNETS IN THE TURNTABLE BODY AND THE LEVITATING PLATTER.



WARNING



BE CAREFUL EXECUTING THIS STEP. THERE IS RISK OF BODILY INJURY.

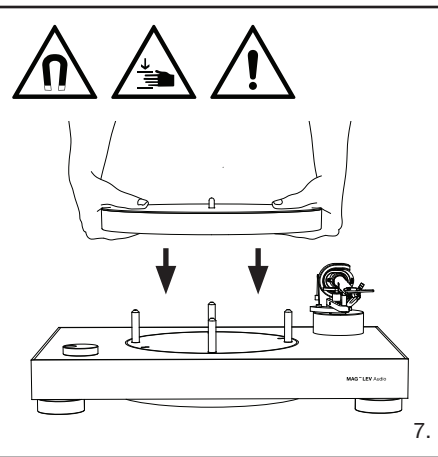

Hold the levitating platter with both hands and grip firmly.

Firmly gripping the platter, start lowering the platter on the platter feet, slowly and vertically.

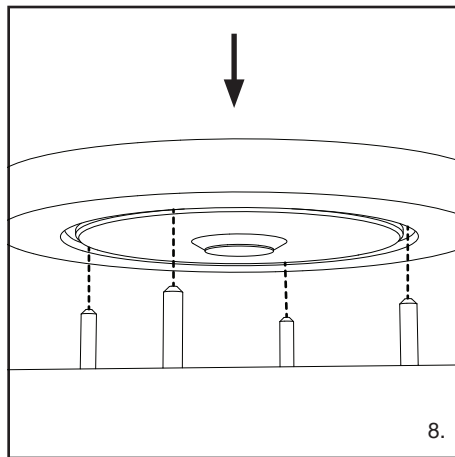

Place the channel on the bottom of the platter onto all four platter feet, carefully and patiently.

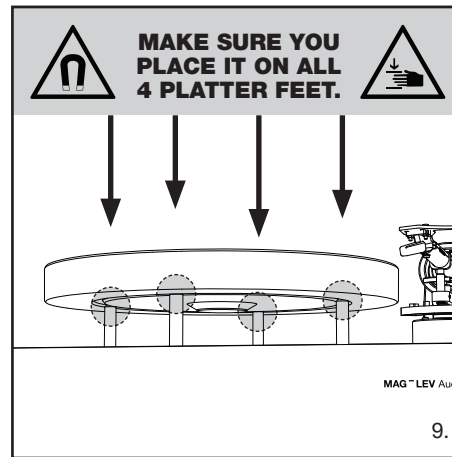

Make sure that the platter feet are fully in the channel and you feel no force of the magnets, then let go of the platter.

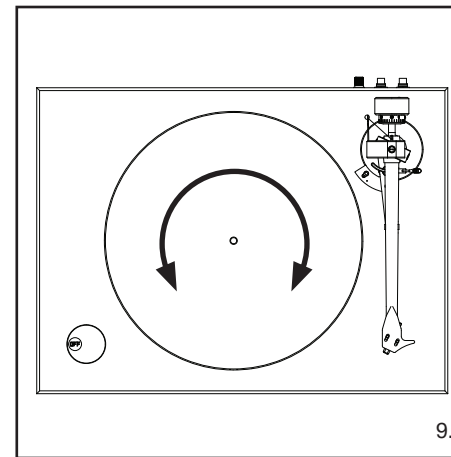

You can help make sure all 4 feet are in the channel by rotating the platter around its axis. If all 4 platter feet are not in the channel, you won't be able to turn the platter with ease and you will feel a force of the magnets pulling the platter toward the body.

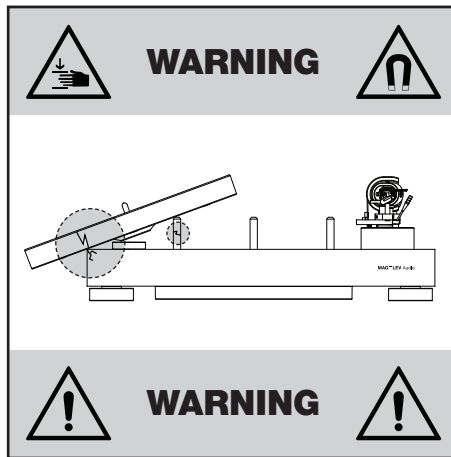

If the platter is not properly set up, the platter will fall down due to strong magnets! In this case there is risk of bodily injuries and damages to the turntable.

9. SETTING UP THE TONEARM

In order for the cartridge to pick up sound correctly from the record's grooves, the tonearm's balance and tracking force must be adjusted to fit the specifications of the cartridge's. If the tonearm's balance and tracking force are not properly adjusted, the record or the cartridges stylus may become damaged.

Do not drag the cartridge's stylus across the record or mat when adjusting the tonearm's balance or tracking force. Doing so may damage the stylus.

Adjust the downforce prior to installing the anti-skating weight.

You have to set the counterweight on your own as it is necessary for it to be packed separately, to ensure the safety of the product.

WHILE HOLDING THE HEADSHELL, REMOVE THE CABLE TIE USED TO SECURE THE TONEARM AT THE TIME OF DELIVERY.

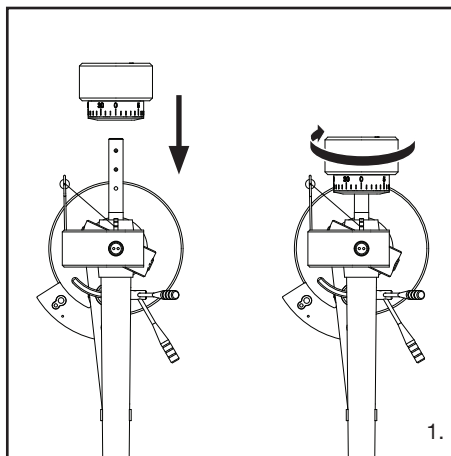

With the tracking force gauge ring facing forward attach the counterweight to the back of the tonearm, and slowly turn it counterclockwise (to the left)

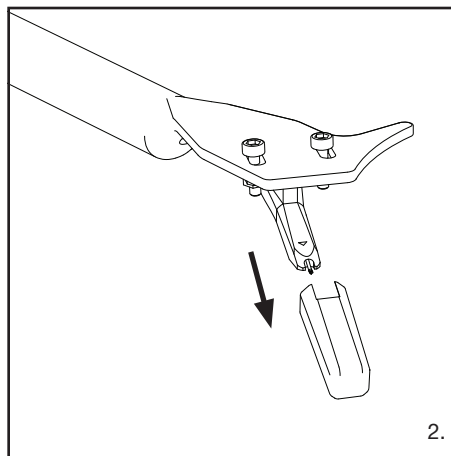

Remove the cartridge's protector, by pulling straight forward. Applying a downward force may cause the stylus to come off the body. Only low volume is output if the stylus has come off, or is about to come off, so refer to "Replacing the stylus" (page 34) to reattach the stylus correctly.

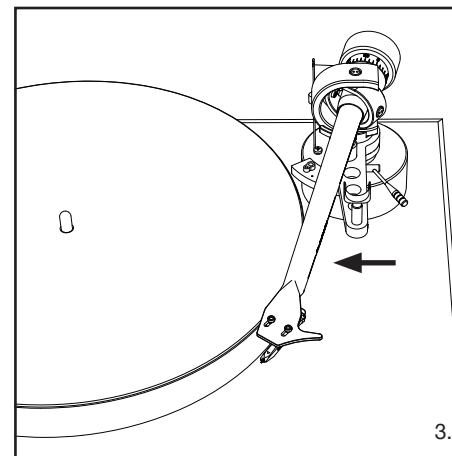

Move the tonearm out of the tonearm rest.

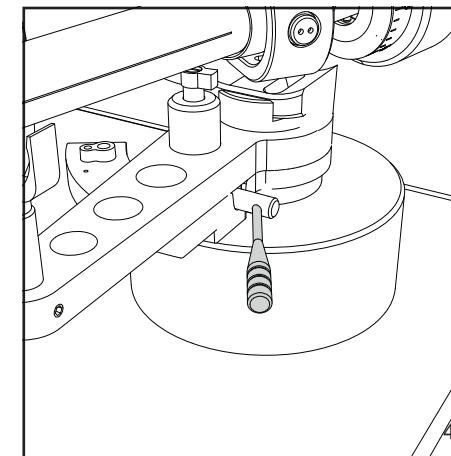

Make sure the cueing lever is in downward position.

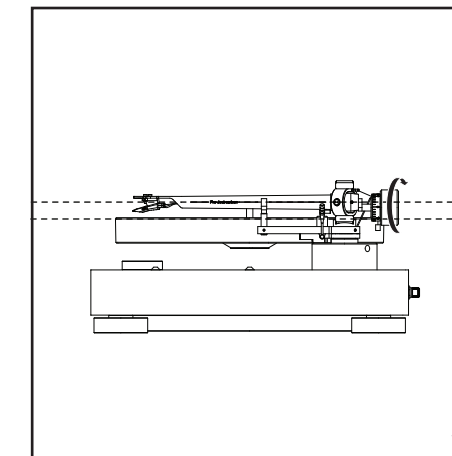

Turn the counterweight until the tonearm is parallel to the platter.

For other cartridges follow the instructions of cartridge manufacturers.

1.a Counterweight

Balances the tonearm and adjusts to provide the proper tracking force.

1.b Downforce scale

Adjusts the downforce of the tonearm.

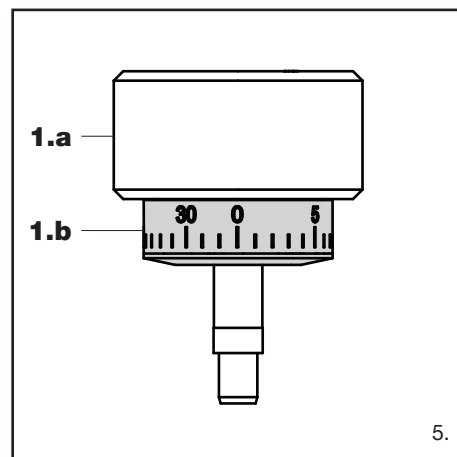

While supporting the counterweight so that it does not move, turn the tracking force gauge ring so that its “0” position lines up with the centerline on the back of the tonearm (the tracking force is not adjusted simply by turning the tracking force gauge ring).

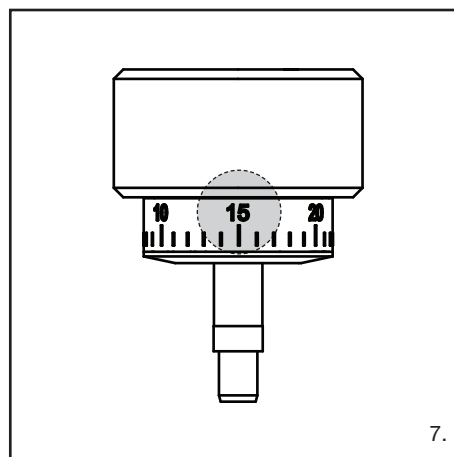

Let go of the downforce scale and rotate the counterweight between 15-16 (**for Ortofon OM10**).

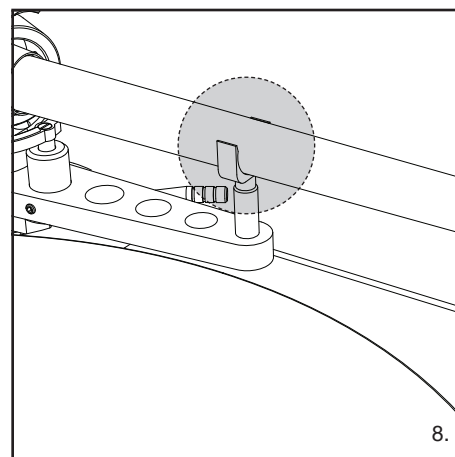

Return the tonearm to the tonearm rest.

9.1. Setting up the vertical tracking angle - Vertical tracking angle (VTA and SRA)

VTA and SRA are already set for the mounted Ortofon OM10. If you wish to change the cartridge or have bought the turntable without one, please read the following instructions.

Refer to the image below if you need to readjust the setting for Ortofon OM10. If you are installing another cartridge, refer to manuals from manufacturers of the cartridges you wish to use.

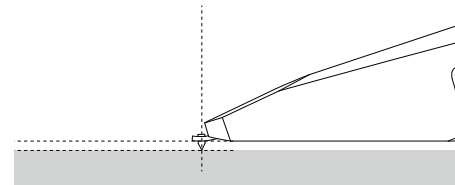

The goal is to bring the diamond tip, in relation to the grooves of record surface, to the same position as the original cutter head's diamond tip. To optimise this we need to set up the cartridge's diamond tip in the grooves at a

specific angle.

To adjust the height of the tonearm, use the large inbus key, unscrew the two screws at the back of the tonearm base and adjust the height

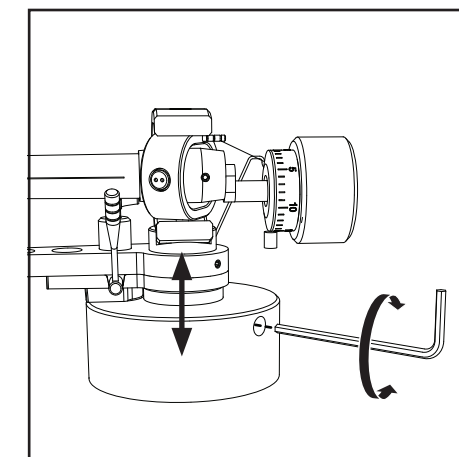
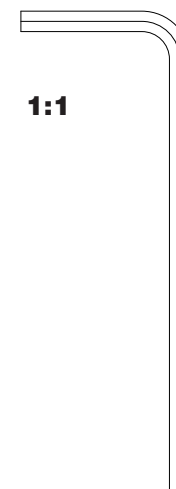

accordingly. Make sure to have the turntable in a levitating position to achieve the correct result. Refer to manuals from manufacturers of the cartridge you wish to use.

Refer to the image below if you need to readjust the setting for Ortofon OM10. If you are installing another cartridge, refer to manuals from manufacturers of the cartridge you wish to use.

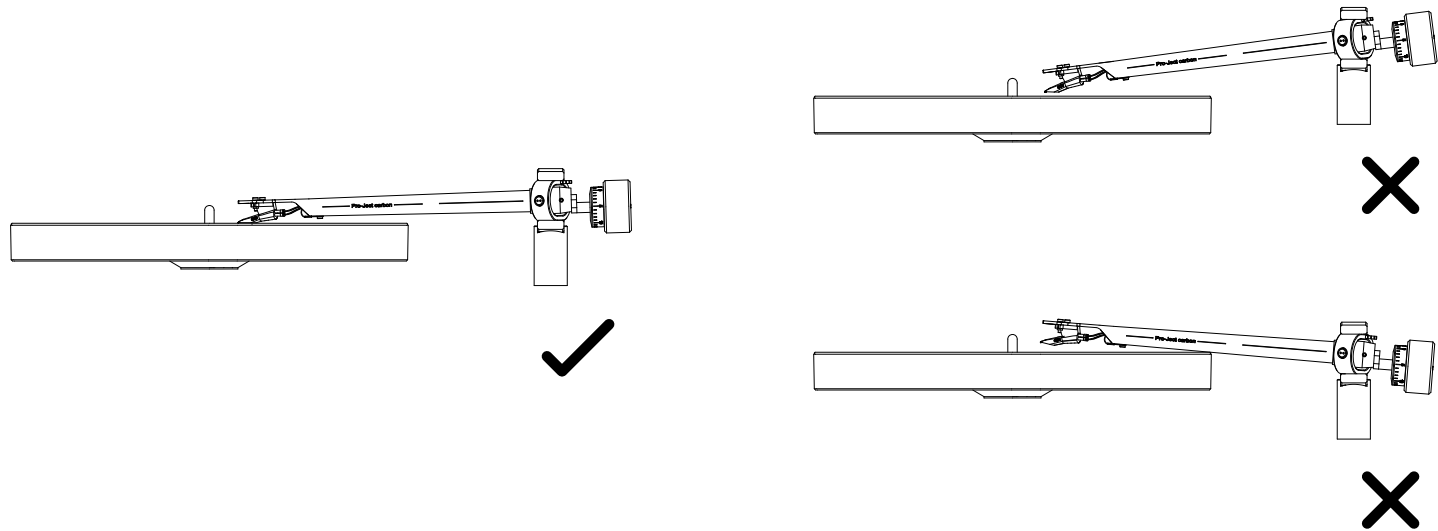

As you can see there are two different angles serving the same purpose. VTA and SRA. These angles are affected by the height of the tonearm and tracking force. The height of the tonearm raises the actual pivot point of the cantilever

(SRA). The higher the tonearm on the armboard, the bigger the SRA and VTA. Changing the tracking force changes VTA due to cantilever suspension. With a lighter tracking force, the cantilever is pushed up less and VTA and SRA

are bigger. In reality different cartridges have variations in design and SRA can be around 85-95 deg while VTA is 18-25 deg.

9.2. Setting up the anti-skating weight (page 09, part 10)

You have to set the anti-skating weight on your own as it is necessary for it to be packed separately, to ensure the safety of the product.

The anti-skating force must be adjusted according to the mass of the cartridge as follows: Pro-Ject 9cc

For Ortofon OM10, use the 2nd groove.

Downforce	Groove in the stub (10)
10 - 14mN	1 st from bearing rings
15 - 19mN	2 nd " " "
20mN and bigger	3 rd " " "

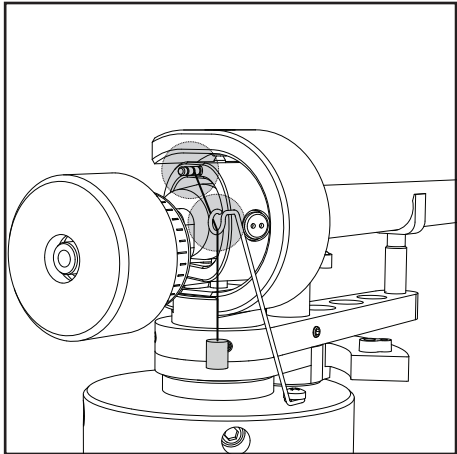
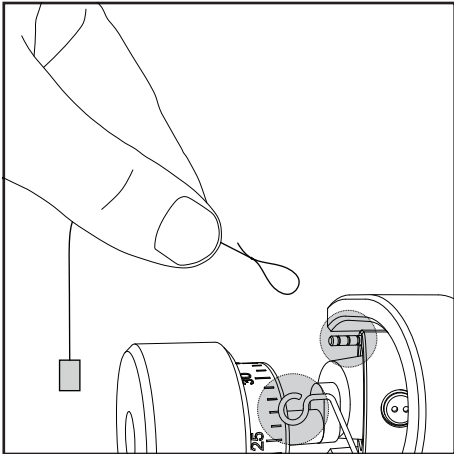

Hang the loop of the thread of the anti-skating weight (8) in the groove of the anti-skating stub (10) corresponding to the downforce applied to your cartridge and feed the thread through the loop of the wire support (9).

10. USING THE TURNTABLE

10.1. Playing a record

If using small 45rpm vinyl records with a large center hole, place the 45rpm adapter on the spindle, before placing the record.



WARNING



ONLY PLACE, CLEAN, SWITCH AND TURN THE VINYL RECORDS WHEN THE LEVITATING PLATTER IS RESTING ON PLATTER FEET.

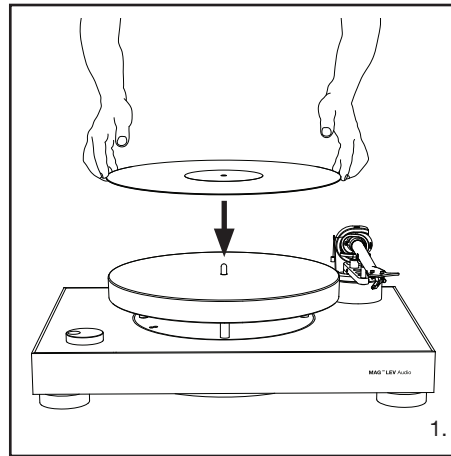

Place the vinyl record onto the platter so that the center hole aligns with the spindle.

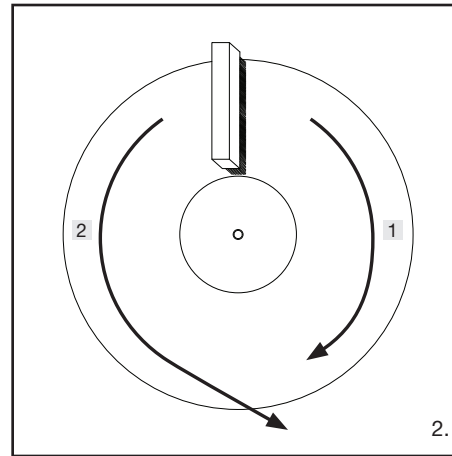

Clean the vinyl record with a brush for vinyl records with a gentle motion following the grooves in the record. Finish with a diagonal motion towards the edge of the record. Only clean the vinyl records on the platter, when the platter is resting on the platter feet.

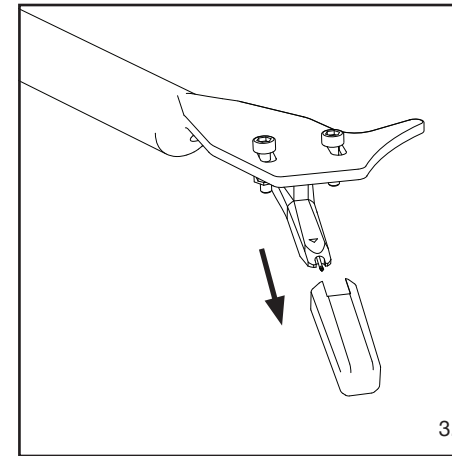

Remove the cartridge's protector, by pulling straight forward. Applying a downward force may cause the stylus to come off the body. Only low volume is output if the stylus has come off, or is about to come off, so refer to "Replacing the stylus" on page 34 to reattach the stylus correctly.

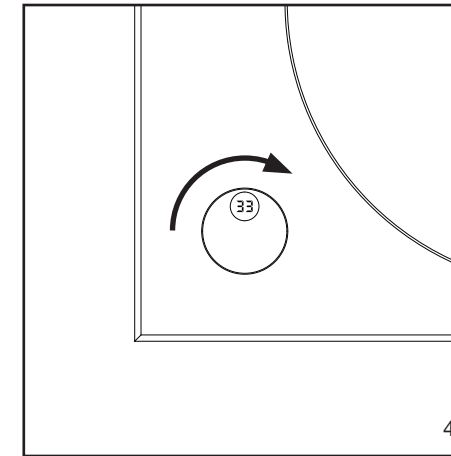

Turn the control button clockwise from OFF mode (9 o'clock) , to 33 (33.3 rpm – 12 o'clock) or 45 (45 rpm – 3 o'clock), depending on the speed the record is supposed to be played at. This turntable only plays 33.3 rpm and 45 rpm records.

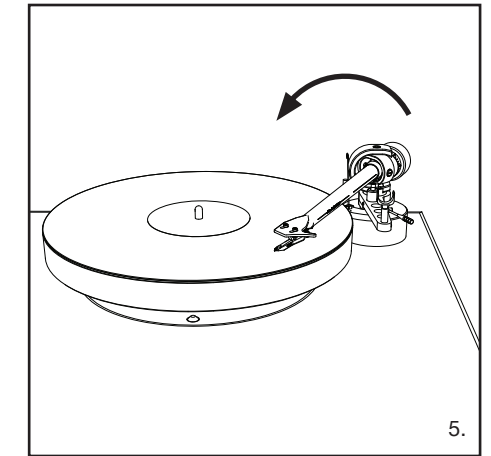

Lift the tonearm from the tonearm rest, and move it toward the vinyl record. Place the cartridge of above the track on the vinyl record you wish to listen to. Make sure you place the stylus above the vinyl record, to not damage it.

Make sure the cueing lever is in downward position (page 21).

10.2. Semi - Automatic stopping of playing a record

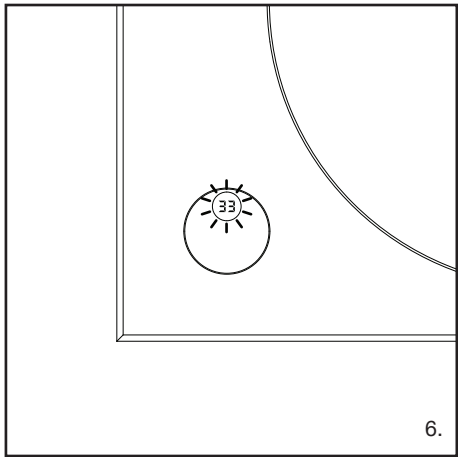

When the levitating platter reaches the correct speed and stabilizes, the light in control button will stop blinking and the tonearm will lower itself and place the stylus on the record.

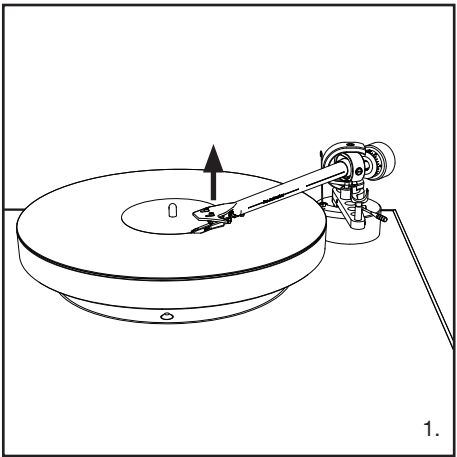

30 seconds after the tonearm reaches the end of the record, the tonearm will lift itself and the levitating platter will slowly stop rotating.

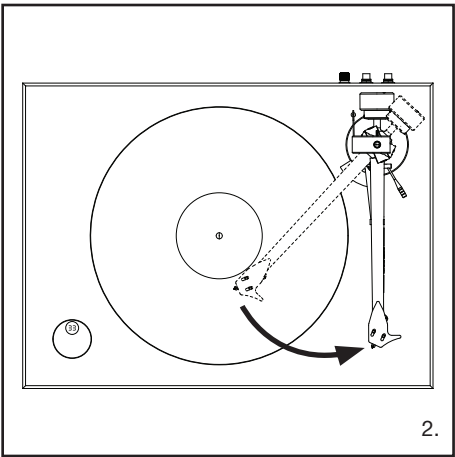

After the tonearm has lifted, move the tonearm back into the tonearm rest.

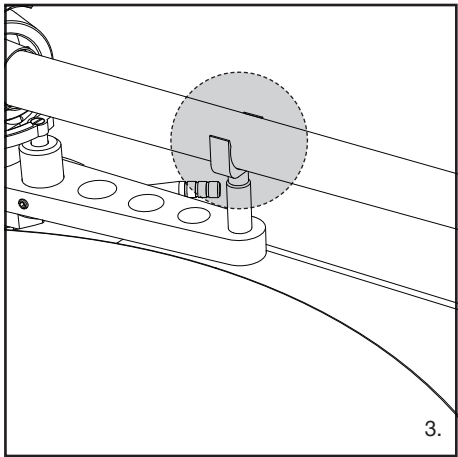

Make sure to place it completely inside the tonearm rest and not only above it.

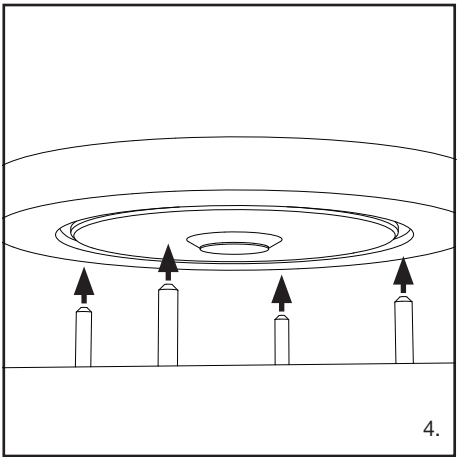

The platter feet will automatically rise and hold the levitating platter.

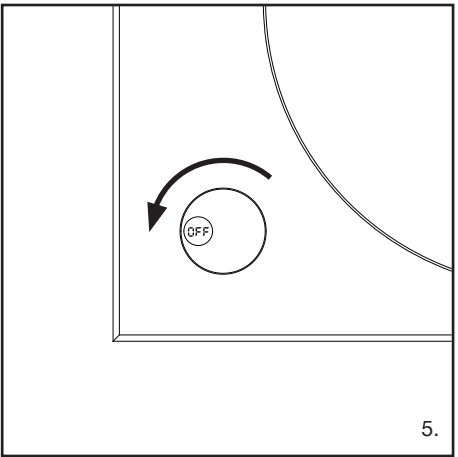

Move the control button anti-clockwise to OFF mode.

10.3. Manual stopping of playing a record

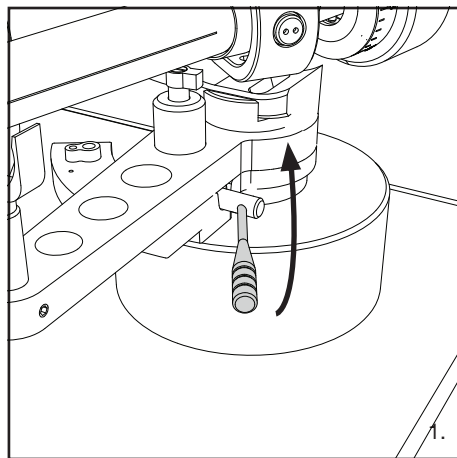

When you wish to manually stop the playing of a record, lift the cueing lever.

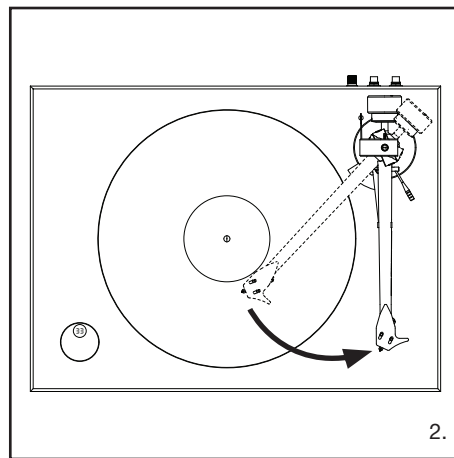

Move the tonearm back into the tonearm rest.

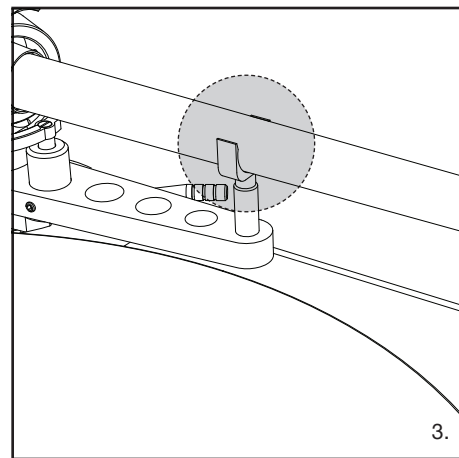

Make sure to place it completely inside the tonearm rest and not only above it.

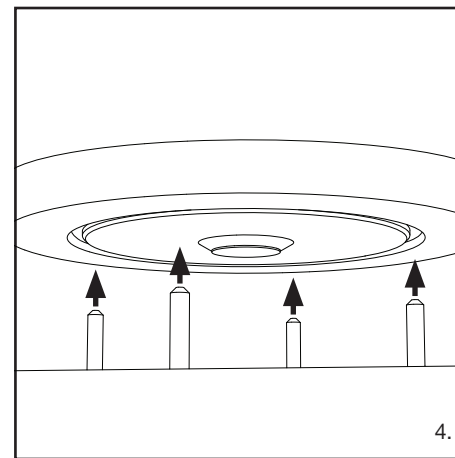

The platter feet will automatically rise and hold the levitating platter.

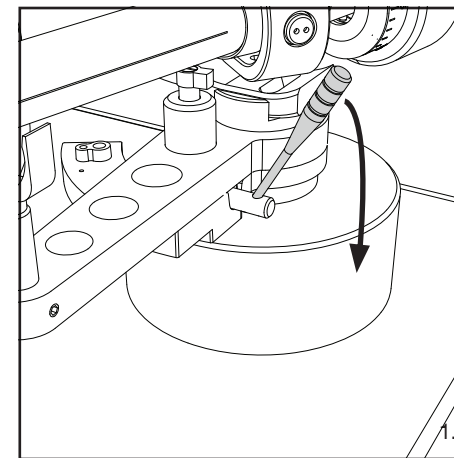

Lower the cueing lever.

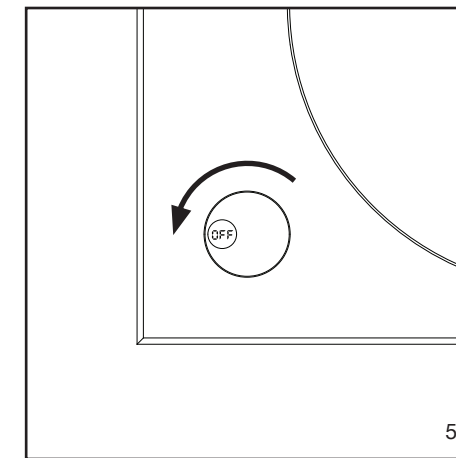

Move the control button anti-clockwise to OFF mode.

10.4. Turning, changing or removing the vinyl record

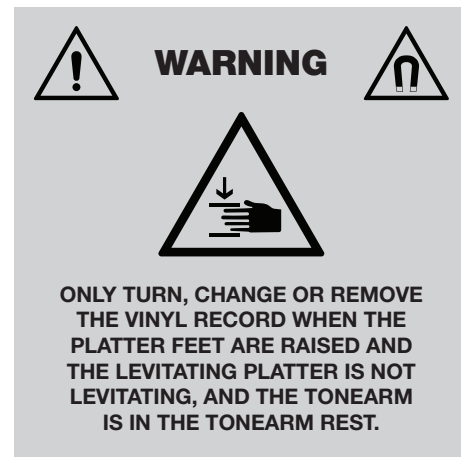

Remove the vinyl record by gently pressing on the spindle, while at the same time lifting the edges of the record vertically. This is especially important when removing a vinyl record that fits tightly on the spindle. Some records may mount and dismount harder than others.

After turning or changing the record repeat the process for playing a record if you wish to continue listening to the record.

10.5. Levitation Mode / Levitating the levitating platter

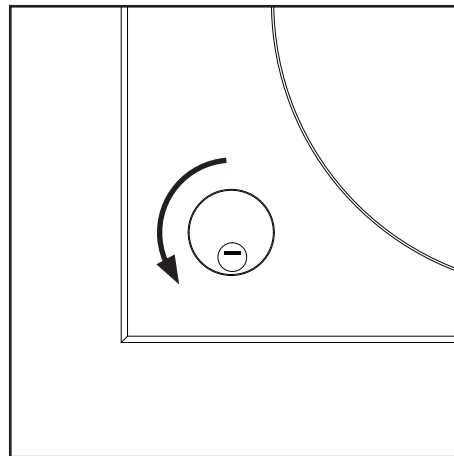

Make sure the turntable is set up properly. Turn the control button counter-clockwise to – mode (6 o'clock).

The platter feet will retract and the levitating platter will begin to levitate.

To stop the levitation mode, turn the control button clockwise to OFF mode (9 o'clock).

The platter feet will rise and hold the levitating platter in place.

10.6. Dust cover

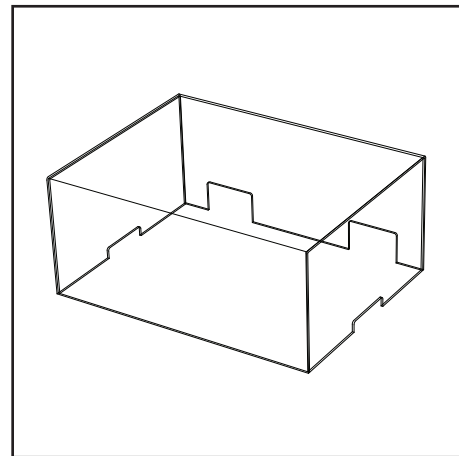

This applies to owners of the MAG-LEV Audio dust cover or any other dust cover.

Only use the dust cover when the turntable is in OFF mode.
Do not use a dust cover that rests on or touches the turntable body.
Do not use a dust cover with no openings for ventilation.
Do not put any items on the dust cover.
Do not push or pull on the dust cover, for it may damage the dust cover or the apparatus.

10.7. UPS (Uninterruptible Power Supply)

This apparatus uses capacitors, which are installed inside of the turntable body, for the use of regulating constant electrical current to the turntable body and to store enough power to bring the turntable to a safe stop in case of a power outage. In case there is a power outage or the cable is accidentally unplugged, the levitating platter will slowly stop turning, the tonearm will lift up and the platter feet will rise and hold the levitating platter. This will bring the apparatus to a safe stop, avoiding damage to the apparatus or any other possessions in the vicinity.

11. CARE

11.1. Turntable body

When the turntable body is dirty or dusty, make sure the turntable is in off mode, then disconnect the power cable plug, remove the turntable platter. Make sure to move the platter 50cm (20") away from the turntable, any metal, magnetic or electronic devices. Lower the turntable feet (page 38), then wipe off the dirt and dust with a soft, dry cloth.
Do not use benzenes, thinners, etc.
When storing the product for a long time, follow

the transportation of the apparatus and repacking procedure. (page 39)

11.2. Platter

Make sure to clean the levitating platter when it is removed from the platter feet. If dirty, clean the mirrors on the bottom of the levitating platter for optimal efficiency and sensors to work properly.

11.3. Stylus tip

If dirt and grime are stuck to the stylus tip, clean it with a commercially sold brush.
We recommend using a stylus cleaner (sold separately) if the stylus tip is considerably dirty. Clean the stylus tip by moving the brush from the rear to the front of the stylus tip.

11.4. Platter mat

Be sure to only use the place mat provided or a placemat from the MAG-LEV Audio list of recommended placemats that work well with ML 1 turntable (refer to website for the list).
If the turntable mat gets dirty, it can easily scratch the record, so remove the mat periodically and wipe off any dust.

12. REPLACING A CARTRIDGE

Make sure you are only using cartridges suggested by MAG-LEV Audio with the turntable. You can find a list of recommended and allowed cartridges at this website www.maglevaudio.com.

Be aware that cartridges not on the list might not work with the turntable and may damage your record or parts of the apparatus.

Refer to the user manual for the cartridge that you will be using if you are replacing the cartridge (Ortofon OM10) included with this product with another, commercially sold cartridge. After you replace the old cartridge with a new one, you must readjust the overhang and the tonearm's balance and tracking force.

REPLACING THE STYLUS

Please check the instructions from the manufacturer of the cartridge, to see how to replace the stylus.

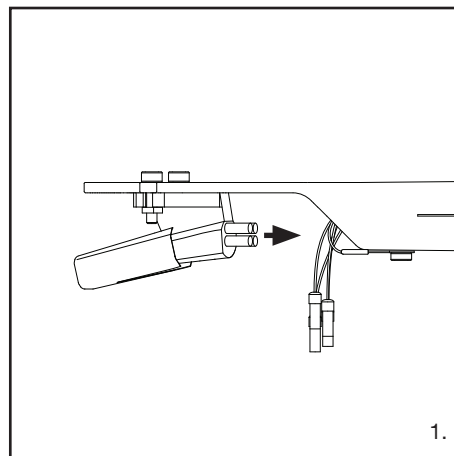

Remove the lead wires. Be careful not to damage the lead wires.

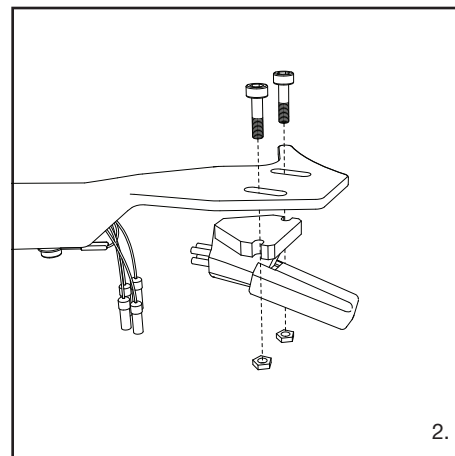

Using a commercially sold, non-metallic slotted screwdriver, remove the installation screws, and then remove the cartridge from the headshell.

Refer to the user manual for the new cartridge for mounting instructions.

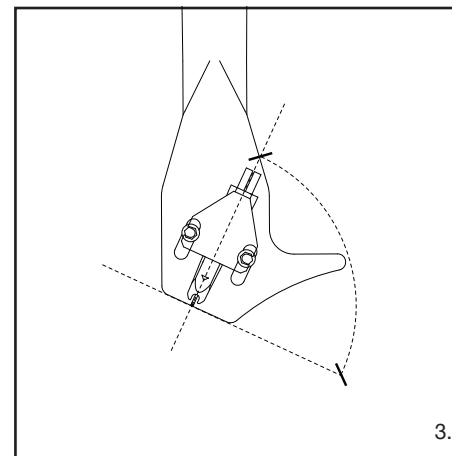

Using a commercially sold, non-metallic slotted screwdriver, tighten the screws in both places, and then adjust the overhang. After the adjustments are complete, tighten the screws securely.

The overhang is already set for the mounted Ortofon OM10. If you wish to change the cartridge or have bought the turntable without one, please read the instructions from the cartridge manufacturer.

The position of the cartridge must be accurately determined (adjusting the overhang) when mounting a cartridge or headshell other than the one provided.

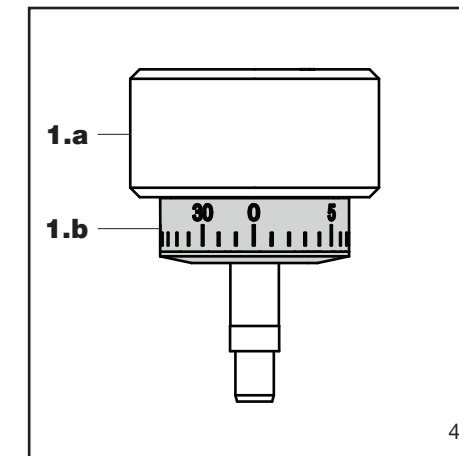

Adjust the tonearm balance and tracking force. Refer to "Tonearm balance and tracking force" (page 20) to perform the readjustments."

13. RESET

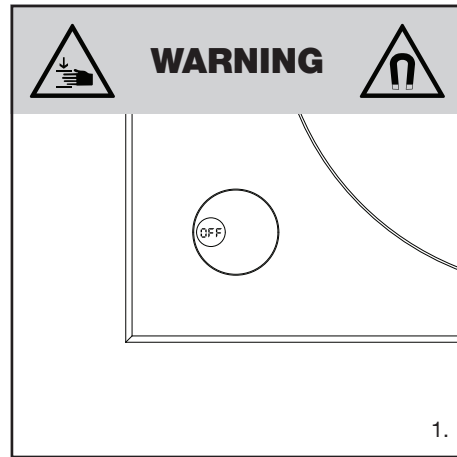

1. Make sure the control button is in OFF mode, platter feet are raised and the levitating platter is resting solidly on the platter feet.

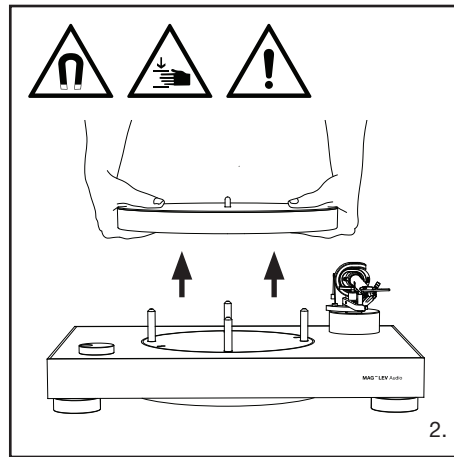

2. Hold the levitating platter firmly with both hands and remove it by lifting it vertically.

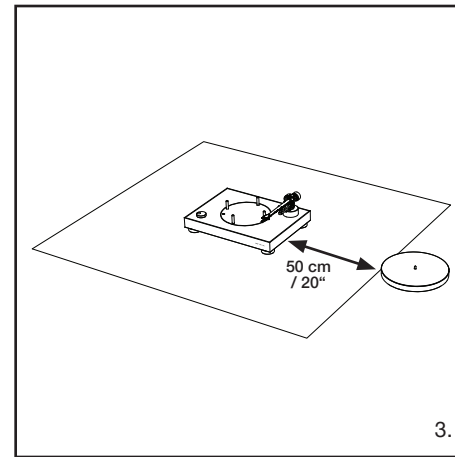

3. Make sure to place the removed levitating platter at least 50cm (20") away from the turntable body and away from any metal, magnetic or electronic objects, to avoid damage to the apparatus or other possessions.

Remove the RCA cables from the turntable body.

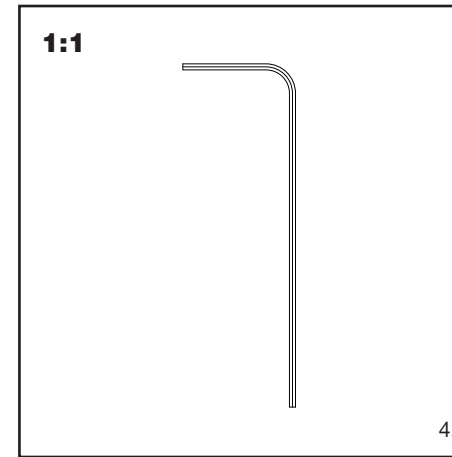

4. Find the smaller inbus key provided or a small pin for the next step.

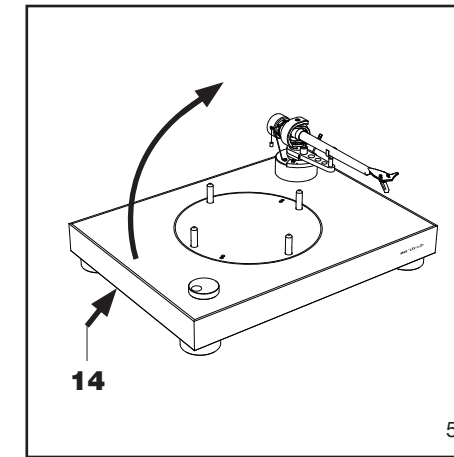

5. With one hand or a help of a friend, lift the turntable body from the left side and press the reset button on the bottom of the turntable body one time.

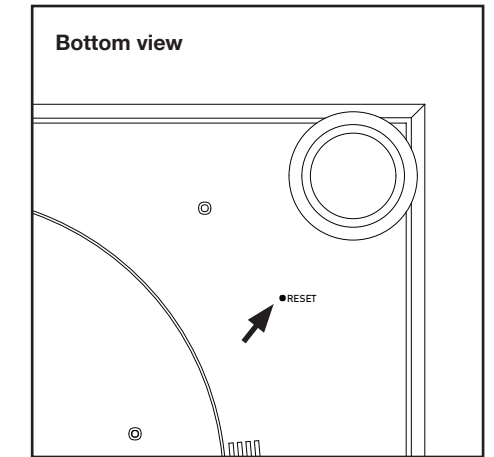

6. Lower the turntable body back on the surface. The platter feet will begin to retract and move into the turntable body. Start using the turntable again.

14. HARD RESET

**REPEAT THE
STEPS 1 - 5 FROM
PREVIOUS CHAPTER
(13. RESET, PAGE 36 - 37).**

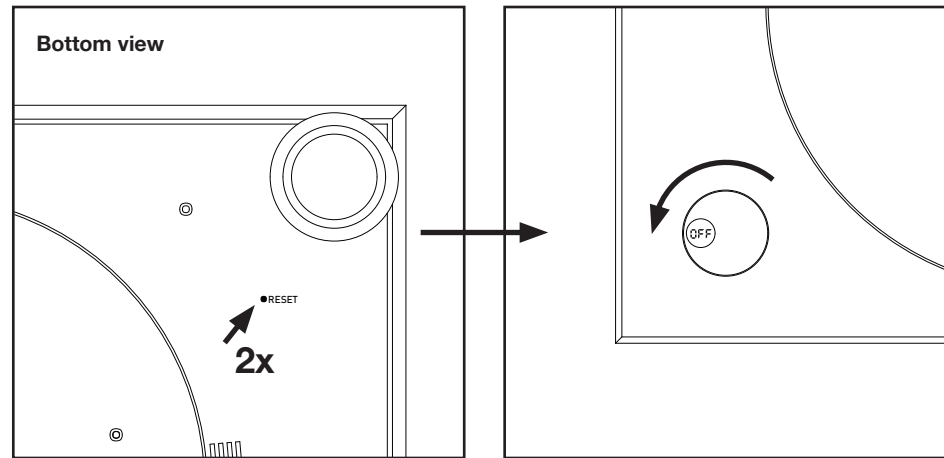

Press the reset button on the bottom of the turntable body two times, quite fast (inside the span of 1 second).

Turn the control button to the levitation mode swiftly.

15. TRANSPORTING AND SHIPPING THE TURNTABLE

Using the product's original packing materials, wrap the turntable in the reverse order from when you unwrapped it.

**REPEAT THE STEP 14.
HARD RESET
(PAGE 38)**

- Remove the power adapter from the turntable body. Carefully pull the plastic casing on the connector to unplug it correctly and not damage the connector.
- Remove the power cord from the outlet in the wall.
- Unscrew the tonearm counterweight.
- Remove the anti-skating weight.
- Place the cartridge protector back onto the cartridge.
- Use a provided cable tie to secure the tonearm to the tonearm rest.
- When the LED ring on the turntable body stops blinking, it is safe to begin packing the turntable.



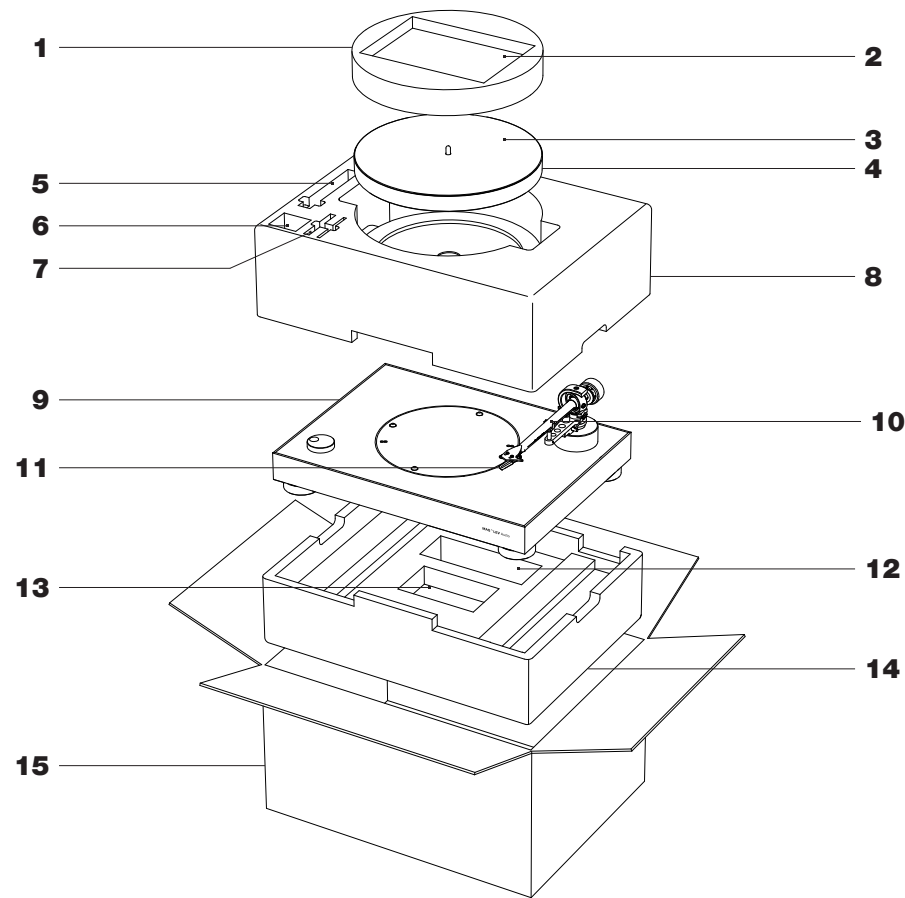

- 1 Circular Styrofoam
- 2 Instructions compartment
- 3 Platter mat
- 4 Levitating platter
- 5 RCA cable compartment
- 6 Counterweight compartment
- 7 Hex keys and anti-skating weight compartment
- 8 Top half of the Styrofoam box
- 9 Turntable body
- 10 Tonearm transport lock
- 11 Cartridge protector
- 12 Power cord compartment
- 13 Power adapter compartment
- 14 Bottom half of the Styrofoam box
- 15 Cardboard box

16.1. Dimensions

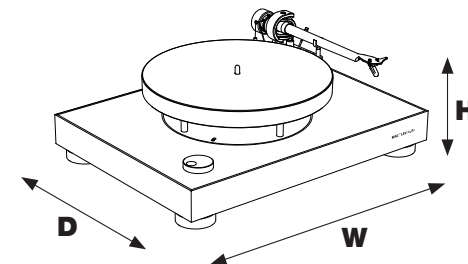

Depth (D)	355 mm
Width (w)	477 mm
Height (H)	185 mm

16. SPECIFICATIONS

16.2. Turntable specifications

Type	Magnetic Levitation, Semi – automatic operation
Motor	No motor
Drive method	MAG-LEV Audio Drive (magnetic coil drive)
Speeds	33-1/3 RPM, 45 RPM
Turntable platter	ABS plastic & Carbon Fiber + magnets and metals, 2.2kg or 4.9 lbs
Wow and flutter	< 0,17%
Signal-to-noise ratio	-73dB
Operating temperature	35°C
Weight	9,8 kg
Package weight	12,2 kg

16.3. Tonearm specifications

1" = 2,54 cm	
Tonearm model	Pro-Ject 9cc
Headshell 0,5" standard	✓
Mounting distance arm base	212 mm
Armtube made of	carbon-fibre
Headshell made of	carbon-fibre

Eff. tonearm lenght	9"
Eff. tonearm mass	8,5 g
Overhang	18 mm
Supplied counterweights for cartridge weights counterweight no. ()	6 - 10 g (nr. 16) -----
Optional counterweights for cartridge weights counterweight no. ()	3 - 6 g (no. 7) 5 - 8 g (no. 9) 11 - 15 g (no. 3)
Downforce range	10 - 30 mN
Weight (without counterweight)	250 g

16.4. Cartridge specifications

Cartridge model	Ortofon OM10
Cartridge type	MM
Recommended load impedance	47kOhm
Output voltage	4,0mV
Stylus	elliptical
Cantilever	aluminium
Tracking force range	12,5 – 17,5 mN (1,25gr – 1,75 gr)
Cartridge weight	5 g

17. TROUBLESHOOTING

PROBLEM

Red light is blinking 5x.

SOLUTION

Something is wrong with the speed of the platter.

Move the tonearm back into the tonearm rest, turn the button to off mode, and restart the process of playing a record.

The weight is not properly set and the stylus is slowing down the platter.

Readjust the counterweight.

Sensors are dirty.

Clean the sensors with a dry cloth.

Sensors are exposed to direct sunlight or strong spotlight

Move the position of the turntable away from direct light so it does not hit the sensors.

Red light is blinking 4x.

The conditions for starting the turntable are not met.

Move the tonearm back into the tonearm rest, turn the button to off mode, and restart the process of playing a record.

Red light is blinking 6x.

The sensors do not recognize the platter, or the platter falls down or is not in position.

Remove the platter completely, move the tonearm back into the tonearm rest, turn the button to off mode and press RESET 1x, on the bottom side of the turntable.

Red light is blinking 1x.

Turntable is only drawing power from the UPS, due to a power outage or a bad connection.

Make sure all of the cables are properly installed.

Amber (White) light is blinking 4x.

The coils are overheating, due to overuse of the control button and lots of acceleration and deceleration.

Move the tonearm back into the tonearm rest, turn the button to off mode, remove the power cord and leave the turntable to cool off for about 30 minutes.

Amber (White) light is blinking 2x.

Starting initialization of the turntable.

Leave the UPS to charge.

The platter does not spin.

Is the power cable plug connected to the outlet?

Connect the power cable plug to the outlet.

Is the control button in OFF or Levitation mode?

Turn the control button into 33 or 45 mode.

Are your sensors in the middle of the turntable dirty?

Gently clean the sensors with a soft dry cloth.

Are the mirrors on the bottom of the platter dirty?

Gently clean the mirrors with a soft dry cloth.

Was the tonearm inside the tonearm rest when you started the playing record process?

Always make sure when you put the tonearm back into the tonearm rest, to push it down into the rest.

Put the tonearm back into the tonearm rest, remove the platter, do a reset (page 36).

If the reset does not work, do a hard reset (page 38)

The platter spins, but there is no sound or the volume is not loud enough.

Are all the cables connected correctly?

Connect all the cables correctly (page 16)

Are any of the cables damaged?

Contact customer support.

Are your cables going to a preamp phono input first?

Use a preamp or a unit with a built in preamp.

Have you chosen the right mode on your amplifier unit?

Choose the correct mode on your device.

Are your speakers connected to the amplifier unit?

Check the cable connection and volume.

The stylus skips.

Is the counterweight set up correctly?

Refer to page 20 and reset the counterweight.

Is the anti-skating weight set up correctly?

Refer to page 25 to set up the anti-skating weight.

Is your record dirty?

Clean the record with a record cleaning brush.

There is noise when the record is playing.

Have you connected the grounding wire?

Grounding wire must be connected from the turntable to the preamp or amplifier unit with the preamp. If you have a preamp, make sure the grounding wire is connected from the preamp to the amplifier also.

The sound when the record is playing is either too fast or too slow.

What is the stated playing speed on your record?
Make sure you use the right speed for each record being played. Switch between 33 and 45 RPM with the control button.
Are your sensors in the middle of the turntable dirty?
Gently clean the sensors with a soft dry cloth.
Are the mirrors on the bottom of the platter dirty?
Gently clean the mirrors with a soft dry cloth.

Playback speed slows down or there is irregular rotation. Light in the control button is blinking, signaling an error. Control button is blinking red (5 x red light flashes).

Is the counterweight set up correctly?
Refer to page 20 and reset the counterweight.
Is the anti-skating weight set up correctly?
Refer to page 25 to set up the anti-skating weight.
Is your record dirty?
Clean the record with a record cleaning brush.
A mistake with the tonearm sensors.
Move the tonearm into the tonearm rest and move the control button to off mode. Remove the platter and check if the sensors on the middle part of the turntable body are clean. Clean them with a soft dry cloth. Also clean the mirrors on the bottom of the platter.

Make sure the sensors are not in direct sunlight or direct artificial light.

Do a reset (page 36). If it does not work, do a hard reset (page 38)

The platter has fallen down and is stuck to the turntable body.

Control button is blinking red (3 flashes every 2 seconds)
Move the tonearm back to the tonearm rest. While holding the turntable body, slowly and carefully pull the platter off the body. Be careful as there are strong magnetic forces present. Do not place the platter back on the turntable. Place it away from any electronic or magnetic items and devices. Do a reset (page 36). If it does not help, do a hard reset (page 38). Also be sure to clean the mirrors on the bottom of the platter and make sure if anything is damaged. If there is extensive damage, contact customer support. If not, start using the turntable following the instructions (page 15).

The platter is swaying more than 2mm.

Are you using the correct equipment?
Only use the provided or suggested placemats. Do not use any weights.
Is the surface for the turntable flat and solid?
Make sure to set up the surface correctly (page 10).

Do you have any magnetic, electronic or metal items closer than 30cm to the turntable?
Make sure you keep such items at least 30cm or 12" away.
Is your floor bouncy?
If your floor is bouncy, we advise to set up the turntable on a wall mounted shelf, to avoid vibrations and swaying.

The tonearm does not lift itself at the end of the record.

Do a reset (page 36).

The LED light does not come on.

Is everything else working normally?
Contact customer support.

The apparatus has no power.

Is the green light in the adapter working?
If not, the adapter needs to be changed.
If yes, contact customer support.

Other problems

All of the above does not help? Do one of the following.
Do a reset (page 36).
Do a hard reset (page 38).
Contact our Customer Service Department at **0038641771907** or at **customersupport@maglevaudio.com**.

This image shows a single sheet of white paper with horizontal ruling lines. The lines are evenly spaced and run across the width of the page. There are no margins, text, or other markings on the paper.This image shows a single sheet of white paper with horizontal ruling lines. The lines are evenly spaced and run across the width of the page. There are no margins, text, or other markings on the paper.

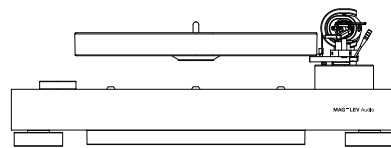

www.maglevaudio.com
