



ARIZONA CHARTER ACADEMY

HOW TO CONNECT TO WI-FI

Below are instructions on how to connect to Wi-Fi at your home with ACA devices. Unfortunately, you will need to repeat these steps every time you would like to connect your ACA device to the Internet (this is an intentional security feature that does not allow ACA devices to automatically remember Wi-Fi networks or their passwords)

Steps for Student Laptop:

1. Log on to your device
2. Look for the Wi-Fi icon () on the bottom right of your screen within the task bar (image 1). Once you click on it, you will see a list of available Wi-Fi networks.

Image 1



3. Click on the name of your home Wi-Fi Network (in the screenshot the home network is called “lacasa” Once you click on it, it will turn a different color & the button “CONNECT” will appear. (see Image 1)
4. Click the button labeled “CONNECT” and you will be prompted to type in the password for your home Wi-Fi network. (Image 2)

Image 2

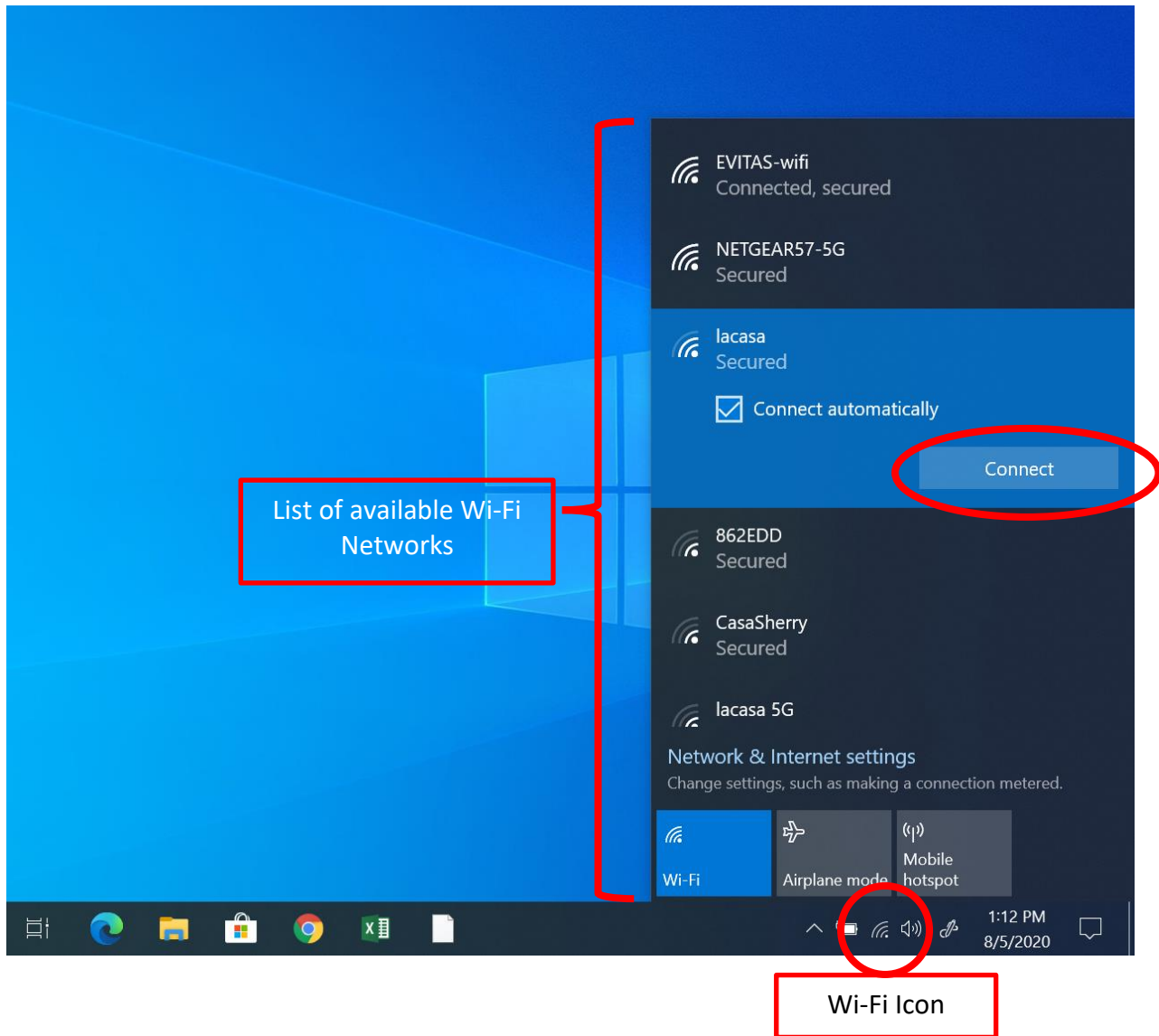
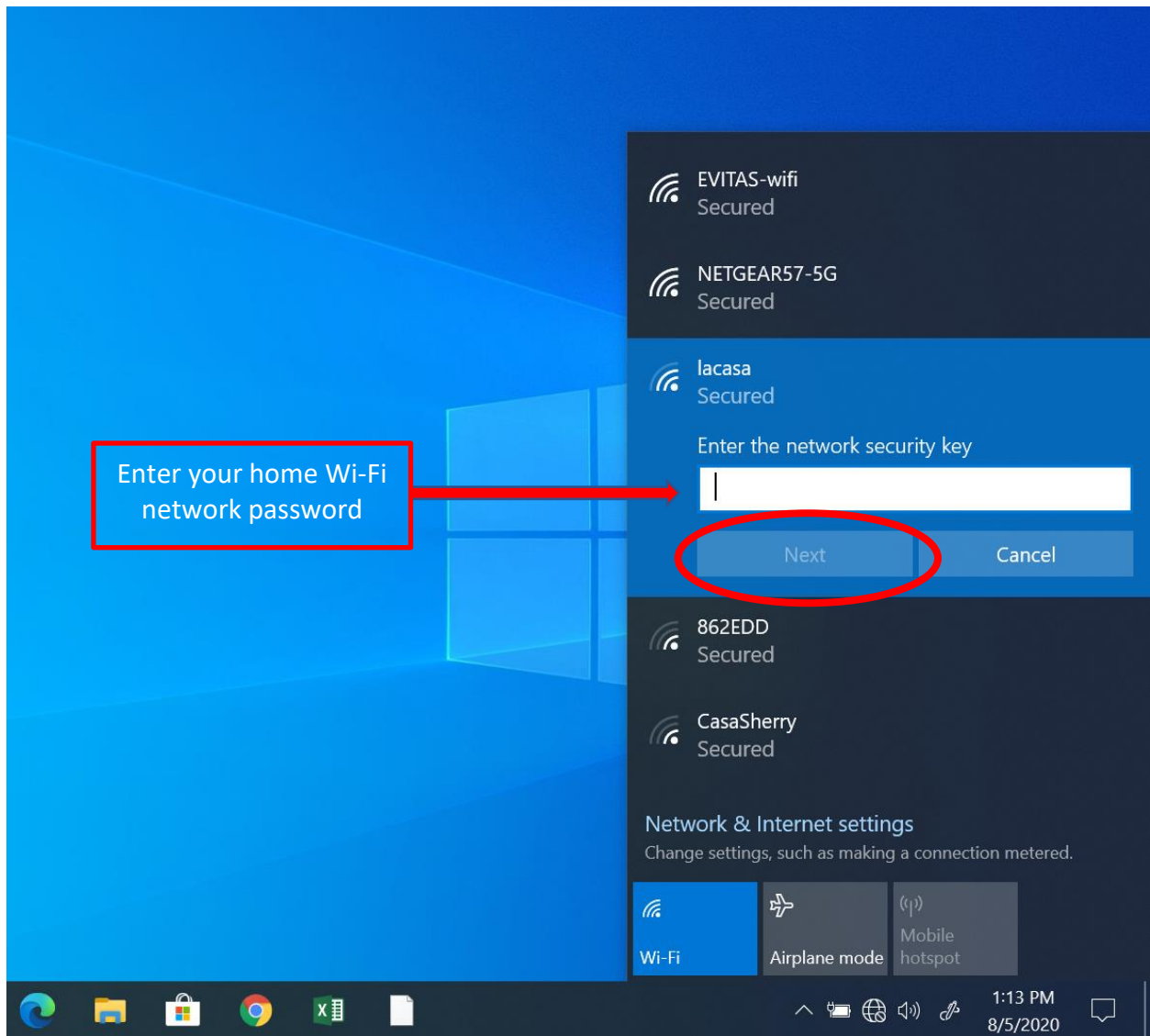

5. Once you enter your home Wi-Fi network password, the button “NEXT” will become available. Double check you entered the correct password and click “NEXT” (see image 2)
6. If you’ve entered the correct password for your home Wi-Fi network, you will be connected and your home Wi-Fi network should appear at the top of your list of available networks with the word “Connected” appearing. It will look similar to (Image 3).

Image 3

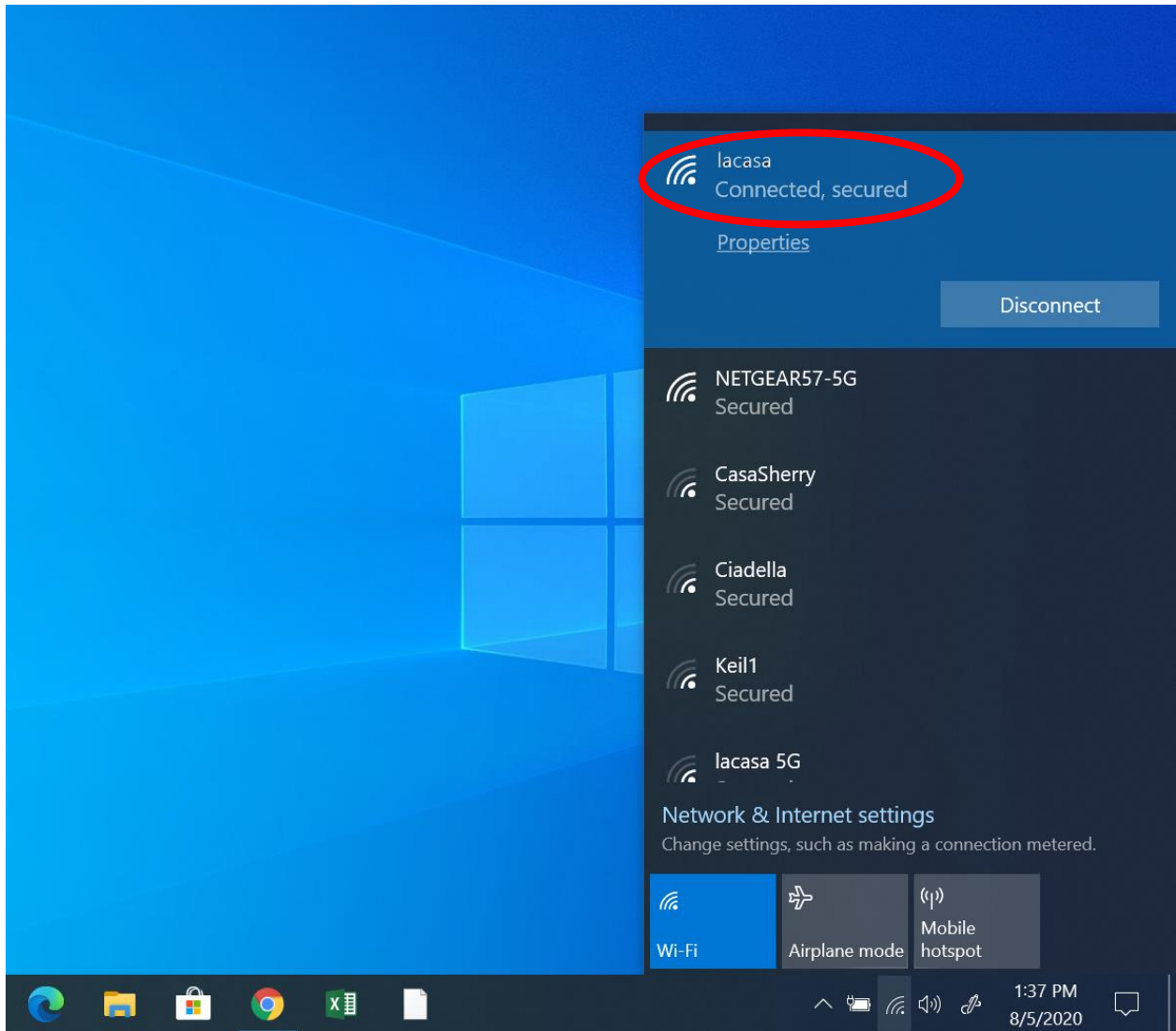

lacasa
Connected, secured

[Properties](#)

Disconnect

NETGEAR57-5G
Secured

CasaSherry
Secured

Ciadella
Secured

Keil1
Secured

lacasa 5G

Network & Internet settings

Change settings, such as making a connection metered.



Wi-Fi



Airplane mode



Mobile hotspot