

11 EN 362 / EN 12275 - MODELS CHART

Table with columns for Ref. No., 'A', and Material. Lists various connector models and their materials like Steel, Stainless steel, and Light alloy.

12 EN 566 - MODELS CHART

Table with columns for Ref. No., Material, and Standard. Lists models like 7W100012, 7W100017, etc., and their standards like EN 362, EN 566, etc.

13 RUBBER FASTENERS / FIXIT / FIXBAR - INSTRUCTIONS FOR USE

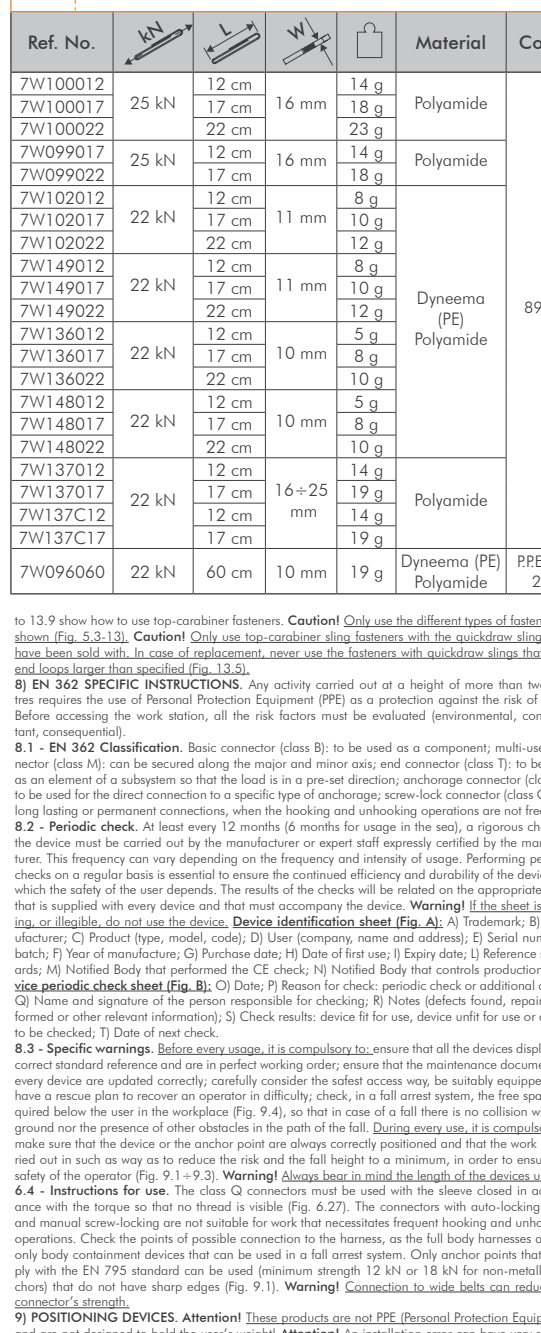

14 FIX PRO - INSTRUCTIONS FOR USE

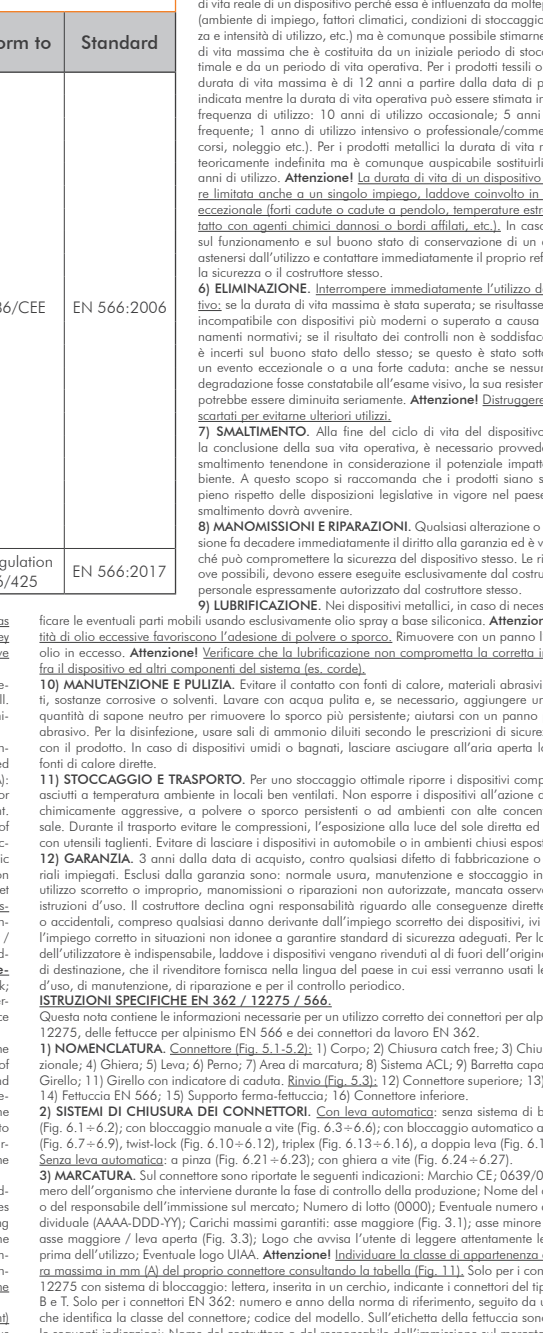

15 PAY ATTENTION TO THE SIZE OF THE WEBBING LOOP

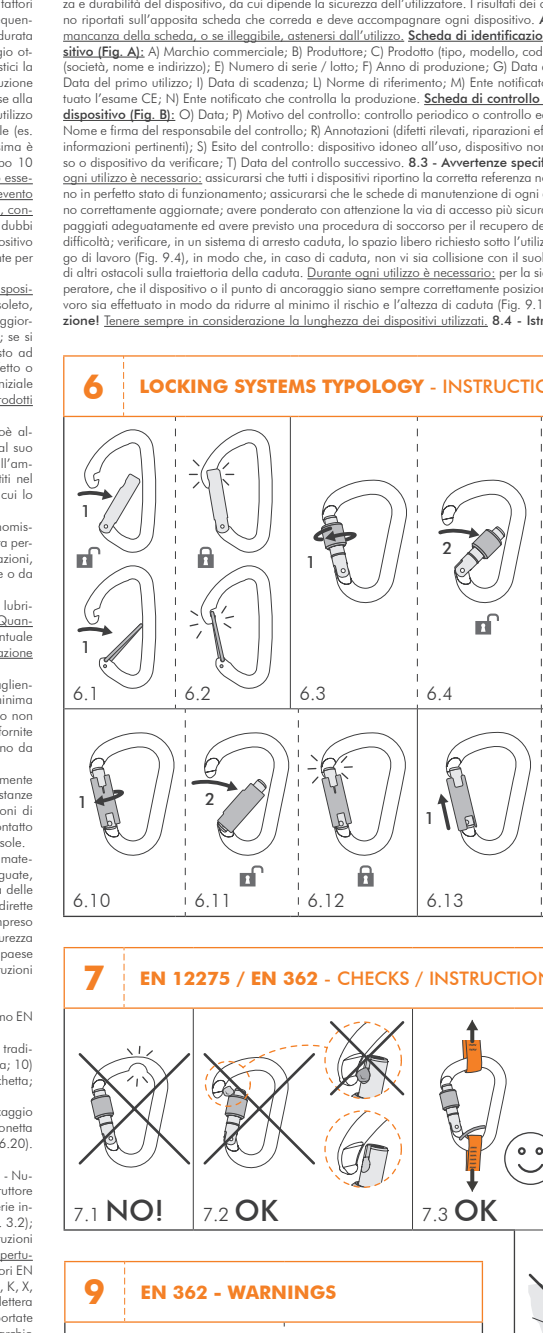

16 ATTENTION! DO NOT USE WITH THIS TYPE OF SLING



17 TRAPEZOIDAL / DO NOT USE WITH THIS TYPE OF SLING



18 EN 12275 - EN 566 - EN 362:2004 INDIVIDUALLY TESTED CONNECTORS MADE IN ITALY

Text providing information about the tested connectors, including the CE marking breakdown (G1, S1, G2, S2) and personal protective equipment requirements.

Traceability information including individual serial numbers (AAAA-DDD-YY) and progressive numbers for manufacturing dates.

Legend for connector types: B, M, T, A, Q, and their corresponding symbols.

Classification of connectors for EN 12275 and EN 362:2004, showing types B, M, T, A, Q and their applications.

Fix Pro compatibility information, listing compatible locking systems (ISG, WG, TG) and materials (alloy, zinc plated steel, stainless steel).

5 NOMENCLATURE OF PARTS

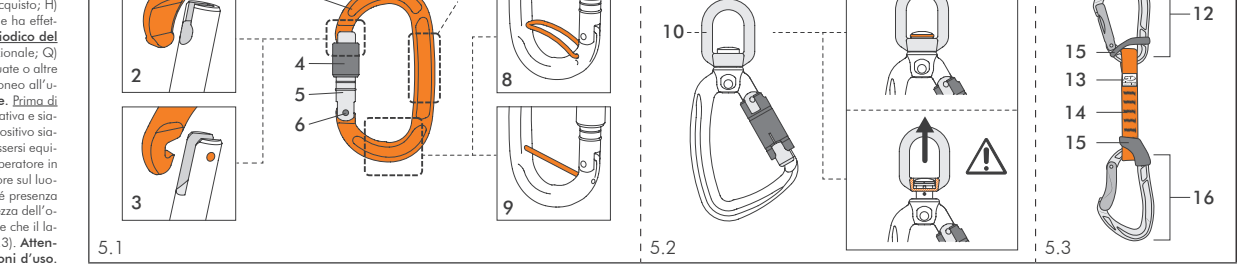

6 LOCKING SYSTEMS TYPOLOGY - INSTRUCTIONS FOR USE

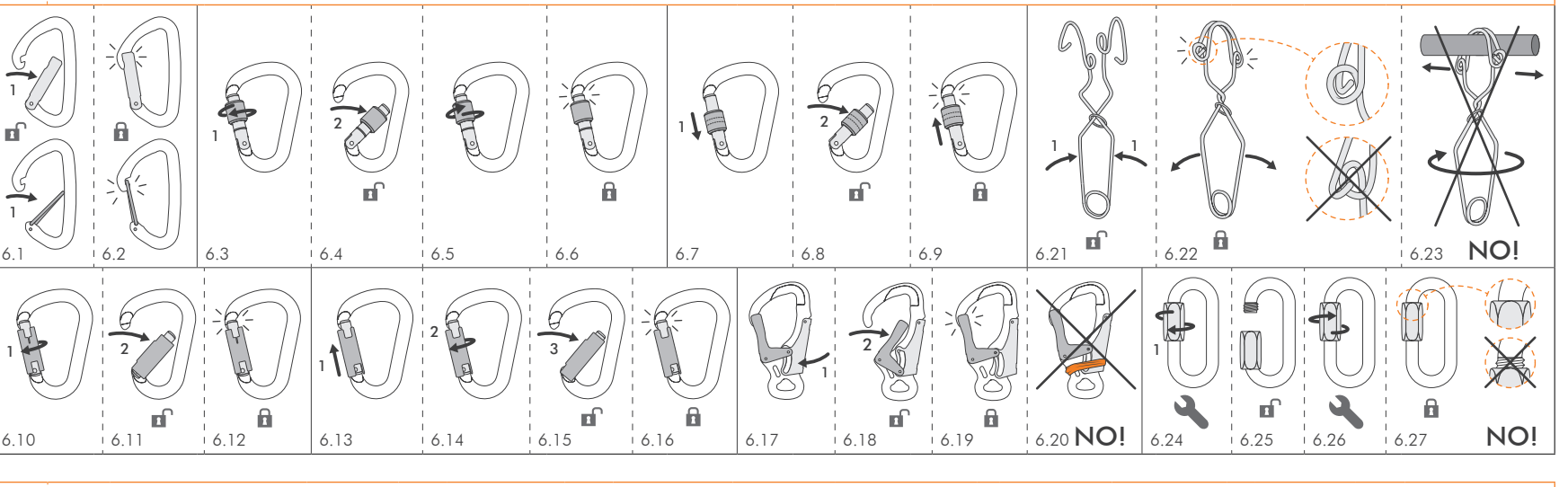

7 EN 12275 / EN 362 - CHECKS / INSTRUCTIONS FOR USE OF THE CONNECTORS

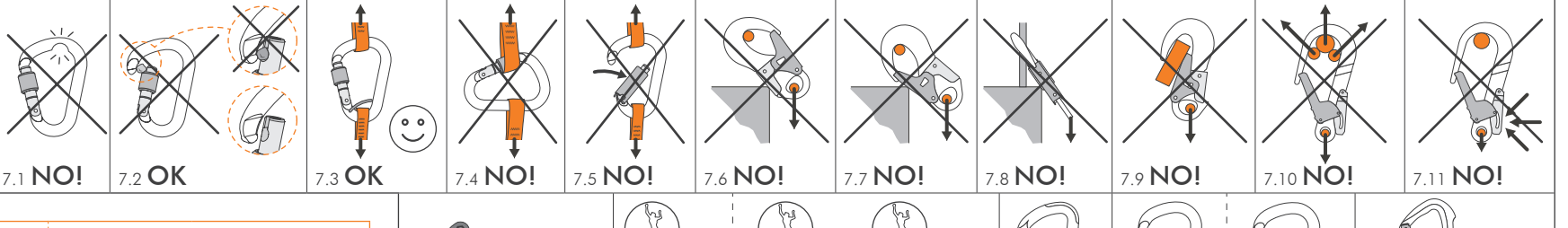

9 EN 362 - WARNINGS

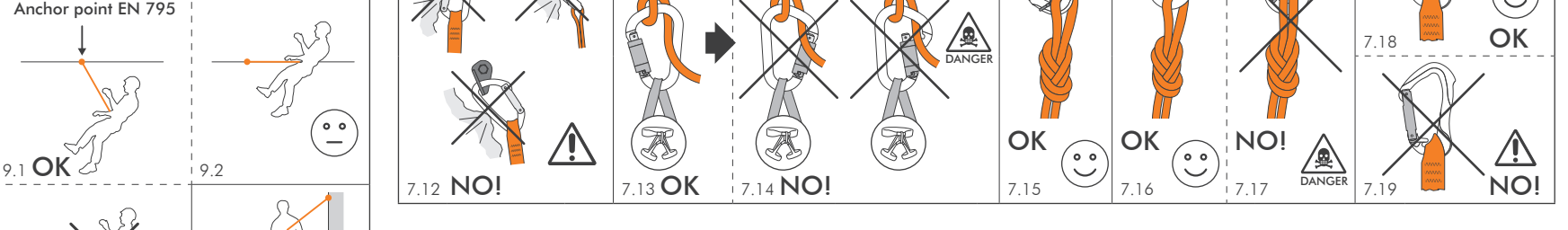

8 EN 12275 / EN 566 - INSTRUCTIONS FOR USE OF THE QUICKDRAWS

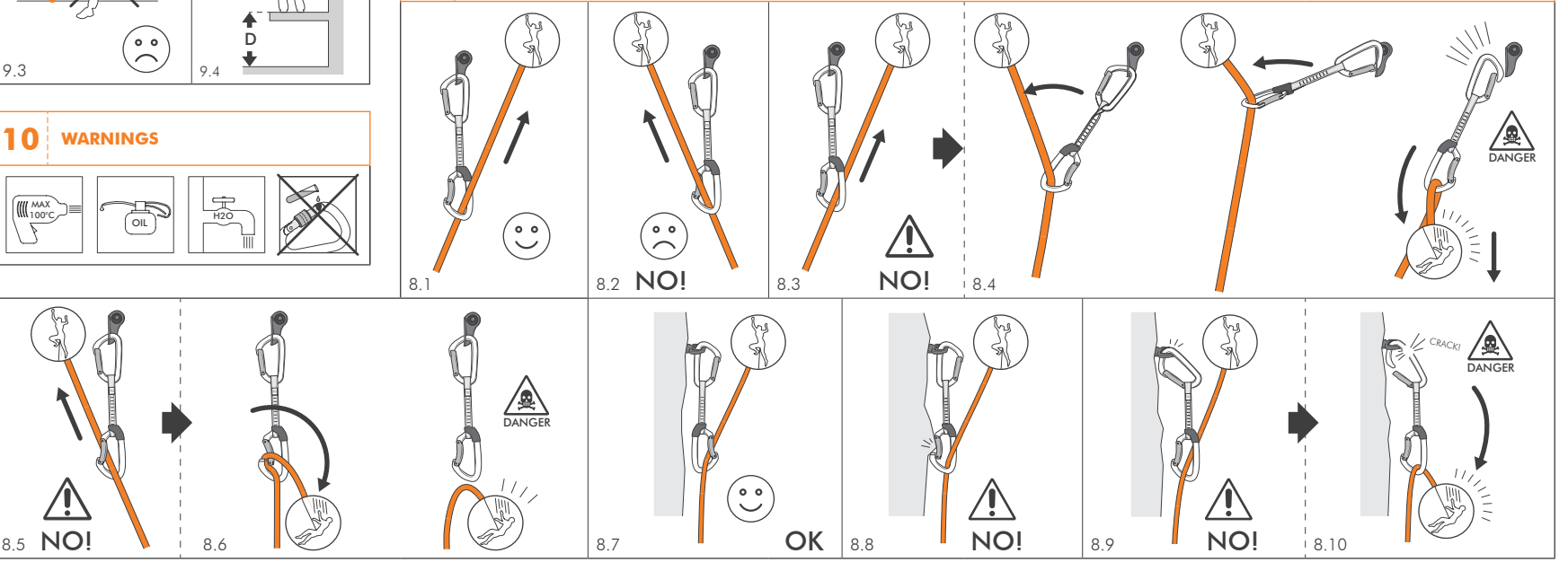

ENGLISH

GENERAL INSTRUCTIONS FOR USE. On the website www.climbingtechnology.com you can find the complete instructions for use of the device.

ITALIANO

ISTRUZIONI D'USO GENERALI. Sul sito www.climbingtechnology.com potrete trovare: informazioni generali; altre lingue e/o versioni aggiornate delle istruzioni d'uso; dichiarazioni di conformità UE.

ENGLISH

GENERAL INSTRUCTIONS FOR USE. On the website www.climbingtechnology.com you can find the complete instructions for use of the device.

ITALIANO

ISTRUZIONI D'USO GENERALI. Sul sito www.climbingtechnology.com potrete trovare: informazioni generali; altre lingue e/o versioni aggiornate delle istruzioni d'uso; dichiarazioni di conformità UE.





