

SQUARE TWIN 90 SLIDE DOOR SHOWERS

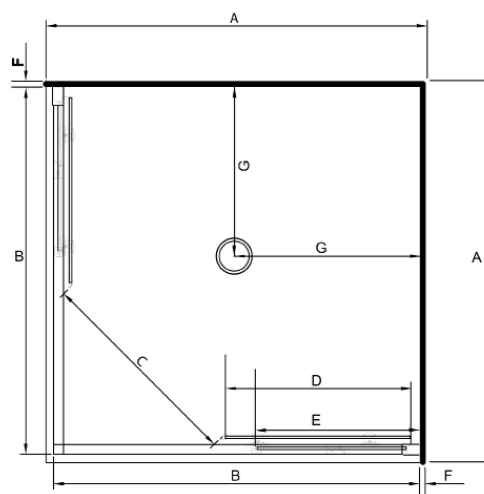

Pictured above - Stellar Twin 90 Square 9x9 Silva Door Moulded Wall **SKU - 248542**



DESCRIPTION

The Stellar Twin 90 Square range of Showers can be purchased as a complete shower cubicle including Acrylic Tray, Wall Liner and Door pack.

The door pack and tray can also be purchased as an individual item for installation on a tiled floor and wall installation.

FEATURES

- Low profile tray with 40mm upstand
- 1950mm high glass
- Total OVERALL height 2020mm
- Flat glass sliding doors 6mm Safety Glass
- Large interior space
- Dual alloy rollers
- Metal trim on base of glass return
- Polished quality metal chrome handle, inner & outer

LEGEND

Dimension	Description	Shower Size	
		900mm	1000mm
A	Tray External Dimension	900mm	1000mm
B	Door Frame Dimension	870mm	970mm
C	Door Opening	502mm	572mm
D	Door Panel External Dimension	436mm	486mm
E	Return Panel Dimension	392mm	442mm
F	Gib Board + Glue + Liner Thickness	13mm	13mm
G	Waste Position (Centre waste)	450mm	500mm

ORDERING CODES

Product Description	SKU CODE	
	900mm	1000mm
Complete Cubicle White Flat Wall	326900	326904
Complete Cubicle Silva Flat Wall	326899	326903
Complete Cubicle White MOULDED Wall	326902	326906
Complete Cubicle Silva MOULDED Wall	326901	326905
Tray Only Centre Waste White	TFS9x9CW	TFS1000CW
Liner Only Flat Wall 1950mm High White	LB9X9FW2S195	LB1X1FW2S195
Liner Only Moulded Wall 1950mm High White	LB9X9MW2S195	LB1X1MW2S195
Twin 90 Door Pack Complete 1950MM High White	DCS900WH195	DCS1000WH195
Twin 90 Door Pack Complete 1950MM High Silva	DCS900SI195	DCS1000SI195

WARRANTY INFORMATION

All bathroom ware products supplied by Nouera Shower systems carry our Quality Assurance and Product Warranty. We use the highest quality materials available and manufacture these in accordance with New Zealand specifications and requirements to ensure that all products are fit for the intended purpose for which they are designed. Our customers Peace of Mind is of paramount importance to us.

Warranty Periods

Baths	10 years
Showers	10 years
Shower Screens and Doors	10 years

Warranty Exclusions

The product must be installed according to the instructions supplied.
The water supply temperature applied to the product must not exceed 55 degrees Celsius.
Commercial Applications are restricted to a 2 year warranty on all products."



CLEANING AND MAINTENANCE

Bathroom products are used often and the following is our suggestion on how to clean and care for them.

Shower Wall

We use Durosan premium quality sanitaryware grade Acrylic. It is, by design very robust and chemical resistant. A soft damp cloth with non abrasive cleaners should be used. Use only non abrasive cleaners that are recommended for Acrylic products.

Shower Tray and Bath

We manufacture our Shower Trays and Baths using a Solid Acrylic Surface. Most other shower trays are manufactured using a veneer Acrylic surface. The great advantage is that small scratches can be removed easily by using fine cutting compound. Again the same basic cleaning methods as the wall are recommended.

Shower Doors and Glass

All glass is compliant to AS/NZS 2208. We suggest that the glass surfaces are wiped down or Squeegeed following use to remove excess water. For best results use a trusted glass cleaner.

Metal framework

should be cleaned using a soft damp cloth with non abrasive cleaner. Note that on round Showers, the bottom rollers are easy release for ease of cleaning. If chemical spray cleaners are used, avoid direct contact with the rollers and guides and ensure the shower is rinsed off to avoid residue build up.

Weather seals and drip strips

Can be removed if required for cleaning, and can be replaced when they no longer look their best Refer to our spare parts and accessories section of this website for more details.

Note - If the Glass has been treated follow specific cleaning instructions from the system provider.