

# LUXURY BLACK EDITION 2 SIDED SHOWERS

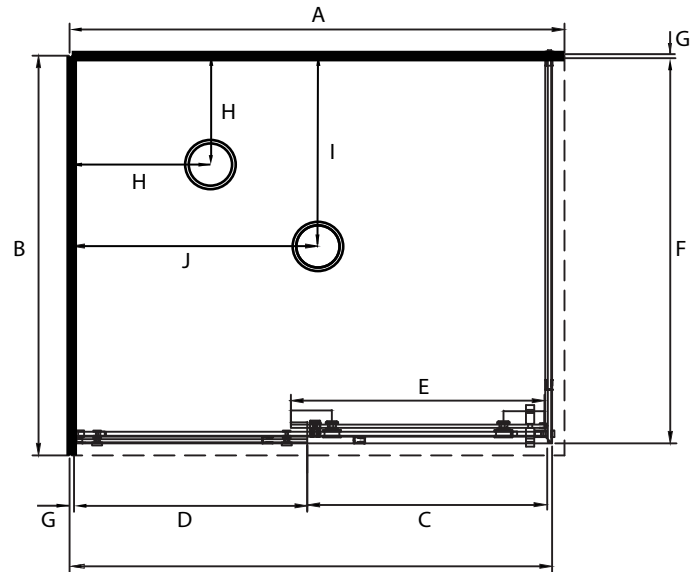

Pictured - Stellar Luxury BLACK EDITION 12 x 1 2 sided  
**RIGHT HAND.** SKU 318630



## DESCRIPTION

The Stellar Luxury BLACK EDITION Range of Showers can be purchased as a complete Shower Cubicle including Acrylic Tray, Wall Liner and Door pack.

The door pack can also be purchased as an individual item for installation on a tiled floor and wall installation.

SEE TILE SHOWER LAYOUT FOR SETOUT DIMENSIONS

The door is not reversible - and closes to the Glass Return.

## FEATURES

- MATT BLACK Extrusions and Hardware
- Low profile 60mm tray with 40mm upstand
- 2000mm high glass 8mm Safety Glass
- Total OVERALL height 2060mm
- Door Closes to Glass return
- Minimalistic extrusion allows adjustment to wall and floor
- No Silicone Joints required for Glass

## LEGEND

Dimension	Description	Shower Size			
		1200x800	1200x900	1200x1000	1400x1000
A	Tray Length External Dimension	1200mm	1200mm	1200mm	1200mm
B	Tray Depth External Dimension	800mm	900mm	1000mm	1000mm
C	Door Opening Dimension +/- 10mm	540mm	540mm	540mm	640mm
D	Small Return Panel Dimension	562mm	562mm	562mm	662mm
E	Door Panel Dimension	618mm	618mm	618mm	718mm
F	Large Return Panel Dimension	758mm	858mm	958mm	958mm
G	Gib Board + Glue + Liner Thickness	13.0mm	13.0mm	13.0mm	13.0mm
H	Corner Waste Position (from Framing)	250mm	250mm	250mm	250mm
I	Centre Waste Position (Depth from Framing)	N/A	N/A	500mm	N/A
J	Centre Waste Position (Width from Framing)	N/A	N/A	600mm	N/A

## ORDERING CODES

Product Description	SKU CODE			
	1200 x 800	1200 x 900	1200 x 1000	1400 x 1000
Complete Cubicle BLACK Flat Wall Left Hand	318631	318633	318629	318635
Complete Cubicle BLACK Flat Wall Right Hand	318632	318634	318630	318636
Tray Only Corner Waste White Left Hand	TFR12X8LHCNR	TFS12X9LHCNR	TFS12X10LHCNR	TFS14X10LHCNR
Tray Only Corner Waste White Right Hand	TFR12X8RHCNR	TFS12X9RHCNR	TFS12X10RHCNR	TFS14X10RHCNR
Centre waste option for tray (please add)	N/A	N/A	119561	N/A
Liner Only Flat Wall 2000mm High 2 sided White	LB12X8FW2S2M	LB12X9FW2S2M	LB12X1FW2S2M	LB14X1FW2S2M
Door / Return Pack 2000MM High BLACK Left Hand	D12DX8RBLH2M	D12DX9RBLH2M	D12DX1RBLH2M	D14X1RBLH2M
Door / Return Pack 2000MM High BLACK Right Hand	D12DX8RBLRH2M	D12DX9RBLRH2M	D12DX1RBLRH2M	D14X1RBLRH2M

## WARRANTY INFORMATION

All bathroom ware products supplied by Nouera Shower systems carry our Quality Assurance and Product Warranty. We use the highest quality materials available and manufacture these in accordance with New Zealand specifications and requirements to ensure that all products are fit for the intended purpose for which they are designed. Our customers Peace of Mind is of paramount importance to us.

### Warranty Periods

Baths	10 years
Showers	10 years
Shower Screens and Doors	10 years

### Warranty Exclusions

The product must be installed according to the instructions supplied.  
The water supply temperature applied to the product must not exceed 55 degrees Celsius.  
Commercial Applications are restricted to a 2 year warranty on all products."



## CLEANING AND MAINTENANCE

Bathroom products are used often and the following is our suggestion on how to clean and care for them.

### Shower Wall

We use Durosan premium quality sanitaryware grade Acrylic. It is, by design very robust and chemical resistant. A soft damp cloth with non abrasive cleaners should be used. Use only non abrasive cleaners that are recommended for Acrylic products.

### Shower Tray and Bath

We manufacture our Shower Trays and Baths using a Solid Acrylic Surface. Most other shower trays are manufactured using a veneer Acrylic surface. The great advantage is that small scratches can be removed easily by using fine cutting compound. Again the same basic cleaning methods as the wall are recommended.

### Shower Doors and Glass

All glass is compliant to AS/NZS 2208. We suggest that the glass surfaces are wiped down or Squeegeed following use to remove excess water. For best results use a trusted glass cleaner.

### Metal framework

Should be cleaned using a soft damp cloth with non abrasive cleaner. Note that on round Showers, the bottom rollers are easy release for ease of cleaning. If chemical spray cleaners are used, avoid direct contact with the rollers and guides and ensure the shower is rinsed off to avoid residue build up.

### Weather seals and drip strips

Can be removed if required for cleaning, and can be replaced when they no longer look their best Refer to our spare parts and accessories section of this website for more details.

**Note - If the Glass has been treated follow specific cleaning instructions from the system provider.**