

RECTANGULAR ALCOVE PIVOT DOOR SHOWERS

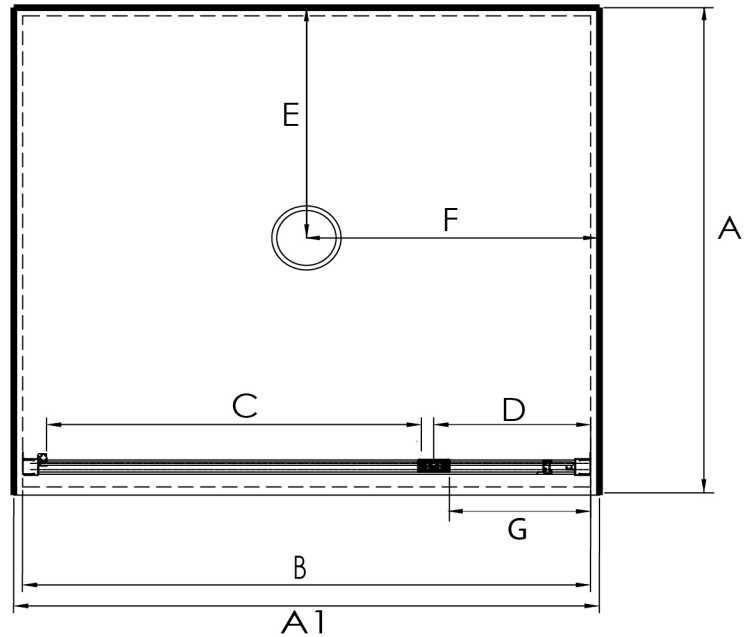

Pictured - Vela 900x760 Alcove Flat Wall White Pivot Door
SKU CODE 248515

DESCRIPTION

The Stellar Rectangular Alcove Pivot Door range of Showers can be purchased as a complete Shower cubicle including Acrylic Tray, Wall Liner and Door pack.

The door pack and tray can also be purchased as an individual item for installation on a tiled floor and wall installation.

FEATURES

- Low profile 70mm tray with 40mm upstand
- 1950mm high glass
- Total OVERALL height 2020mm
- Removeable drip strip and gutter
- Pivot door - Modern 1pc design, 6mm Safety Glass
- Magnetic strip on closing edge of door
- Metal Trim on Base of Glass Return
- Polished quality metal chrome handle, inner & outer

LEGEND

Dimension	Description	Shower Size		
		760x900 900mm Door	900 x 760 760mm Door	1200x900 1200mm Door
A	Tray External Dimension Depth	760mm	900mm	900mm
A1	Tray External Dimension Width	900mm	760mm	1200mm
B	Door Frame Outer Dimension	875mm	735mm	1175mm
C	Door Opening Dimension	640mm	550mm	640mm
D	Centre of Pivot Block to Liner	138mm	88mm	410mm
E	Waste position Depth	380mm	450mm	250mm
F	Waste Position Width	450mm	380mm	600mm
G	Small Glass Return Panel Width	N/A	N/A	393mm

ORDERING CODES

Product Description	SKU CODE		
	760x900 900mm Door	900 x 760 760mm Door	1200 x 900 1200mm Door
Rectangular Alcove 3 sided Flat Wall White Pivot Door	248515	248555	248519
Rectangular Alcove 3 sided Flat Wall SILVA Pivot Door	248517	248557	248521
Rectangular Alcove 3 sided Moulded Back Wall White Pivot Door	248516	N/A	248520
Rectangular Alcove 3 sided Moulded Back Wall SILVA Pivot Door	248518	N/A	248522
Flat Alcove Tray Only	TFS7X9X7ALCCW	TFS9X7X9ALCCW	TFS9X12X9ALCRCW
Flat Alcove Wall Liner Only White 1950mm high	LB7x9x7FW3S195	LB9x7x9FW3S195	LB9X12X9FW3S195
Moulded Back Wall / Wall Liner Only White 1950mm high	LB7x9x7MW3S195	LB9x7x9MW3S195	LB9X12X9MW3S195
Pivot Door Only White (reversible opening)	D900WH195	D760WH195	D1200WH195
Pivot Door Only Silva (reversible opening)	D900SI195	D760SI195	D1200SI195

WARRANTY INFORMATION

All bathroom ware products supplied by Nouera Shower systems carry our Quality Assurance and Product Warranty. We use the highest quality materials available and manufacture these in accordance with New Zealand specifications and requirements to ensure that all products are fit for the intended purpose for which they are designed. Our customers Peace of Mind is of paramount importance to us.

Warranty Periods

Baths	5 years
Showers	5 years
Shower Screens and Doors	5 years

Warranty Exclusions

The product must be installed according to the instructions supplied.
The water supply temperature applied to the product must not exceed 55 degrees Celsius.
Commercial Applications are restricted to a 2 year warranty on all products."

Bathroom products are used often and the following is our suggestion on how to clean and care for them.

Shower Wall

We use Durosan premium quality sanitaryware grade Acrylic. It is, by design very robust and chemical resistant. A soft damp cloth with non abrasive cleaners should be used. Use only no abrasive cleaners that are recommended for Acrylic products.

Shower Tray and Bath

We manufacture our Shower Trays and Baths using a Solid Acrylic Surface. Most other shower trays are manufactured using a veneer Acrylic surface. The great advantage is that small scratches can be removed easily by using fine cutting compound. Again the same basic cleaning methods as the wall are recommended.

Shower Doors and Glass

All glass is compliant to AS/NZS 2208. We suggest that the glass surfaces are wiped down or Squeegeed following use to remove excess water. For best results use a trusted glass cleaner.

Metal framework

should be cleaned using a soft damp cloth with non abrasive cleaner. Note that on round Showers, the bottom rollers are easy release for ease of cleaning. If chemical spray cleaners are used, avoid direct contact with the rollers and guides and ensure the shower is rinsed off to avoid residue build up.

Weather seals and drip strips

Can be removed if required for cleaning, and can be replaced when they no longer look their best Refer to our spare parts and accessories section of this website for more details.

Note - If the Glass has been treated follow specific cleaning instructions from the system provider.