

Ornate luminosité

Georgia Brechelt

Designed to offer a soft, decorative addition to the theatre, casting a soft glow yet bold ornate shadows, this interactive light installation engages the viewer in illuminating theatrics while emitting an ominous mood throughout the entry-way.

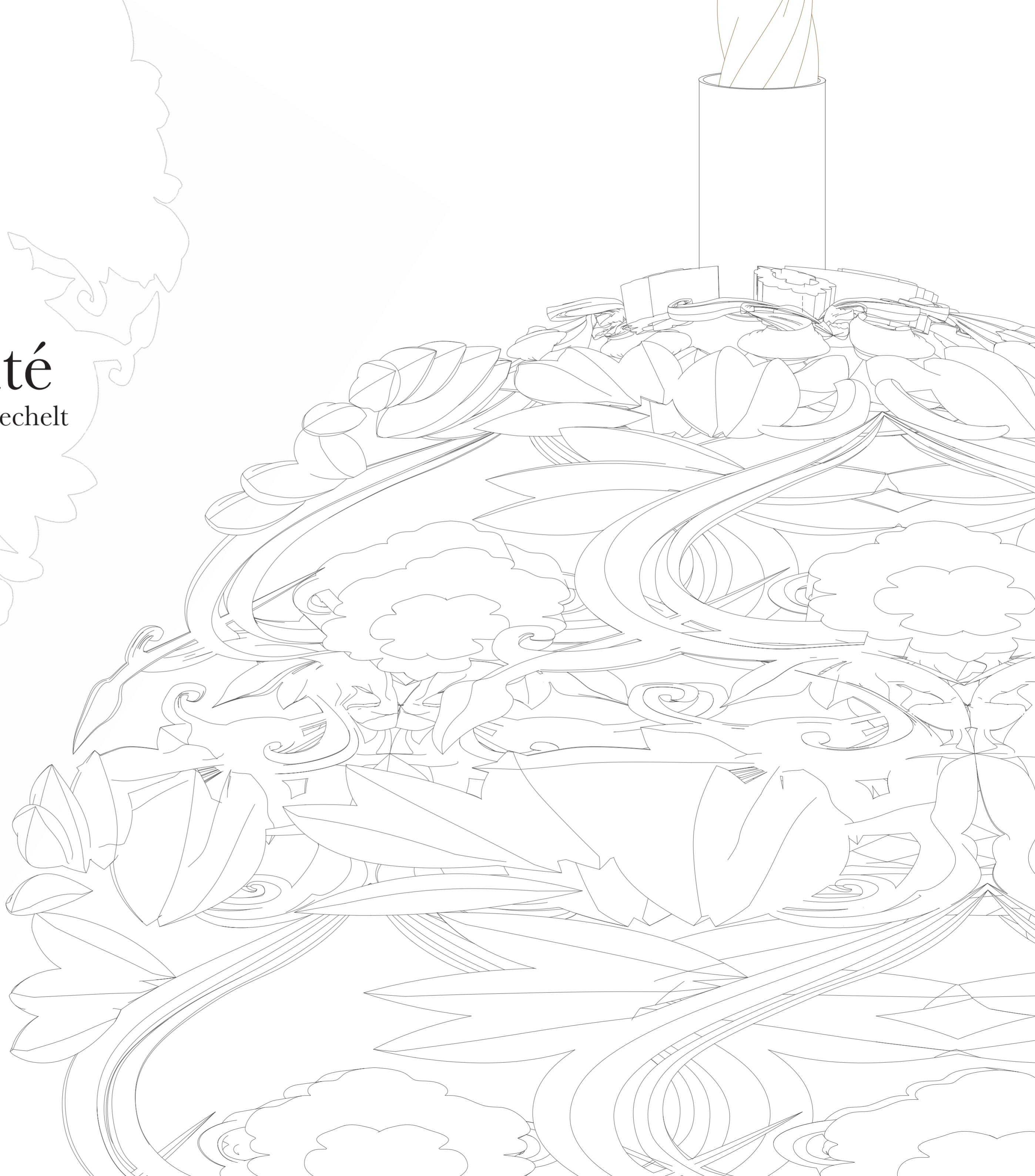

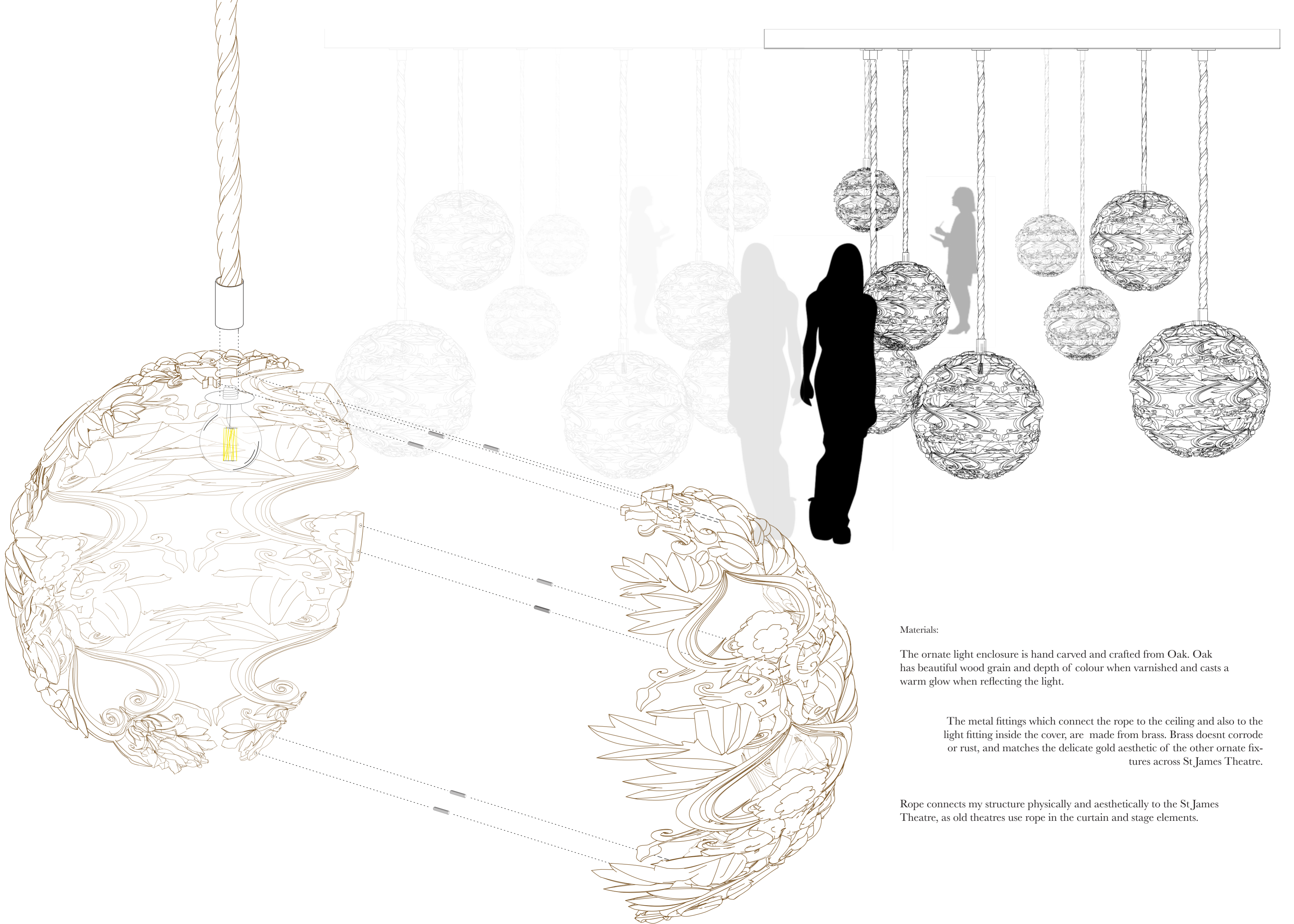

Materials:

The ornate light enclosure is hand carved and crafted from Oak. Oak has beautiful wood grain and depth of colour when varnished and casts a warm glow when reflecting the light.

The metal fittings which connect the rope to the ceiling and also to the light fitting inside the cover, are made from brass. Brass doesn't corrode or rust, and matches the delicate gold aesthetic of the other ornate fixtures across St James Theatre.

Rope connects my structure physically and aesthetically to the St James Theatre, as old theatres use rope in the curtain and stage elements.

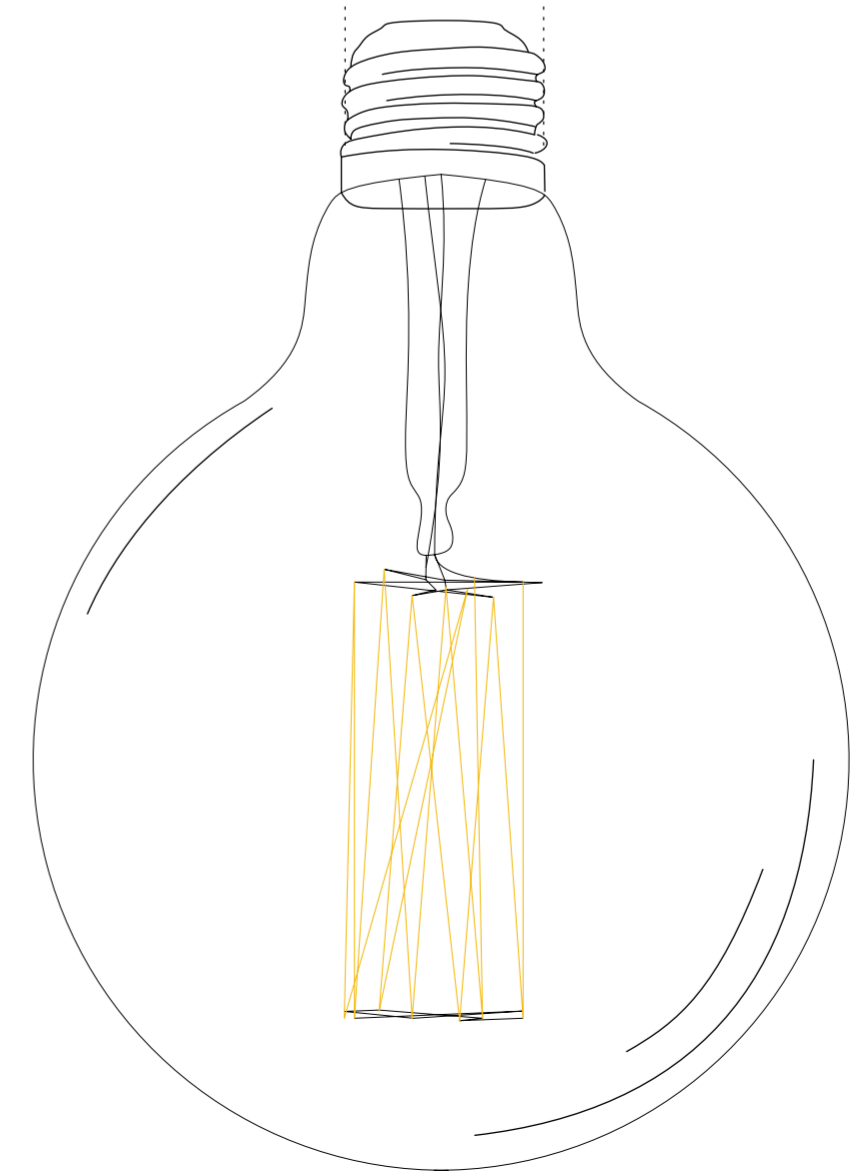
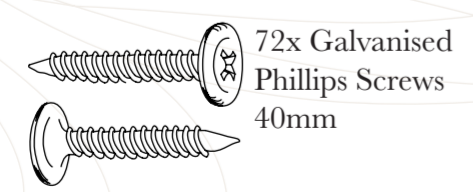
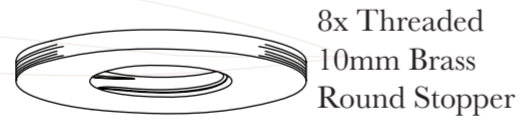
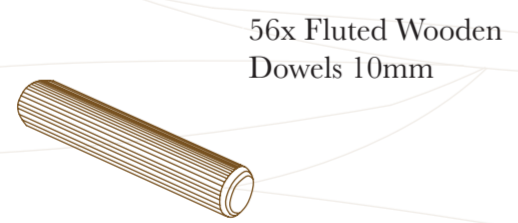
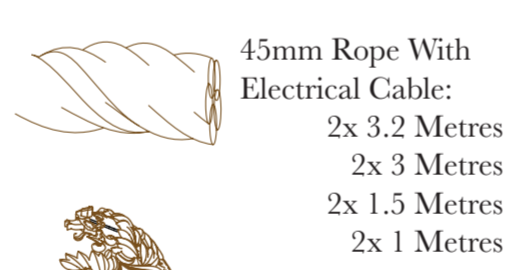
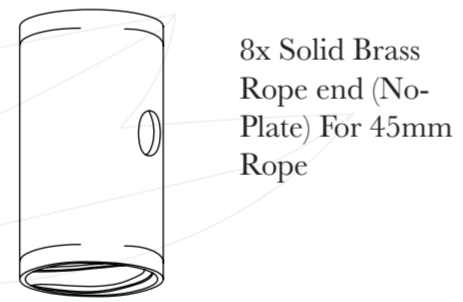
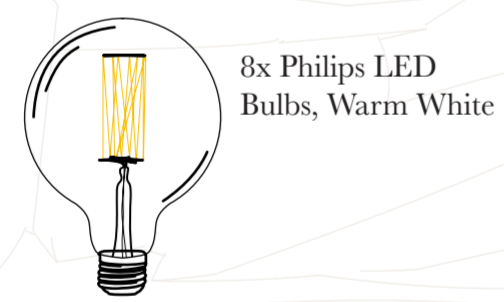
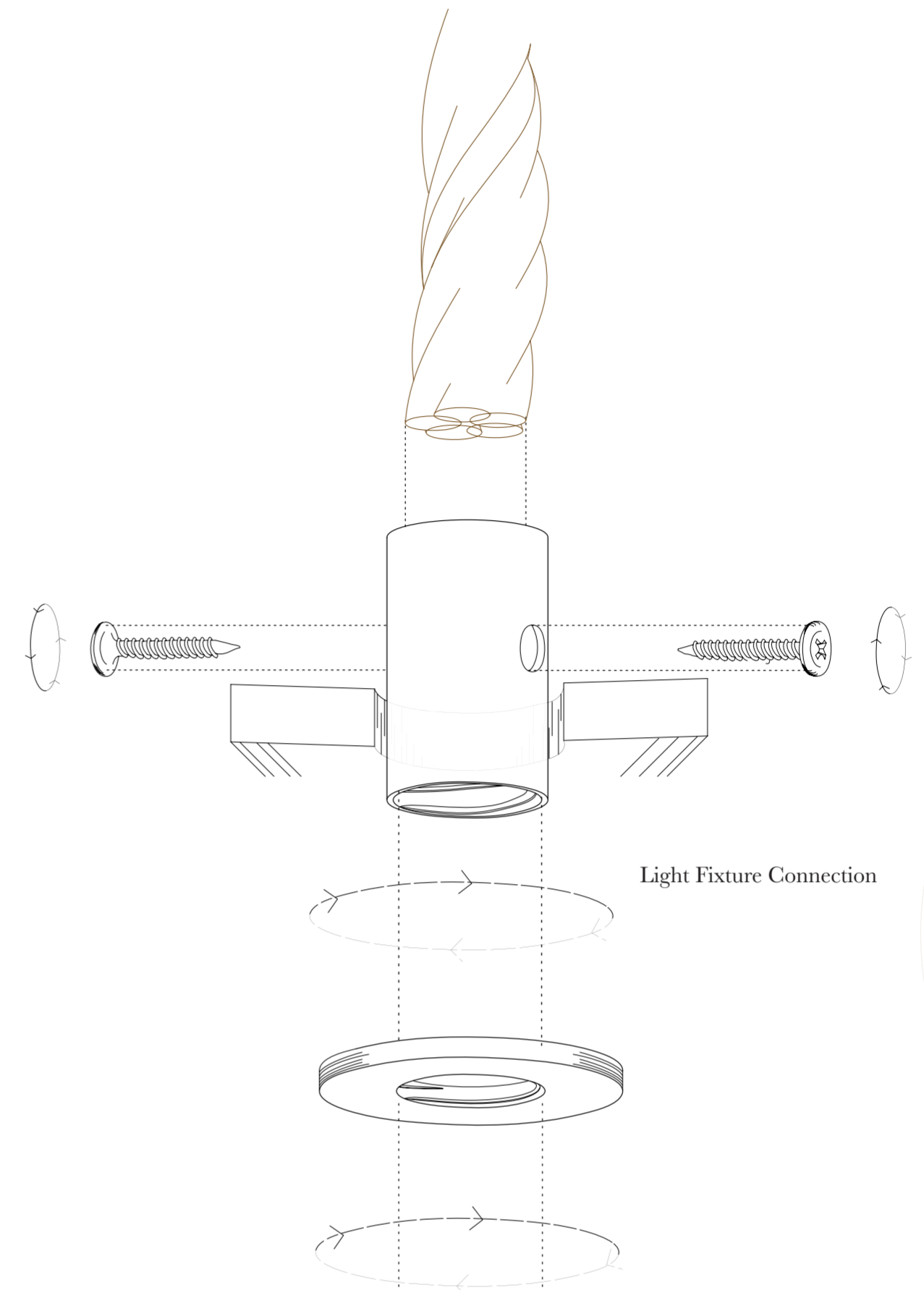
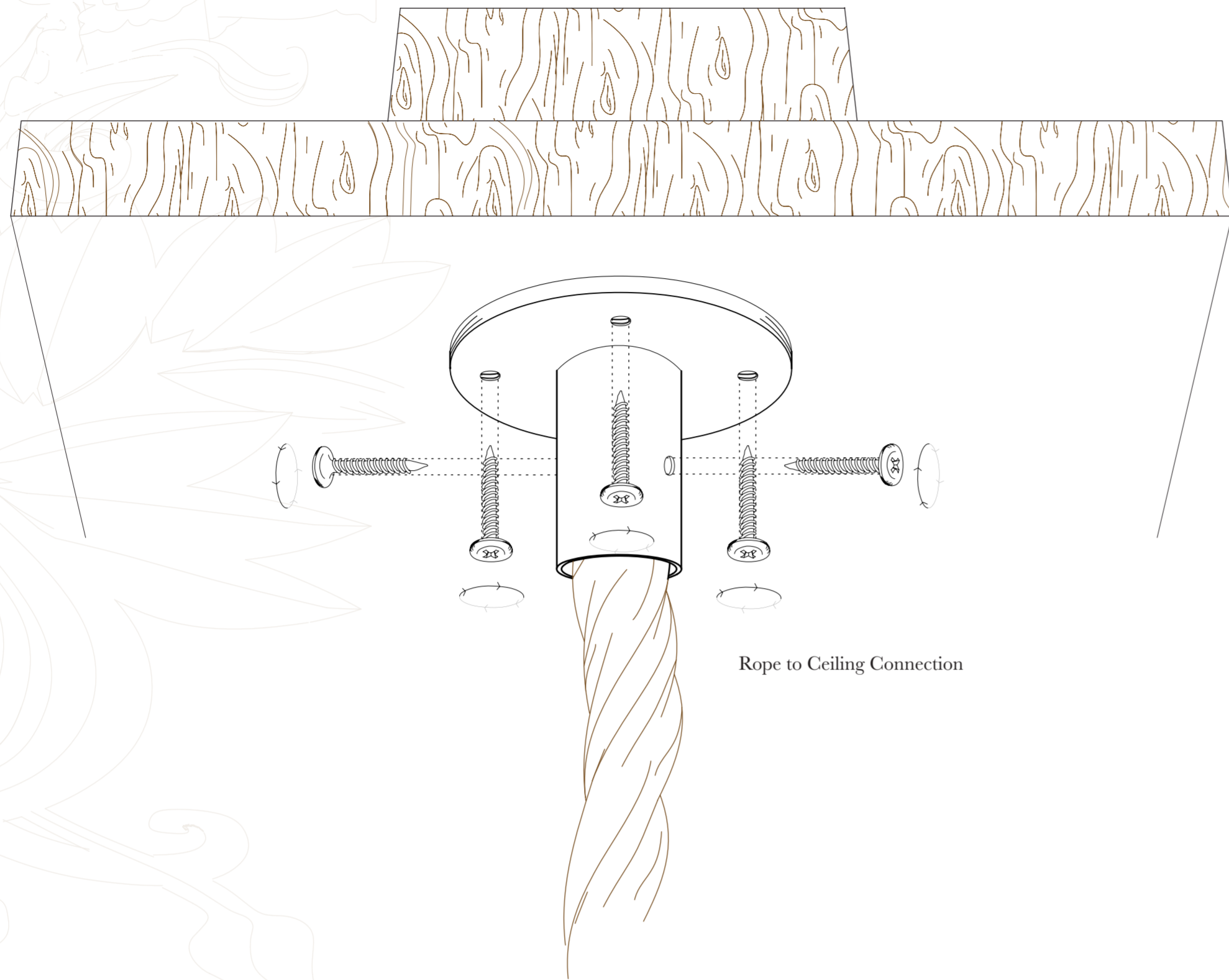

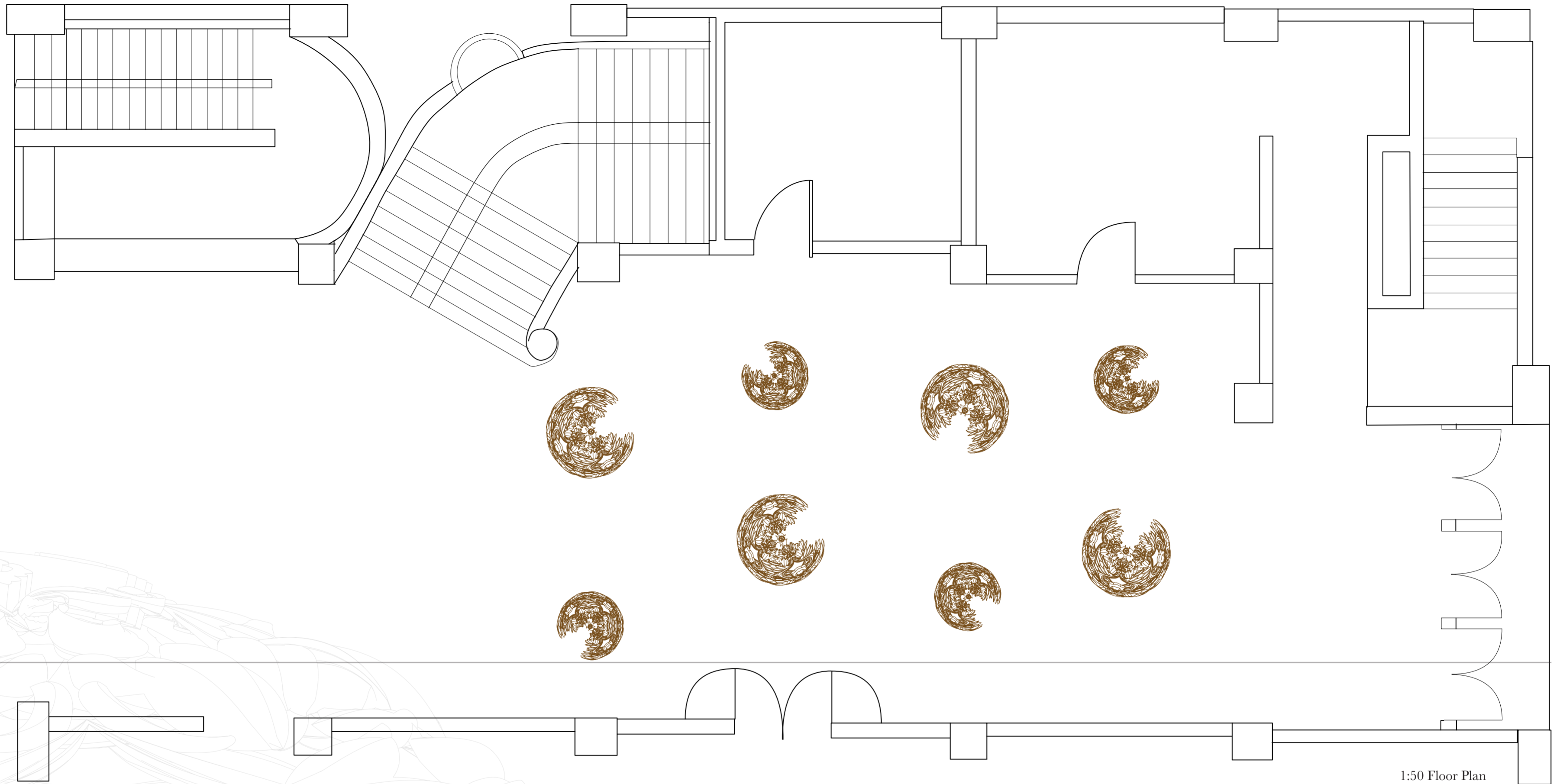

Sectional Cut

1:50 Floor Plan



4.5m

1:50 Longitudinal Section