

FIG. 1

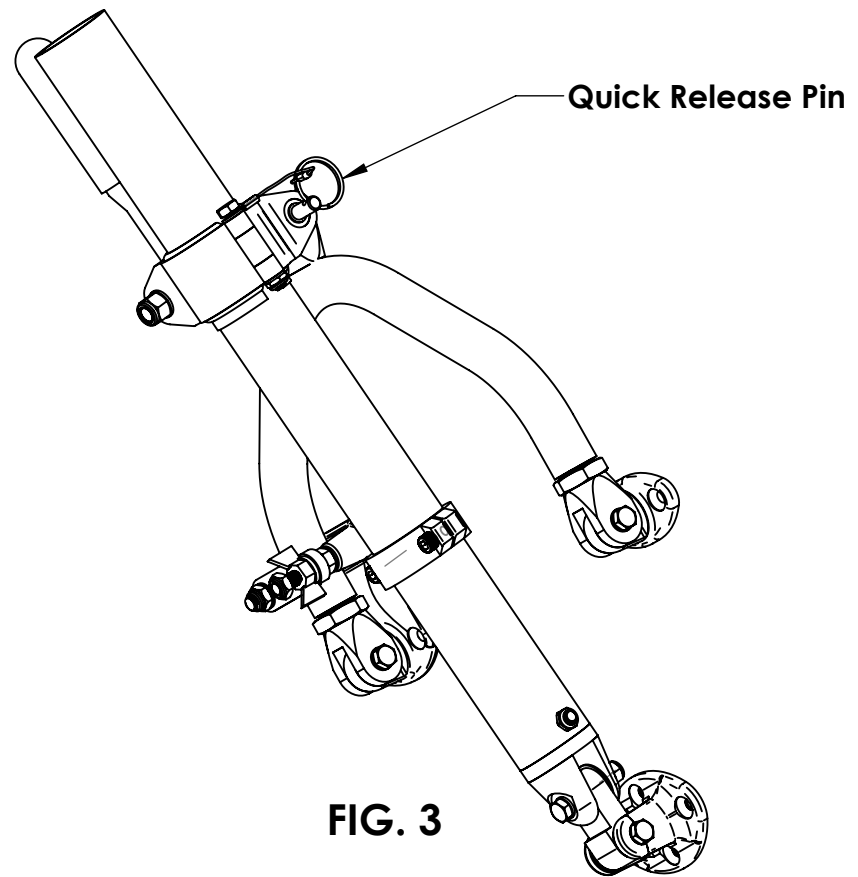

FIG. 3

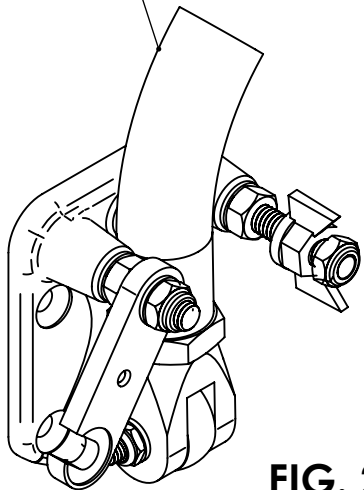

FIG. 2

- 1 Select a mounting location. Area should provide adequate support and allow easy operation
- 2 Position Sidekick at desired angle. With pads parallel as shown in Fig.1. Distance between pads should be kept within the range of 7"-14" measured outside to outside as shown in Fig.1.
- 3 The larger "Latch" pad should be placed on the underside of main tube as shown in Fig. 2. This insures that the latch will hang free of the arm as it operates.
- 4 Install Sidekick using 1/4" screws. Through bolting is a must, and backing plates may be necessary, depending on structure.
- 5 Adjust stop collar as desired for fishing position See Fig.1.
- 6 Outrigger lays back by releasing the latch plate and disconnecting quick release pin See Fig. 3

<p>RUPP MARINE INC. Port Salerno, FL.</p>
<p>A0-SIDE-175 SideKick Instructions</p>