

#	QTY	Part No	Description
1	1	04-1726-50	HALYARD LOCK BODY
2	1	04-1731-40	Pulley Wheel Bushing, S/S
3	1	04-1289-50	PULLEY WHEEL
4	1	07-1223-40	HALYARD LOCK BALL
5	1	04-1730-70B	Rubber Bushing Grey
6	4	04-1738-40	Driv-Lok Pin "C" Typ
7	1	04-1727-50	HALYARD TRIGGER LOCK
8	1	07-1471-40	Spring

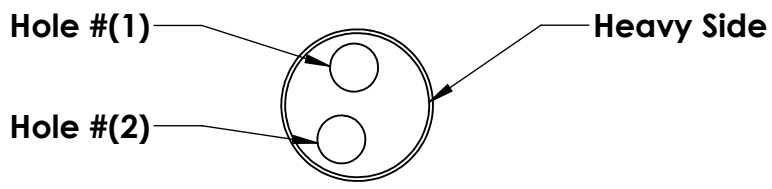

Holes are offset to one side.  
Thin side of Rubber Bushing  
goes toward the Trigger.

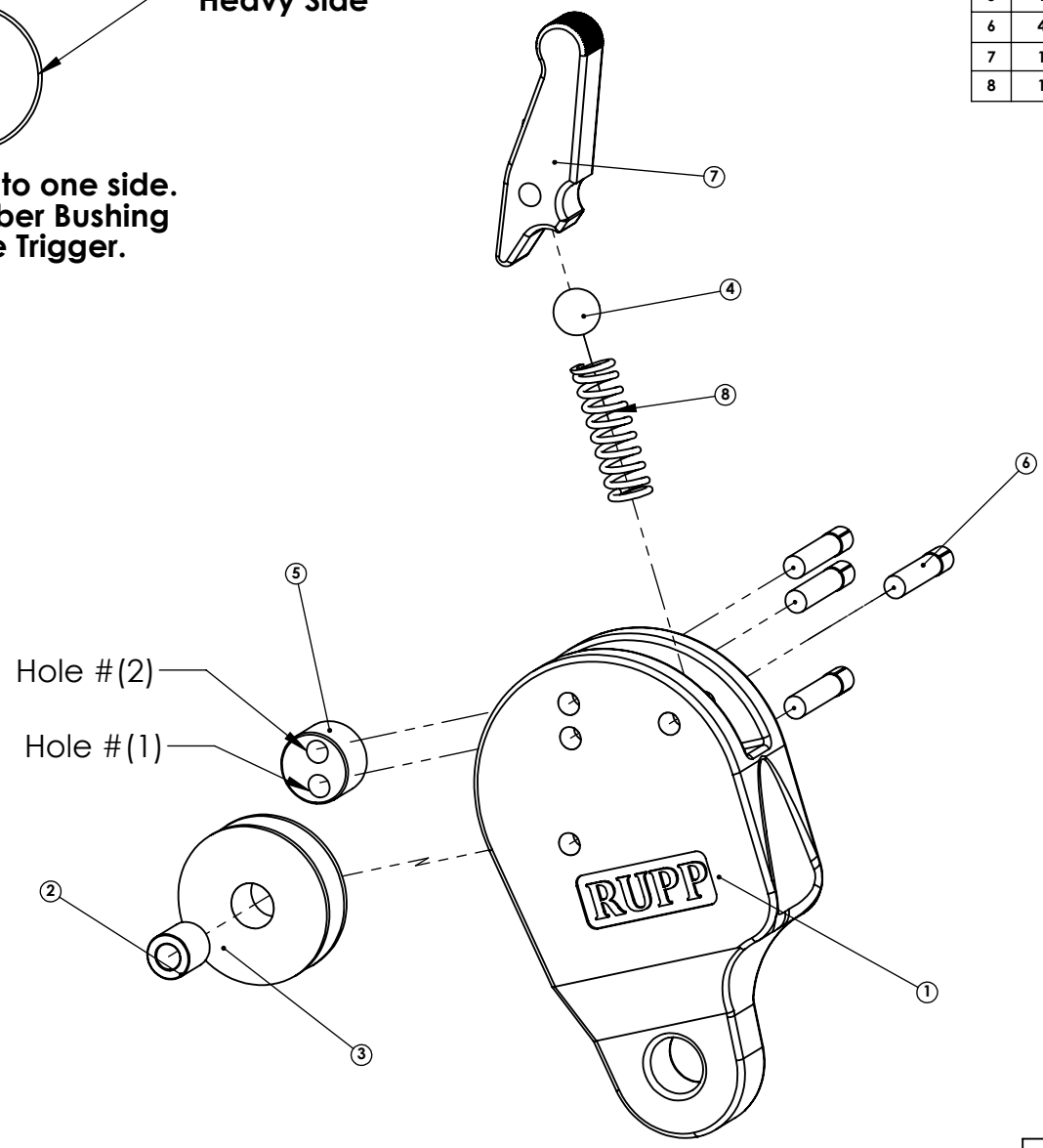

**All Pins when inserted should be flush  
on both sides of the body**

 **Rupp Marine Inc**  
 Serious Sportfishing Hardware  
 (772)286-5300 (866)477-2678

**CA-0157-1**  
**Parts Breakdown**