





XD32/35/38 II

The Ultimate Machine in High Rigidity

- 
Strong Casting Structure allows for high rigidity
- 
Complex machining by various tooling
 Modular cross live drill(5EA), Y2 axis & B axis(option)
- 
Improved C/T and Productivity
 Reduced Idle time by latest NC
 Cross motor output increase(1kw -> 2.2kw)

Optimized Tool Layout



- Secures accuracy and minimized heat displacement
- Easy chip discharge and efficient coolant circulation system

Excellent Motor Power



- Stability of hard cutting by high output motor and built-in motor
- Increase rigidity by direct connecting motor

Innovation Tooling System



- Y2 & B axis allow for complex machining parts
- Easy to use various special tool holders

Enhanced Machine Durability



- Improved slide covers by sealed connection
- Free positioned OP to increase the work efficiency

TOOLING SYSTEM

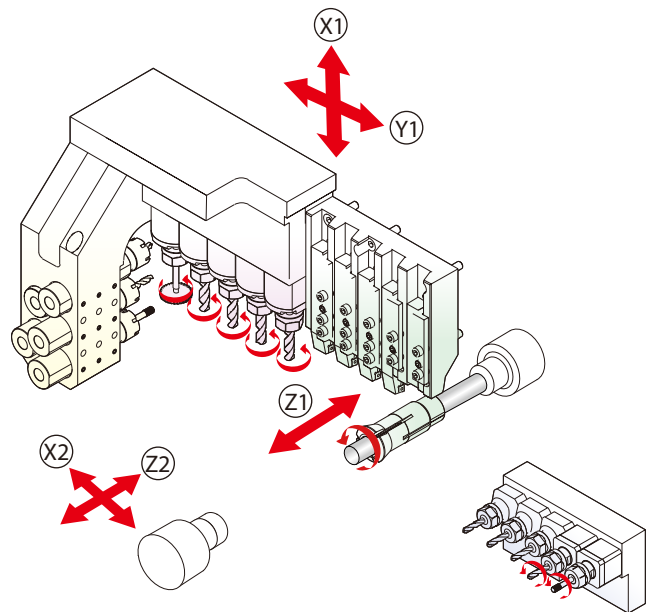

* Option: B axis and Y2 axis

COMPLEX MACHINING

Composite Control

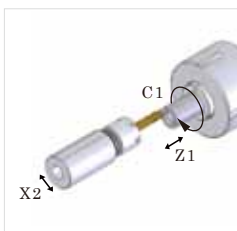

Cs Contouring Control



Synchronous Control

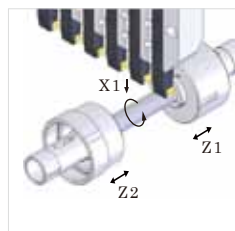

Simultaneous Machining

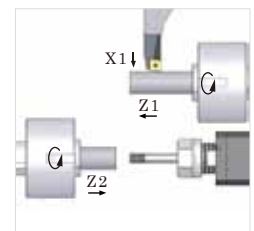

SPECIAL TOOL

BACK TOOL CROSS DRILL	SIDE CUTTER	WHIRLING HEAD	3-AXIS LIVE TOOL (Face/Fixed)	3-AXIS ANGULAR TOOL (Face/±0~90°Adjustable)	3-AXIS LIVE TOOL (Counter Face/Fixed)
					
<ul style="list-style-type: none"> Max. Drilling ϕ : 10mm Max. rpm : 6,000 Angle : Max. Left/Right 15° Application(Back Tool) : Drilling/Milling/Tapping 	<ul style="list-style-type: none"> Max. Cutter ϕ : 50mm Max. rpm : 6,000 Application(Back Tool) : Slotting 	<ul style="list-style-type: none"> Max. Whirling ϕ : 12mm Max. rpm : 6,000 Angle : Max. Left/Right 15° Application(Cross Tool) : Screw 	<ul style="list-style-type: none"> Max. Drilling ϕ : 7mm Max. rpm : 6,000 Application(Cross Tool) : Drilling/Milling/Tapping 	<ul style="list-style-type: none"> Max. Drilling ϕ : 7mm Max. rpm : 6,000 Application(Cross Tool) : Drilling/Milling/Tapping 	<ul style="list-style-type: none"> Max. Drilling ϕ : 7mm Max. rpm : 6,000 Application(Cross Tool) : Drilling/Milling/Tapping

SPECIFICATION

MODEL		XD32/35/38II	
		H Type	N Type
NC		FANUC 32i-B(SIEMENS 840D)	
Max. Turning ϕ (Main)		ϕ 32/ ϕ 35/ ϕ 38	
No. of Tools	OD Tool	5EA	
	Front Tool	5EA	
	Cross Tool	5EA	
	Off Center Drill	-	
MAIN Motor	Main Spindle	rpm	8,000rpm
		Power	5.5/7.5kW
	Cross Drill	rpm	8,000rpm
		Power	2.2kW
Pump	Lubricant	Capacity	1.8L
		Pump Motor	5w
	Coolant	Capacity	230L
		Pump Motor	0.9kW
Weight		3,600kg	
Size(LxWxH)		3,020x1,390x1,745	
Power Consumption(Cable Size)		25kVA(Min 6 SQ)	
Air Flow Rate		120 Liter/Min	
SUB Motor	No. of Tools	Back Tool	5EA(2Driven/3Fixed)/Option 8EA(4Driven/4Fixed)
		Sub Spindle	rpm 7,000rpm Power 2.2/5.5kW
	Back Tool	rpm	6,000rpm
		Power	1.0kW

All specifications are subject to change without notice.

DIMENSION

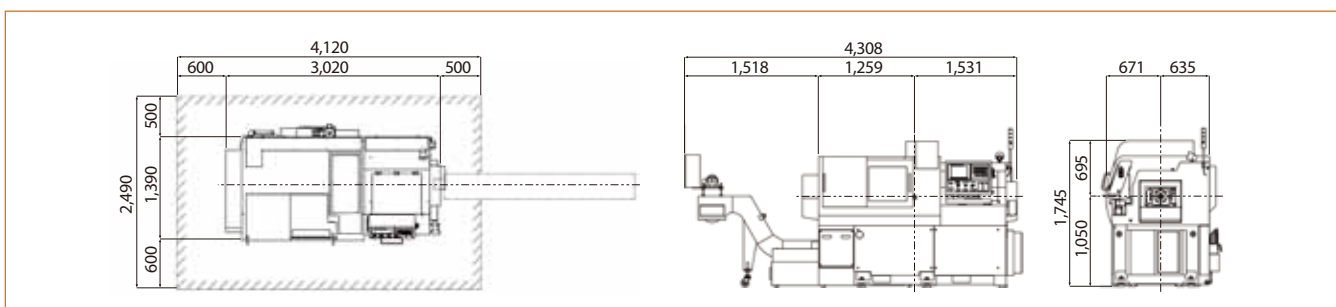

This product is a dual-use items of strategic goods and strictly prohibited from manufacturing illegal weapons. We are not responsible for any effects resulting from the illegal use.

201408

STANDARD

- FULL C AXIS CONTROL ON MAIN SPINDLE
- FULL C AXIS CONTROL ON SUB SPINDLE
- ROTARY GUIDE BUSH HOLDER UNIT(H type)
- CROSS DRILL/MILLING UNIT(5EA, Modular type)
- PART CONVEYOR
- MPG
- DOOR INTERLOCK
- COOLANT FLOW SENSOR
- COOLANT UNIT
- LUBRICATION UNIT
- WORK LIGHT
- SIGNAL LAMP(3COLOR)
- LAN PORT
- TOOL MONITORING FUNCTION
- TOOL BOX
- DRILL HOLDERS
- BAR FEEDER INTERFACE

OPTION

- TRANSFORMER
- CHIP CONVEYOR
- CUT OFF TOOL BREAKAGE DETECTOR(S/W)
- TAP BREAKAGE DETECTOR
- PIPE TYPE EJECTION UNIT
- ADDITIONAL 1 PIPE SET
- MIDDLE/HIGH PRESSURE PUMP
- SPARE M CODE KIT
- OIL MIST COLLECTOR
- OIL CHILLER
- NC WARRANTY FOR 2 YEARS
- BACK/CROSS INTERNAL COOLANT DRIVEN TOOL
- Y2 AXIS(8EA, 4DRIVEN/4FIXED)
- B AXIS(3EA, CROSS DRILL 4EA)
- GEAR HOBBING FUNCTION
- BAR FEEDER/2ND ANTI VIBRATION UNIT