



# 8" Lumber / Warehouse Cart Swivel Caster

SKU: 03041039

## Top Plate Printable Template

1. Carefully cut out the bolt holes with scissors or a knife.
2. Cut out around the outside of the plate.
3. Place template over your equipment's caster mounting holes.
4. Ensure caster bolt holes on your equipment align with this template

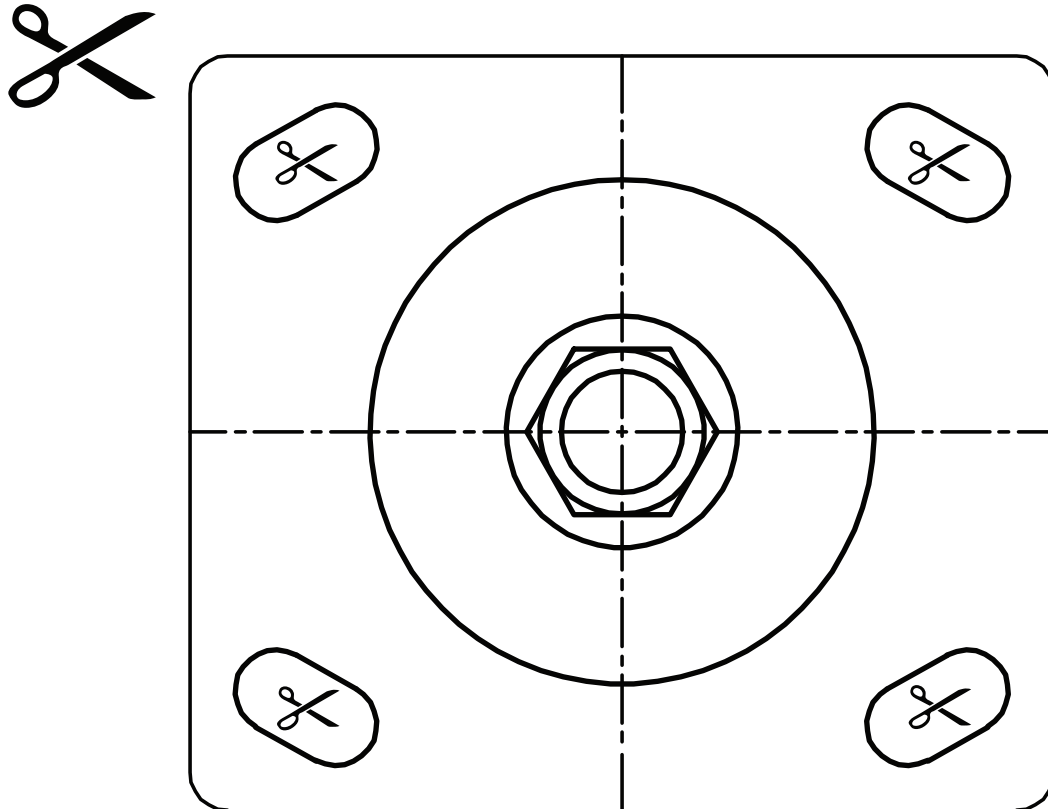

1. Ensure your printer is set to print 100% scale AND NOT "FIT TO PAGE"
2. To verify, the printed width of the template should be 115mm or 4-1/2" wide.