

Soils Map

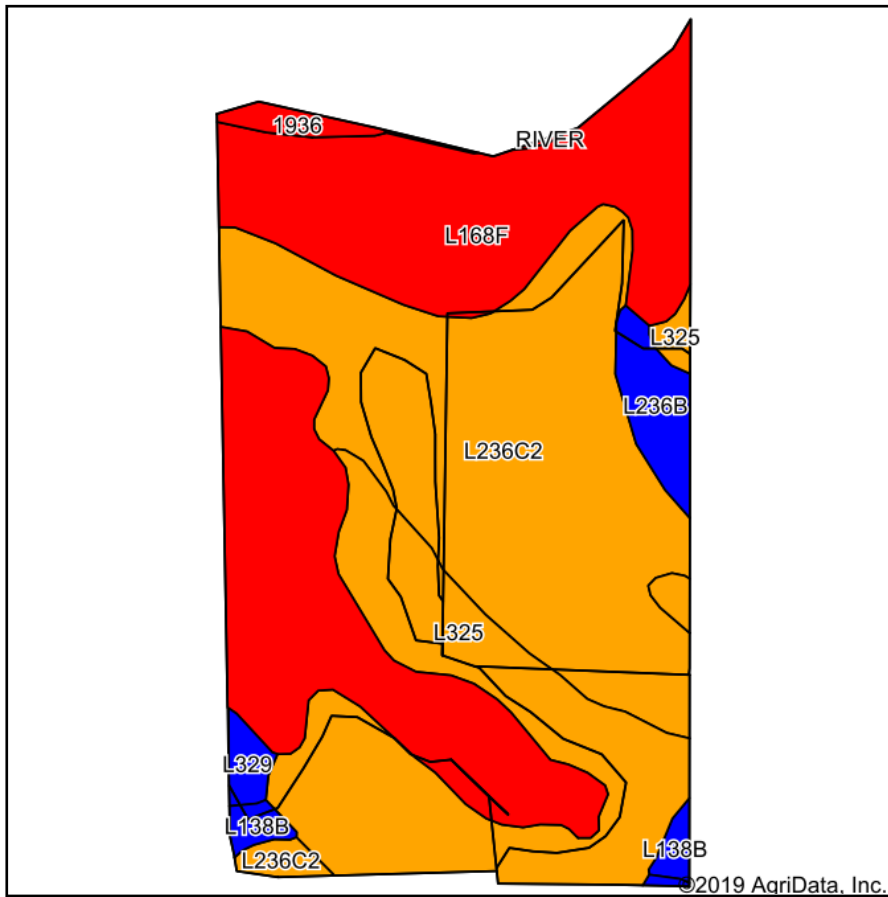

Soils data provided by USDA and NRCS.

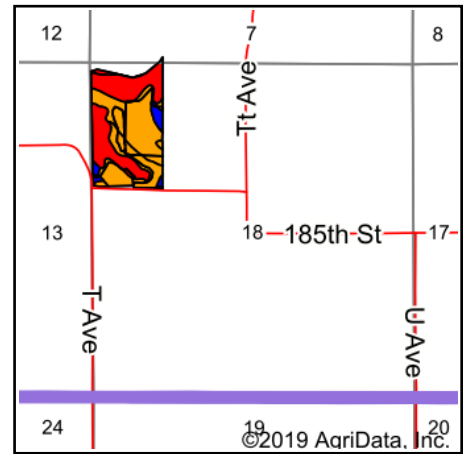

State: **Iowa**
 County: **Hardin**
 Location: **18-88N-19W**
 Township: **Clay**
 Acres: **45.44**
 Date: **4/29/2020**



Maps Provided By:

 © AgriData, Inc. 2019 www.AgriDataInc.com



Area Symbol: IA083. Soil Area Version: 26

Code	Soil Description	Acres	Percent of field	CSR2 Legend	Non-Irr Class *c	CSR2**	CS R	Oats	Spring wheat	*n NCCPI Soybeans
L168F	Hayden loam, Bemis moraine, 22 to 40 percent slopes	17.72	39.0%		Vlle	5				9
L236C2	Lester loam, Bemis moraine, 6 to 10 percent slopes, moderately eroded	15.53	34.2%		Ille	77		2	1	61
L325	Le Sueur loam, Bemis moraine, 1 to 3 percent slopes	9.64	21.2%		Ile	78				85
L236B	Lester loam, Bemis moraine, 2 to 6 percent slopes	1.18	2.6%		Ile	85				77
L138B	Clarion loam, Bemis moraine, 2 to 6 percent slopes	0.54	1.2%		Ile	88				79
1936	Coland-Spillville-Hanlon complex, channeled, 0 to 2 percent slopes	0.42	0.9%		Vw	24	25			36
L329	Webster-Nicollet complex, Bemis moraine, 0 to 3 percent slopes	0.41	0.9%		Ilw	89				81
Weighted Average						49.1	*-	0.7	0.3	*n 46.4

**IA has updated the CSR values for each county to CSR2.

*- CSR weighted average cannot be calculated on the current soils data, use prior data version for csr values.

*n: The aggregation method is "Weighted Average using major components"

*c: Using Capabilities Class Dominant Condition Aggregation Method

Soils data provided by USDA and NRCS.