

# Soils Map

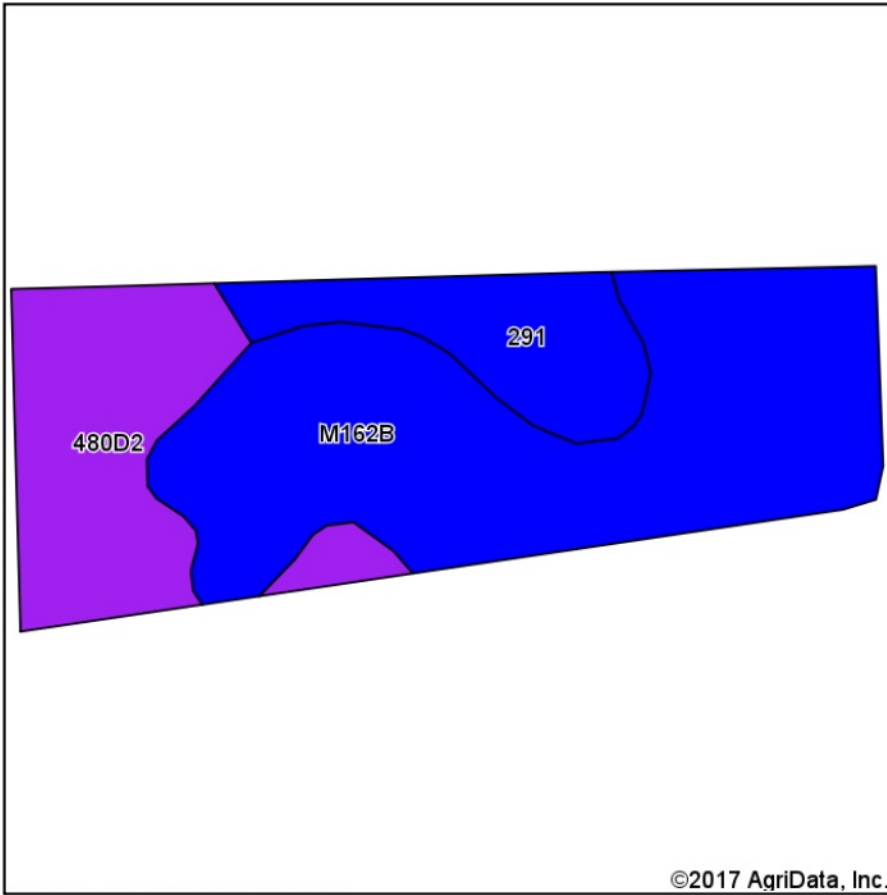

Soils data provided by USDA and NRCS.

©2017 AgriData, Inc.

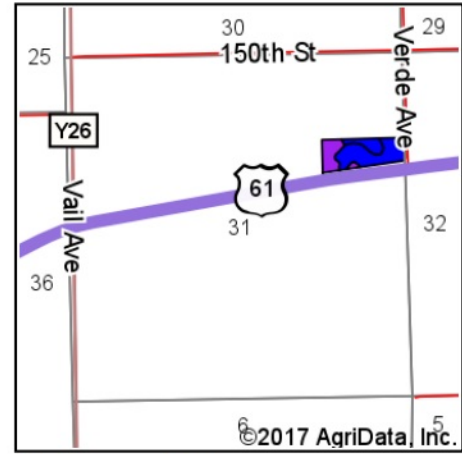

State: Iowa  
 County: Muscatine  
 Location: 31-78N-1E  
 Township: Fulton  
 Acres: 12.9  
 Date: 2/14/2017



Area Symbol: IA139, Soil Area Version: 21

| Code                    | Soil Description  | Acres | Percent of field | CSR2 Legend | Non-Irr Class *c | CSR2**      | CSR       |
|-------------------------|---|-------|------------------|-------------|------------------|-------------|-----------|
| M162B                   | Downs silt loam, till plain, 2 to 5 percent slopes          | 7.59  | 58.8%            |             | Ile              | 90          |           |
| 480D2                   | Orwood silt loam, 9 to 14 percent slopes, moderately eroded | 3.36  | 26.0%            |             | IIIe             | 52          | 53        |
| 291                     | Atterberry silt loam, 0 to 2 percent slopes                 | 1.95  | 15.1%            |             | Ie               | 90          | 95        |
| <b>Weighted Average</b> |   |       |                  |             |                  | <b>80.1</b> | <b>*-</b> |

Area Symbol: IA139, Soil Area Version: 21

\*\*IA has updated the CSR values for each county to CSR2.

\*- CSR weighted average cannot be calculated on the current soils data, use prior data version for csr values.

\*c: Using Capabilities Class Dominant Condition Aggregation Method

Soils data provided by USDA and NRCS.