

# Soils Map

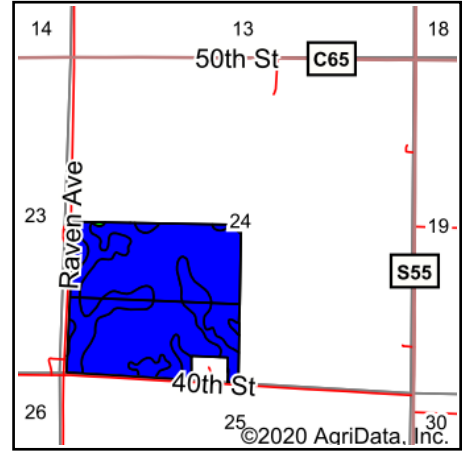

State: **Iowa**  
 County: **Franklin**  
 Location: **24-90N-20W**  
 Township: **Grant**  
 Acres: **144.59**  
 Date: **8/13/2020**

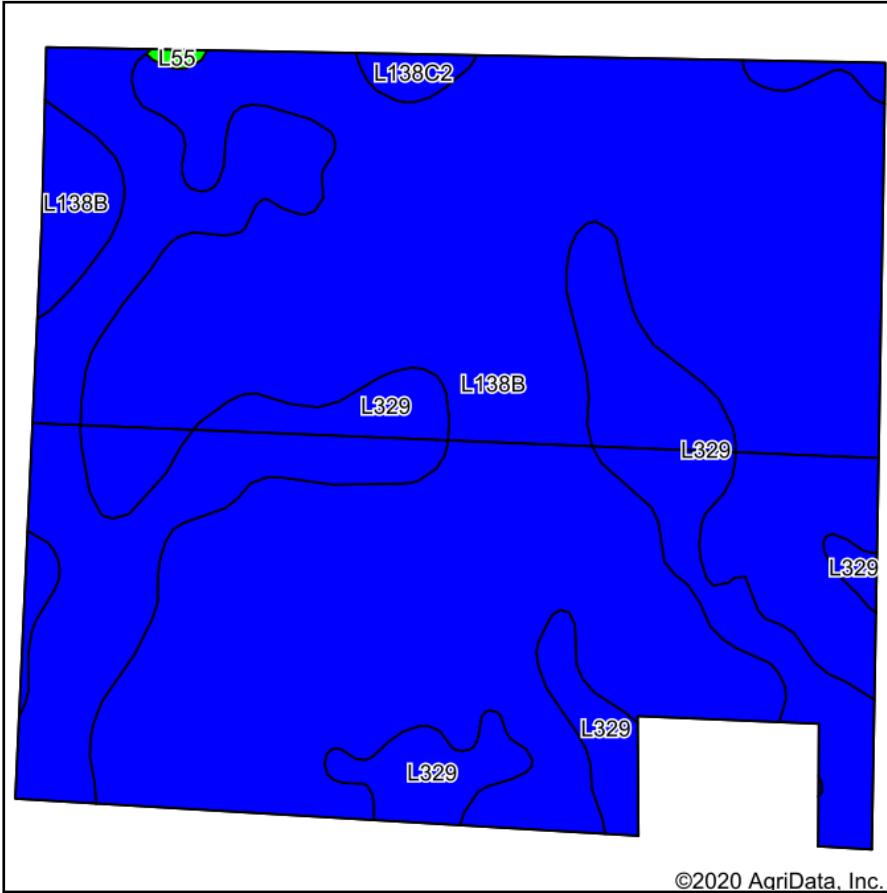

Soils data provided by USDA and NRCS.

Area Symbol: IA069. Soil Area Version: 27							
Code	Soil Description	Acres	Percent of field	CSR2 Legend	Non-Irr Class *c	CSR2**	*n NCCPI Soybeans
L138B	Clarion loam, Bemis moraine, 2 to 6 percent slopes	104.59	72.3%		Ile	88	80
L329	Webster-Nicollet complex, Bemis moraine, 0 to 3 percent slopes	38.15	26.4%		IIw	89	84
L138C2	Clarion loam, Bemis moraine, 6 to 10 percent slopes, moderately eroded	1.66	1.1%		IIIe	83	67
L55	Nicollet loam, 1 to 3 percent slopes	0.19	0.1%		Ie	91	85
<b>Weighted Average</b>						<b>88.2</b>	<b>*n 80.9</b>

\*\*IA has updated the CSR values for each county to CSR2.  
 \*n: The aggregation method is "Weighted Average using all components"  
 \*c: Using Capabilities Class Dominant Condition Aggregation Method  
 Soils data provided by USDA and NRCS.