

# Soils Map

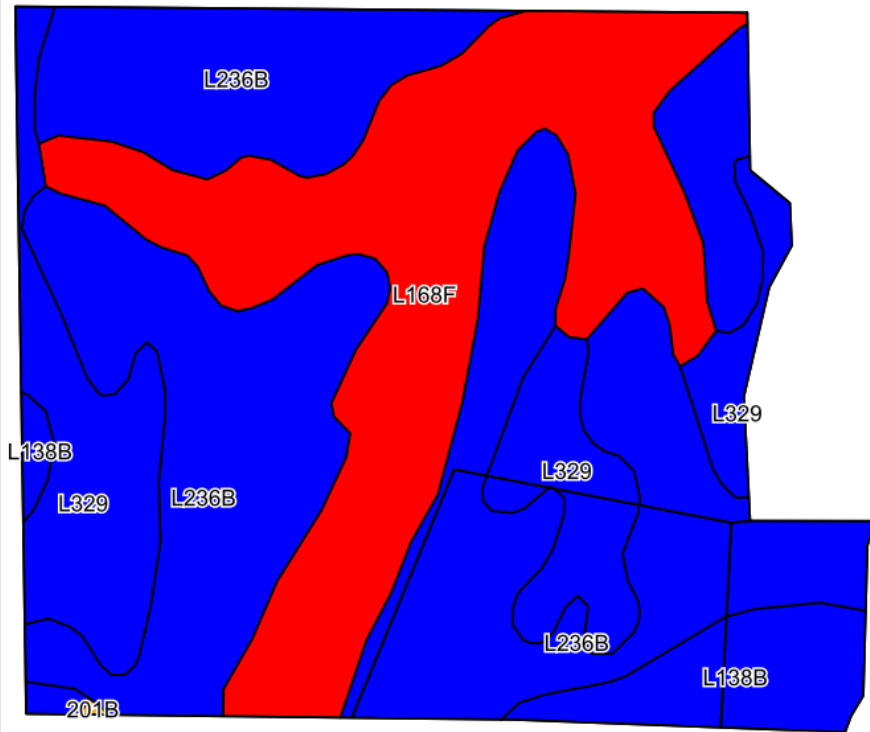

©2019 AgriData, Inc.

Soils data provided by USDA and NRCS.

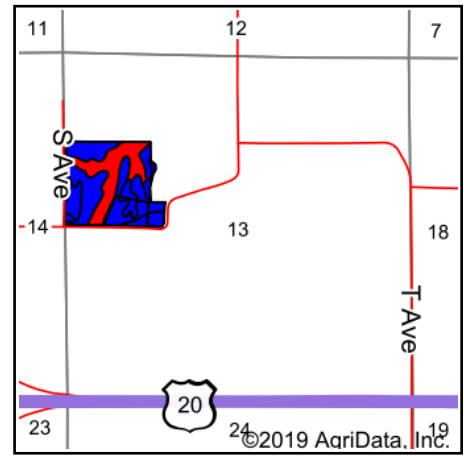

State: **Iowa**  
 County: **Hardin**  
 Location: **13-88N-20W**  
 Township: **Jackson**  
 Acres: **40.44**  
 Date: **3/25/2020**



Maps Provided By:



Area Symbol: IA083. Soil Area Version: 26

Code	Soil Description	Acres	Percent of field	CSR2 Legend	Non-Irr Class *c	CSR2**	CS R	*n NCCPI Soybeans
L236B	Lester loam, Bemis moraine, 2 to 6 percent slopes	20.36	50.3%		Ile	85		77
L168F	Hayden loam, Bemis moraine, 22 to 40 percent slopes	11.54	28.5%		Vlle	5		9
L329	Webster-Nicollet complex, Bemis moraine, 0 to 3 percent slopes	6.25	15.5%		Ilw	89		81
L138B	Clarion loam, Bemis moraine, 2 to 6 percent slopes	2.29	5.7%		Ile	88		79
<b>Weighted Average</b>						<b>63</b>	<b>*-</b>	<b>*n 58.3</b>

\*\*IA has updated the CSR values for each county to CSR2.

\*- CSR weighted average cannot be calculated on the current soils data, use prior data version for csr values.

\*n: The aggregation method is "Weighted Average using major components"

\*c: Using Capabilities Class Dominant Condition Aggregation Method

Soils data provided by USDA and NRCS.