



2320-2340 S. Air Depot

Midwest City, Oklahoma 73130

PROPERTY HIGHLIGHTS

- Proposed 4,506 SF Free Standing Building
- 10,139 SF Occupied
- 72 Parking Spaces
- 2018 New Construction

SUITES AVAILABLE

- Building B: 4,506 SF



TOTAL SF	14,645 SF MOL
LAND IN ACRES	1.27 MOL
ZONING	C-3
GENERAL USE	Retail
VACANT SF	4,500 MOL

www.naisullivangroup.com

NO WARRANTY OR REPRESENTATION, EXPRESS OR IMPLIED, IS MADE AS TO THE ACCURACY OF THE INFORMATION CONTAINED HEREIN, AND THE SAME IS SUBMITTED SUBJECT TO ERRORS, OMISSIONS, CHANGE OF PRICE, RENTAL OR OTHER CONDITIONS, PRIOR SALE, LEASE OR FINANCING, OR WITHDRAWAL WITHOUT NOTICE, AND OF ANY SPECIAL LISTING CONDITIONS IMPOSED BY OUR PRINCIPALS NO WARRANTIES OR REPRESENTATIONS ARE MADE AS TO THE CONDITION OF THE PROPERTY OR ANY HAZARDS CONTAINED THEREIN ARE ANY TO BE IMPLIED.

David Hartnack / Sam Swanson / Nathan Wilson

David's Cell: 1 405 761 8955
 Sam's Cell: 1 405 208 2046
 Nathan's Cell: 1 405 760 5327
davidh@naisullivangroup.com
sam@naisullivangroup.com
nathan@naisullivangroup.com

4045 N.W. 64th Street, Suite 340
 Oklahoma City, Oklahoma 73116
 Office: 1 405 840 0600
 Fax: 1 405 840 0610

2320-2340 S. Air Depot
Midwest City, OK 73130



LOCATION HIGHLIGHTS

- North of Tinker Air Force Base
- East of Rose State College
- Easy Access to I-40

DEMOGRAPHICS

Population		
1 Mile: 7,445	3 Mile: 73,089	5 Mile: 126,247
Average Household Income		
1 Mile: \$39,972	3 Mile: \$45,817	5 Mile: \$46,051
Total Households		
1 Mile: 3,318	3 Mile: 29,443	5 Mile: 49,851

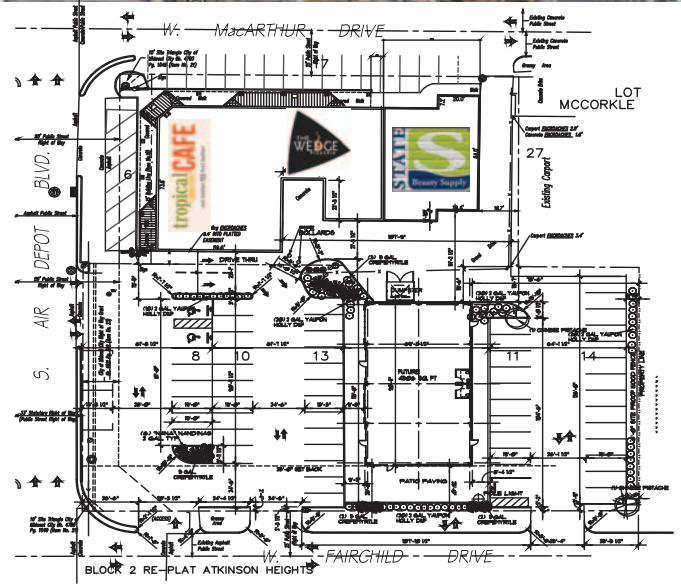

David Hartnack / Sam Swanson / Nathan Wilson

David's Cell: 1 405 761 8955
Sam's Cell: 1 405 208 2046
Nathan's Cell: 1 405 760 5327
davidh@naisullivangroup.com
sam@naisullivangroup.com
nathan@naisullivangroup.com

4045 N.W. 64th Street, Suite 340
Oklahoma City, Oklahoma 73116
Office: 1 405 840 0600
Fax: 1 405 840 0610

www.naisullivangroup.com

NASullivan Group