



1000 E. Eagle Road

Weatherford, Oklahoma 73096

PROPERTY HIGHLIGHTS

- 21 Acres Zoned Commercial
- Good Visibility from I-40 & Service Road
- Close to Washington Street Bridge
- Across the Street from Tractor Supply
- All City Utilities
- Great for Hotel or Retail Combo

LAND IN ACRES	21 MOL
ZONING	C-3 Highway Commercial
2016 TAXES	\$69

www.naisullivangroup.com

Irmon Gray

Irmon's Cell: 1 405 474 7286
irmon@naisullivangroup.com

4045 N.W. 64th Street, Suite 340
Oklahoma City, Oklahoma 73116
Office: 1 405 840 0600
Fax: 1 405 840 0610

NO WARRANTY OR REPRESENTATION, EXPRESS OR IMPLIED, IS MADE AS TO THE ACCURACY OF THE INFORMATION CONTAINED HEREIN, AND THE SAME IS SUBMITTED SUBJECT TO ERRORS, OMISSIONS, CHANGE OF PRICE, RENTAL OR OTHER CONDITIONS, PRIOR SALE, LEASE OR FINANCING, OR WITHDRAWAL WITHOUT NOTICE, AND OF ANY SPECIAL LISTING CONDITIONS IMPOSED BY OUR PRINCIPALS NO WARRANTIES OR REPRESENTATIONS ARE MADE AS TO THE CONDITION OF THE PROPERTY OR ANY HAZARDS CONTAINED THEREIN ARE ANY TO BE IMPLIED.

1000 E. Eagle Road
Weatherford, OK 73096



LOCATION HIGHLIGHTS

- 880' on Frontage Facing I-40
- Newly Developing Commercial Area

DEMOGRAPHICS

Population		
1 Mile: 524	3 Mile: 13,659	5 Mile: 14,238
Average Household Income		
1 Mile: \$76,724	3 Mile: \$47,375	5 Mile: \$47,841
Total Households		
1 Mile: 212	3 Mile: 5,525	5 Mile: 5,745

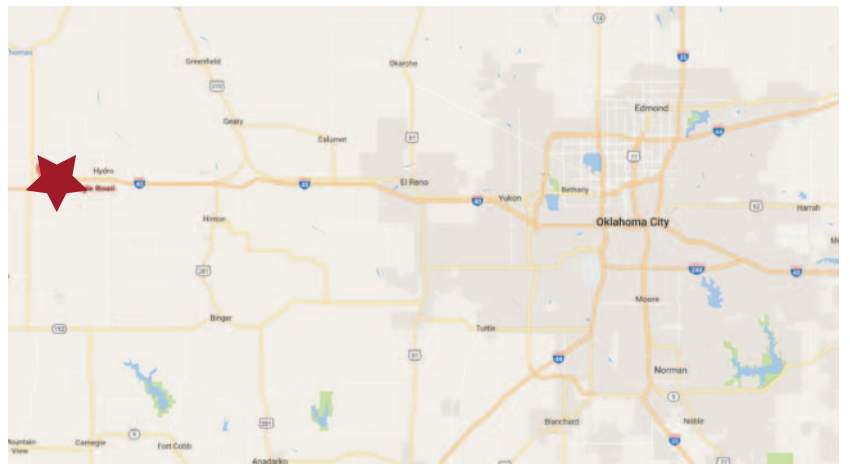

www.naisullivangroup.com

Irmon Gray

Irmon's Cell: 1 405 474 7286
irmon@naisullivangroup.com

NASullivan Group

4045 N.W. 64th Street, Suite 340
Oklahoma City, Oklahoma 73116
Office: 1 405 840 0600
Fax: 1 405 840 0610