

# Rolt Street, Deptford

Community Street Design Proposal

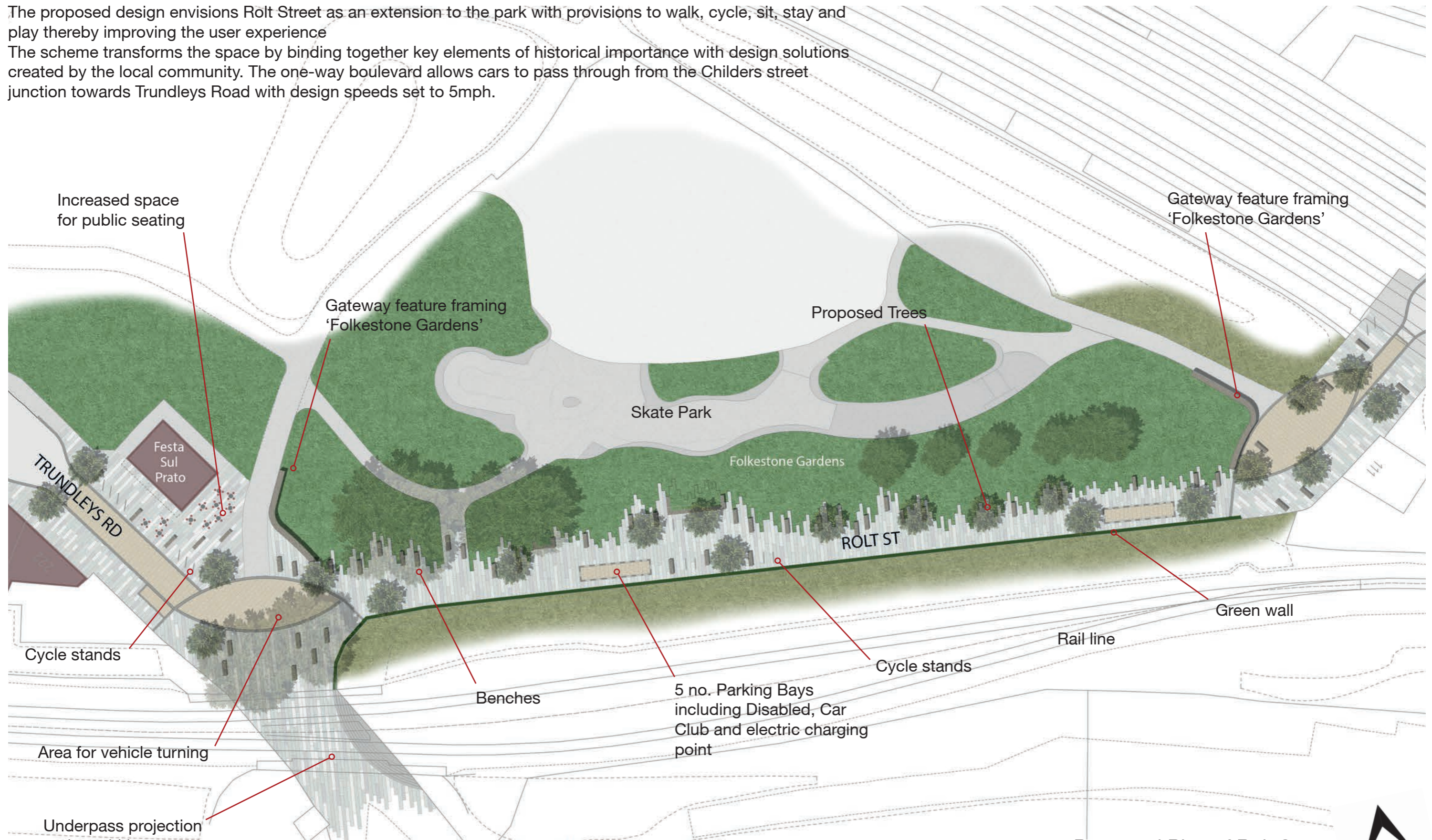

The proposed design envisions Rolt Street as an extension to the park with provisions to walk, cycle, sit, stay and play thereby improving the user experience. The scheme transforms the space by binding together key elements of historical importance with design solutions created by the local community. The one-way boulevard allows cars to pass through from the Childers street junction towards Trundleys Road with design speeds set to 5mph.



Proposed Plan of Rolt Street  
Scale 1:500 @ A3



# Rolt Street, Deptford

Community Street Design Proposal



Visualisation of Rolt St from Festa Sur Prato looking east